

FED. ROAD DIST. NO.	STATE	PROJ. NO.	FISCAL YEAR	SHEET NO.	TOTAL SHEETS
HAWAII	HAW.	11C-01-91M	1991	4	23

TRUE NORTH
SCALE: 1" = 40'

⊕ CURVE DATA ③

Δ = 34°57'00"
R = 286.89'
T = 90.32'
C = 172.30'
L = 175.00'

⊕ CURVE DATA ①

Δ = 30°42'00"
R = 286.48'
T = 78.64'
C = 151.67'
L = 153.50'

⊕ CURVE DATA ②

Δ = 62°24'00"
R = 117.84'
T = 71.36'
C = 122.09'
L = 128.33'

⊕ CURVE DATA ④

Δ = 29°59'00"
R = 286.64'
T = 76.76'
C = 148.29'
L = 150.00'

⊕ CURVE DATA ⑥

Δ = 34°59'00"
R = 286.62'
T = 90.32'
C = 172.29'
L = 175.00'

⊕ CURVE DATA ⑤

Δ = 52°30'00"
R = 193.17'
T = 95.26'
C = 170.87'
L = 177.00'

BEGIN PROJ. NO. 11C-01-91M
⊕ STA. 740+00.00

M.L. ⊕ STA. 750+00

To Pahala →

← To Kailua

TRUE NORTH
SCALE: 1" = 40'

M.L. ⊕ STA. 750+00

M.L. ⊕ STA. 762+50

→ To Pahala

← To Kailua

WAIKAKU BOUNDARY
KAOHE 5 BOUNDARY

STATE OF HAWAII
DEPARTMENT OF TRANSPORTATION
HIGHWAYS DIVISION

ROADWAY PLAN

HAWAII BELT ROAD RESURFACING
Kaohe to Kaapuna
Project No. 11C-01-91M

Scale: 1" = 40' Date: Sept., 1990

SHEET No. 1 OF 9 SHEETS

AS-BUILT

ORIGINAL PLAN	DATE
DRAWN BY	
DESIGNED BY	
QUANTITIES BY	
CHECKED BY	

FED. ROAD DIST. NO.	STATE	PROJ. NO.	FISCAL YEAR	SHEET NO.	TOTAL SHEETS
HAWAII	HAW.	11C-01-91M	1991	5	23

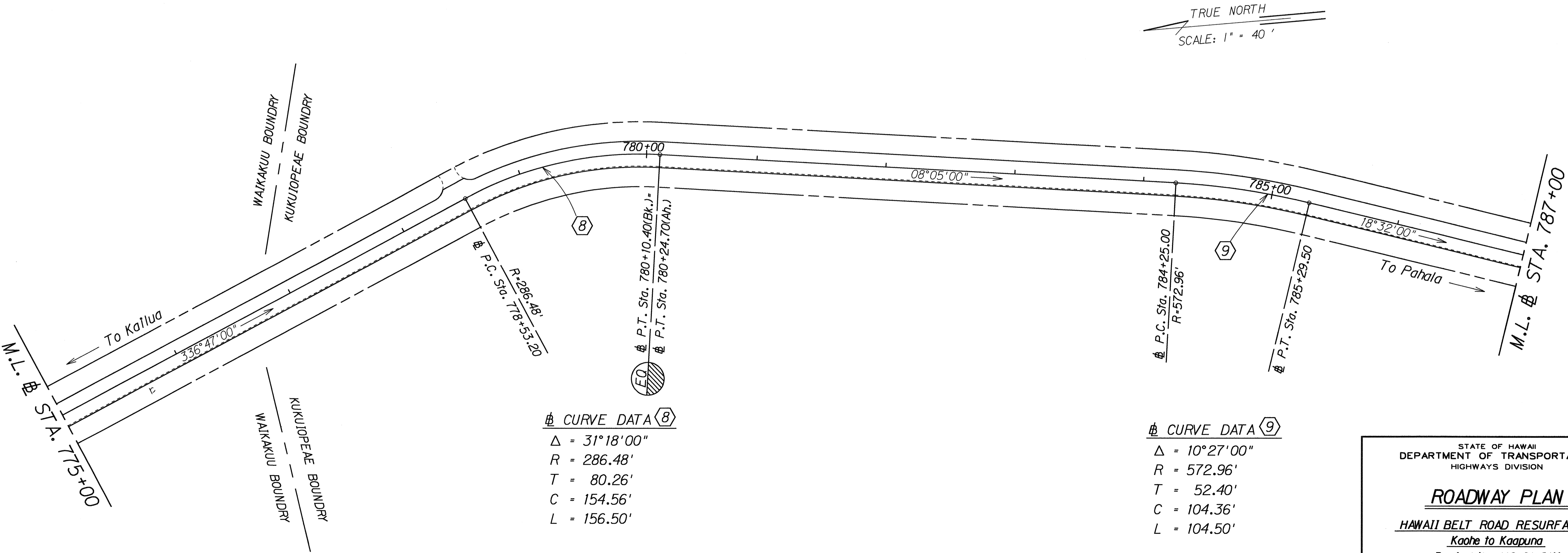
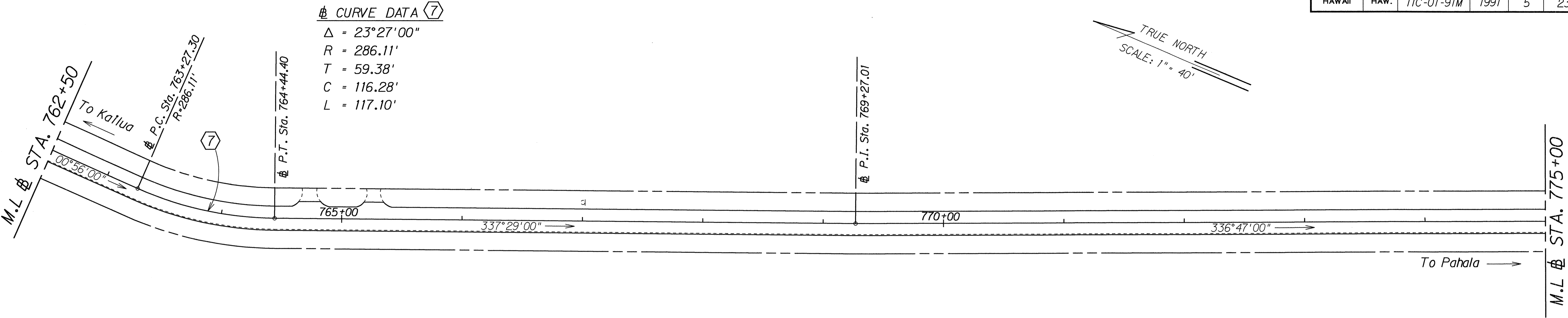

$\Delta = 10^{\circ}27'00''$
 $R = 572.96'$
 $T = 52.40'$
 $C = 104.36'$
 $L = 104.50'$

STATE OF HAWAII
DEPARTMENT OF TRANSPORTATION
HIGHWAYS DIVISION

ROADWAY PLAN
HAWAII BELT ROAD RESURFACING
Kahe to Kaapuna
Project No. 11C-01-91M

Scale: 1" = 40'
Date: Sept., 1990
SHEET No. 2 OF 9 SHEETS

SURVEY PLOTTED BY	DATE
DRAWN BY	
DESIGNED BY	
QUANTITIES BY	
CHECKED BY	
ORIGINAL PLAN	
NOTE BOOK	
N ^o .	

AS-BUILT

FED. ROAD DIST. NO.	STATE	PROJ. NO.	FISCAL YEAR	SHEET NO.	TOTAL SHEETS
HAWAII	HAW.	11C-01-91M	1991	6	23

CURVE DATA 10

$\Delta = 42^{\circ}34'00''$
 $R = 476.90'$
 $T = 185.77'$
 $C = 346.21'$
 $L = 354.30'$

CURVE DATA 12

$\Delta = 26^{\circ}10'00''$
 $R = 286.84'$
 $T = 66.66'$
 $C = 129.86'$
 $L = 131.00'$

CURVE DATA 11

$\Delta = 33^{\circ}42'00''$
 $R = 286.82'$
 $T = 86.87'$
 $C = 166.28'$
 $L = 168.70'$

CURVE DATA 13

$\Delta = 54^{\circ}18'00''$
 $R = 191.20'$
 $T = 98.05'$
 $C = 174.49'$
 $L = 181.20'$

CURVE DATA 14

$\Delta = 50^{\circ}06'00''$
 $R = 286.36'$
 $T = 133.84'$
 $C = 242.50'$
 $L = 250.40'$

CURVE DATA 16

$\Delta = 26^{\circ}44'00''$
 $R = 287.19'$
 $T = 68.24'$
 $C = 132.79'$
 $L = 134.00'$

CURVE DATA 15

$\Delta = 16^{\circ}49'00''$
 $R = 287.22'$
 $T = 42.46'$
 $C = 84.00'$
 $L = 84.30'$

STATE OF HAWAII
DEPARTMENT OF TRANSPORTATION
HIGHWAYS DIVISION

ROADWAY PLAN

HAWAII BELT ROAD RESURFACING
Kahe to Kaapuna
Project No. 11C-01-91M

Scale: 1" = 40'
Date: Sept., 1990

SHEET No. 3 OF 9 SHEETS

AS-BUILT

FED. ROAD DIST. NO.	STATE	PROJ. NO.	FISCAL YEAR	SHEET NO.	TOTAL SHEETS
HAWAII	HAW.	11C-01-91M	1991	7	23

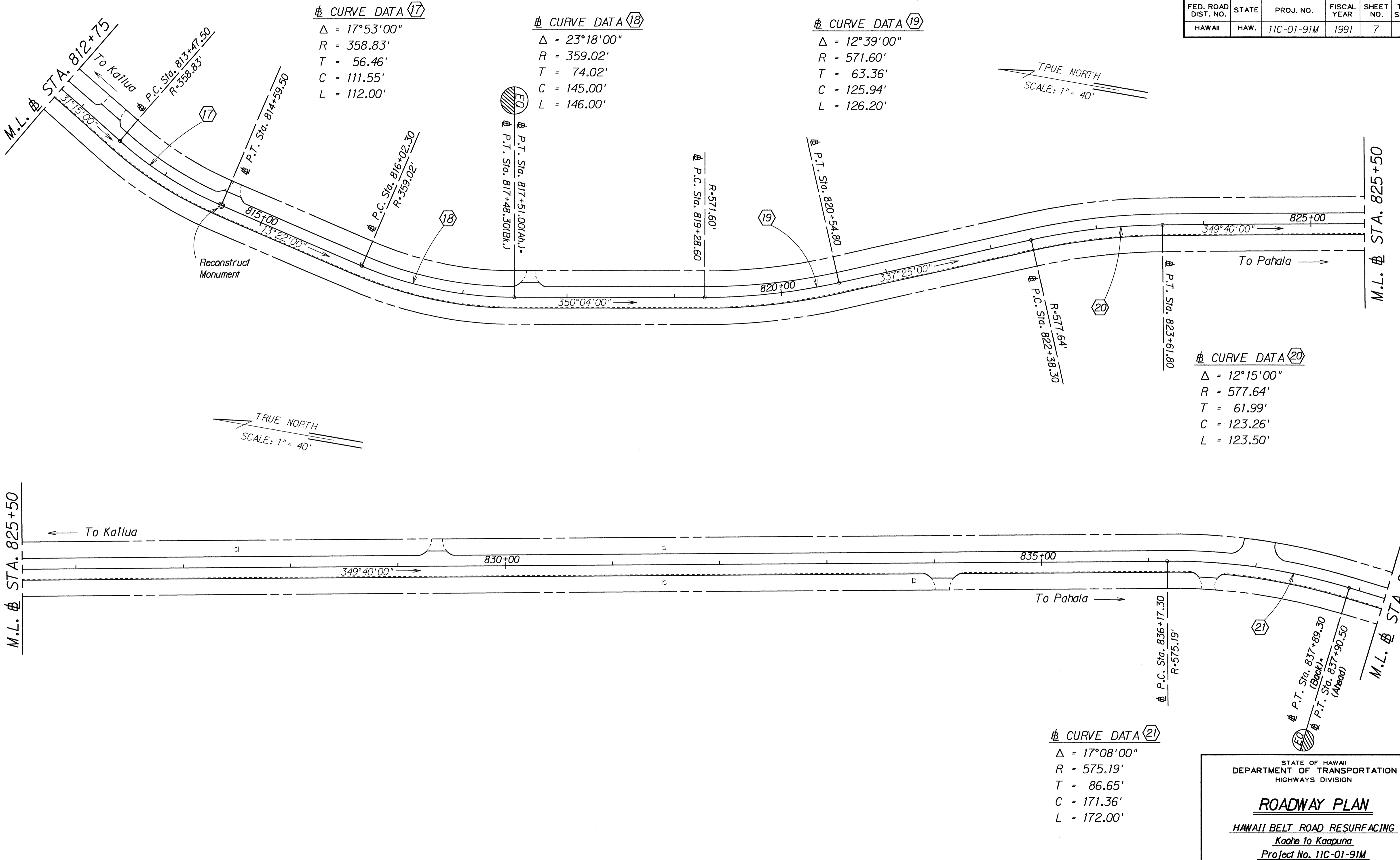

AS-BUILT

FED. ROAD DIST. NO.	STATE	PROJ. NO.	FISCAL YEAR	SHEET NO.	TOTAL SHEETS
HAWAII	HAW.	11C-01-91M	1991	8	23

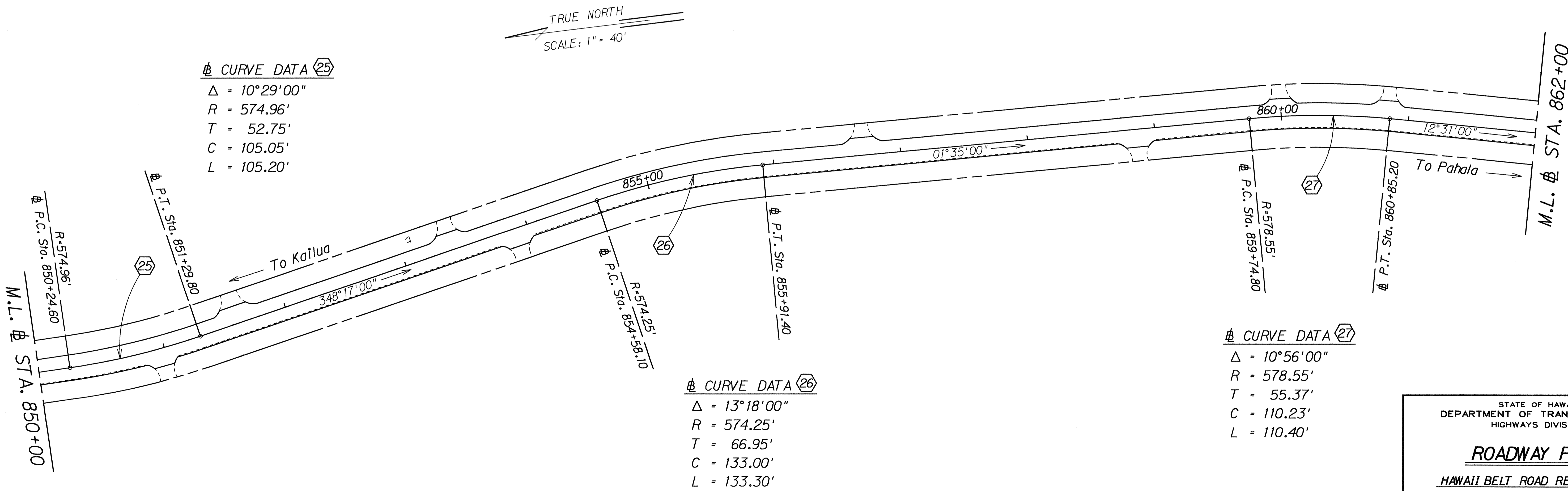
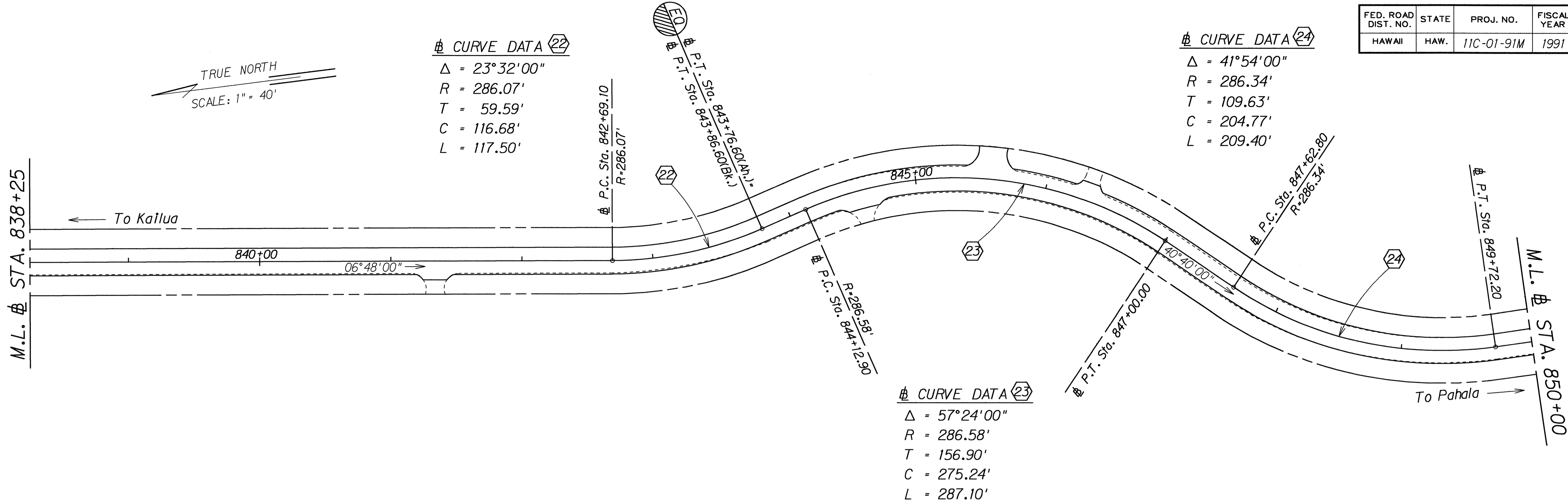

STATE OF HAWAII
DEPARTMENT OF TRANSPORTATION
HIGHWAYS DIVISION

ROADWAY PLAN

HAWAII BELT ROAD RESURFACING

Kaohi to Kaapuna

Project No. 11C-01-91M

Scale: 1" = 40' Date: Sept., 1990

SHEET No. 5 OF 9 SHEETS

AS-BUILT

FED. ROAD DIST. NO.	STATE	PROJ. NO.	FISCAL YEAR	SHEET NO.	TOTAL SHEETS
HAWAII	HAW.	11C-01-91M	1991	9	23

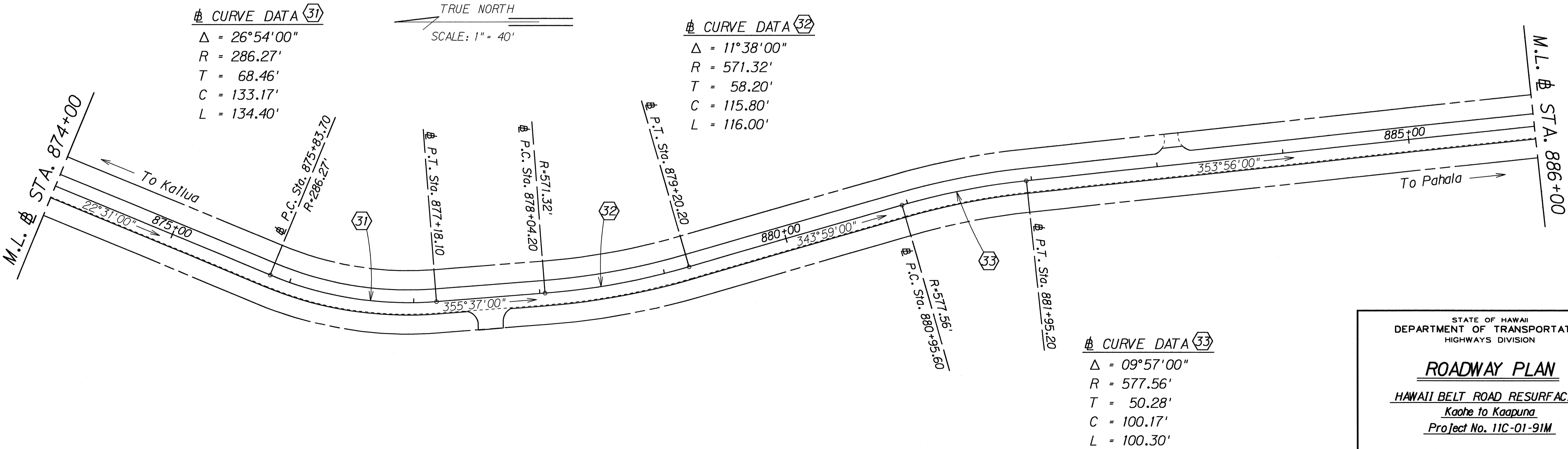
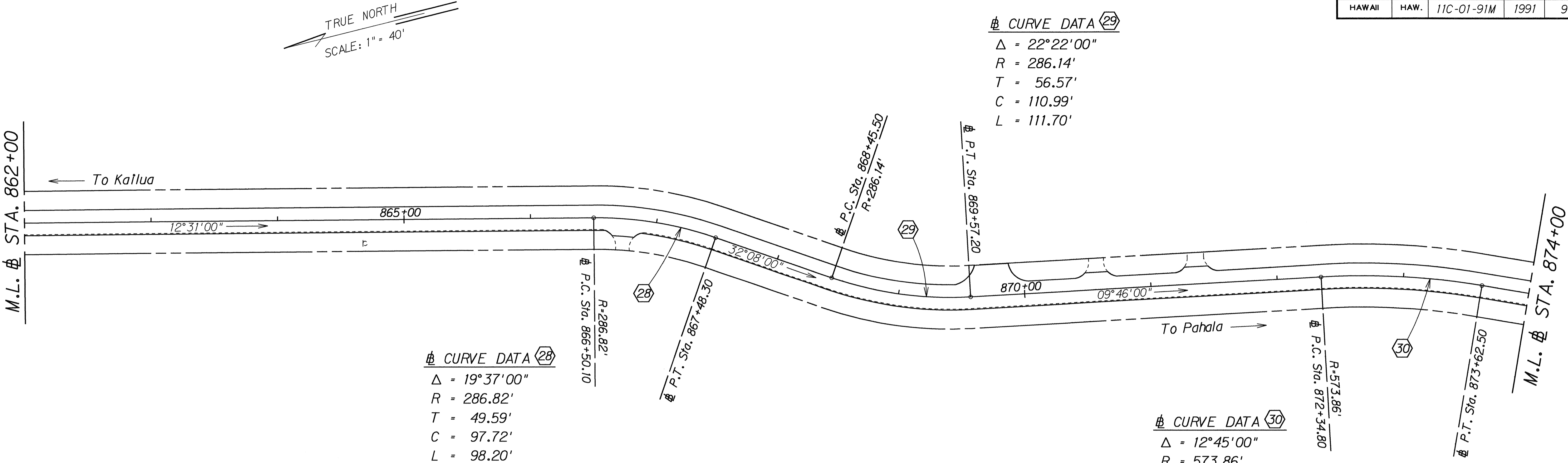

STATE OF HAWAII
DEPARTMENT OF TRANSPORTATION
HIGHWAYS DIVISION

ROADWAY PLAN

HAWAII BELT ROAD RESURFACING

Kahe to Kaapuna

Project No. 11C-01-91M

Scale: 1" = 40' Date: Sept., 1990

SHEET No. 6 OF 9 SHEETS

AS-BUILT

DATE	_____
SURVEY PLOTTED BY	_____
DRAWN BY	_____
CHECKED BY	_____
DESIGNED BY	_____
QUANTITIES BY	_____
NOTE BOOK	_____
ORIGINAL PLAN	_____
BY	_____

FED. ROAD DIST. NO.	STATE	PROJ. NO.	FISCAL YEAR	SHEET NO.	TOTAL SHEETS
HAWAII	HAW.	11C-01-91M	1991	10	23

CURVE DATA 35
 $\Delta = 11^{\circ}56'00''$
 $R = 477.25'$
 $T = 49.88'$
 $C = 99.22'$
 $L = 99.40'$

CURVE DATA 34
 $\Delta = 34^{\circ}33'00''$
 $R = 285.73'$
 $T = 88.86'$
 $C = 169.70'$
 $L = 172.30'$

CURVE DATA 36
 $\Delta = 38^{\circ}12'00''$
 $R = 286.48'$
 $T = 99.20'$
 $C = 187.48'$
 $L = 191.00'$

CURVE DATA 37
 $\Delta = 20^{\circ}40'00''$
 $R = 277.24'$
 $T = 50.55'$
 $C = 99.46'$
 $L = 100.00'$

CURVE DATA 38
 $\Delta = 66^{\circ}46'00''$
 $R = 191.02'$
 $T = 125.88'$
 $C = 210.22'$
 $L = 222.60'$

CURVE DATA 39
 $\Delta = 18^{\circ}03'00''$
 $R = 286.64'$
 $T = 45.53'$
 $C = 89.93'$
 $L = 90.30'$

CURVE DATA 40
 $\Delta = 13^{\circ}44'00''$
 $R = 574.90'$
 $T = 69.23'$
 $C = 137.47'$
 $L = 137.80'$

STATE OF HAWAII
DEPARTMENT OF TRANSPORTATION
HIGHWAYS DIVISION

ROADWAY PLAN
HAWAII BELT ROAD RESURFACING
Kaohu to Kaapuna
Project No. 11C-01-91M

Scale: 1" = 40'
Date: Sept., 1990
SHEET No. 7 OF 9 SHEETS

AS-BUILT

SURVEY PLOTTED BY	DATE
DRAWN BY	
DESIGNED BY	
QUANTITIES BY	
CHECKED BY	
ORIGINAL PLAN	
NOTE BOOK	
No.	

FED. ROAD DIST. NO.	STATE	PROJ. NO.	FISCAL YEAR	SHEET NO.	TOTAL SHEETS
HAWAII	HAW.	11C-01-91M	1991	11	23

CURVE DATA 41
 $\Delta = 15^\circ 39' 00''$
 $R = 656.06'$
 $T = 90.16'$
 $C = 178.64'$
 $L = 179.20'$

TRUE NORTH
 SCALE: 1" = 40'

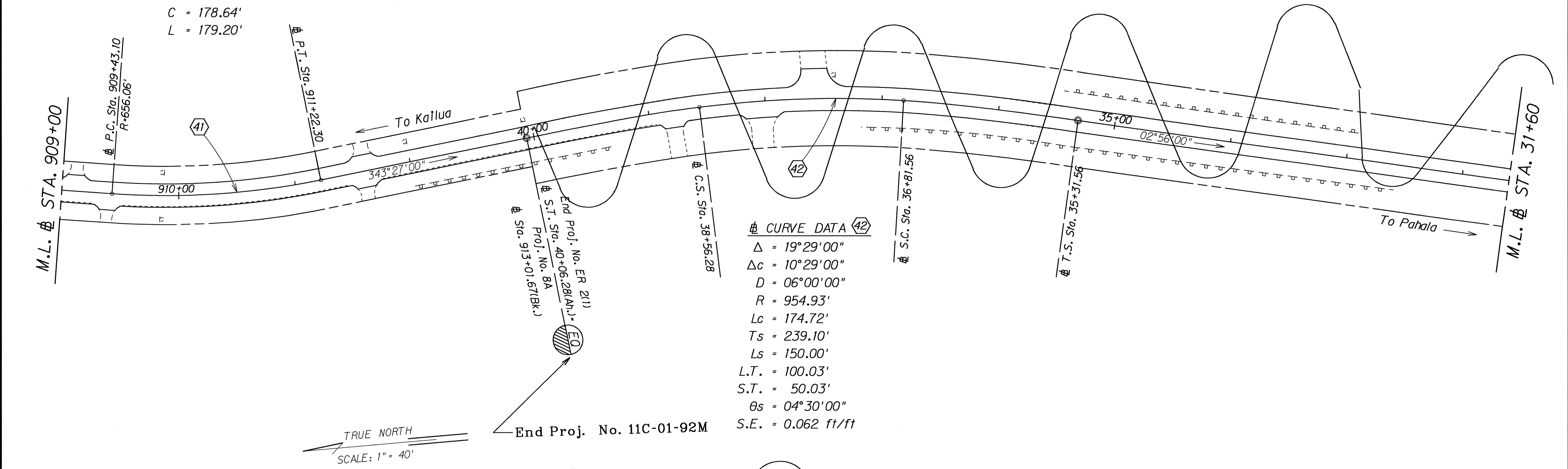

CURVE DATA 42
 $\Delta = 19^\circ 29' 00''$
 $\Delta c = 10^\circ 29' 00''$
 $D = 06^\circ 00' 00''$
 $R = 954.93'$
 $Lc = 174.72'$
 $Ts = 239.10'$
 $Ls = 150.00'$
 $L.T. = 100.03'$
 $S.T. = 50.03'$
 $\theta s = 04^\circ 30' 00''$
 $S.E. = 0.062 \text{ ft/ft}$

End Proj. No. 11C-01-92M

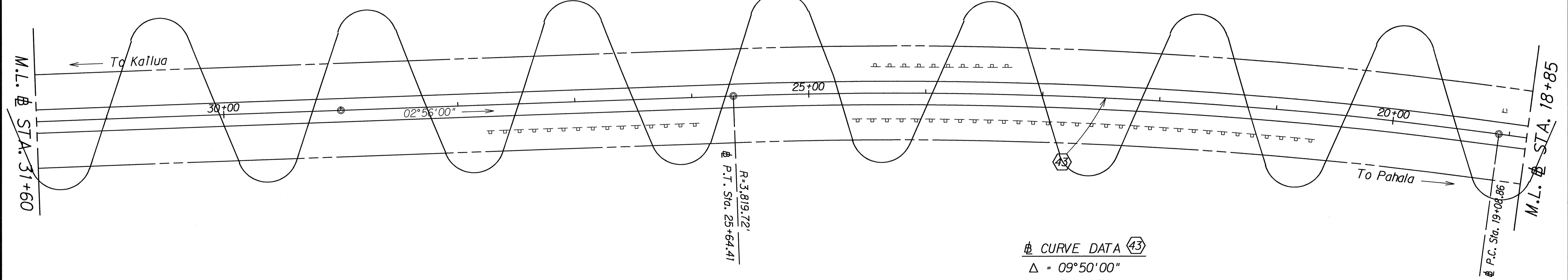

CURVE DATA 43
 $\Delta = 09^\circ 50' 00''$
 $R = 3,819.72'$
 $T = 328.58'$
 $C = 654.75'$
 $L = 655.56'$

LEGEND FOR AS-BUILT POSTINGS
 Squiggly line for as-built deletion
 Double line for as-built deletion
 Roadway Text for as-built posting

STATE OF HAWAII
 DEPARTMENT OF TRANSPORTATION
 HIGHWAYS DIVISION
ROADWAY PLAN
 HAWAII BELT ROAD RESURFACING
 Kahe to Kaapuna
 Project No. 11C-01-91M
 Scale: 1" = 40' Date: Sept., 1990
 SHEET No. 8 OF 9 SHEETS

AS-BUILT

SURVEY PLOTTED BY	DATE
DRAWN BY	
DESIGNED BY	
QUANTITIES BY	
CHECKED BY	
ORIGINAL PLAN	
NOTE BOOK	
NO.	

FED. ROAD DIST. NO.	STATE	PROJ. NO.	FISCAL YEAR	SHEET NO.	TOTAL SHEETS
HAWAII	HAW.	11C-01-91M	1991	12	23

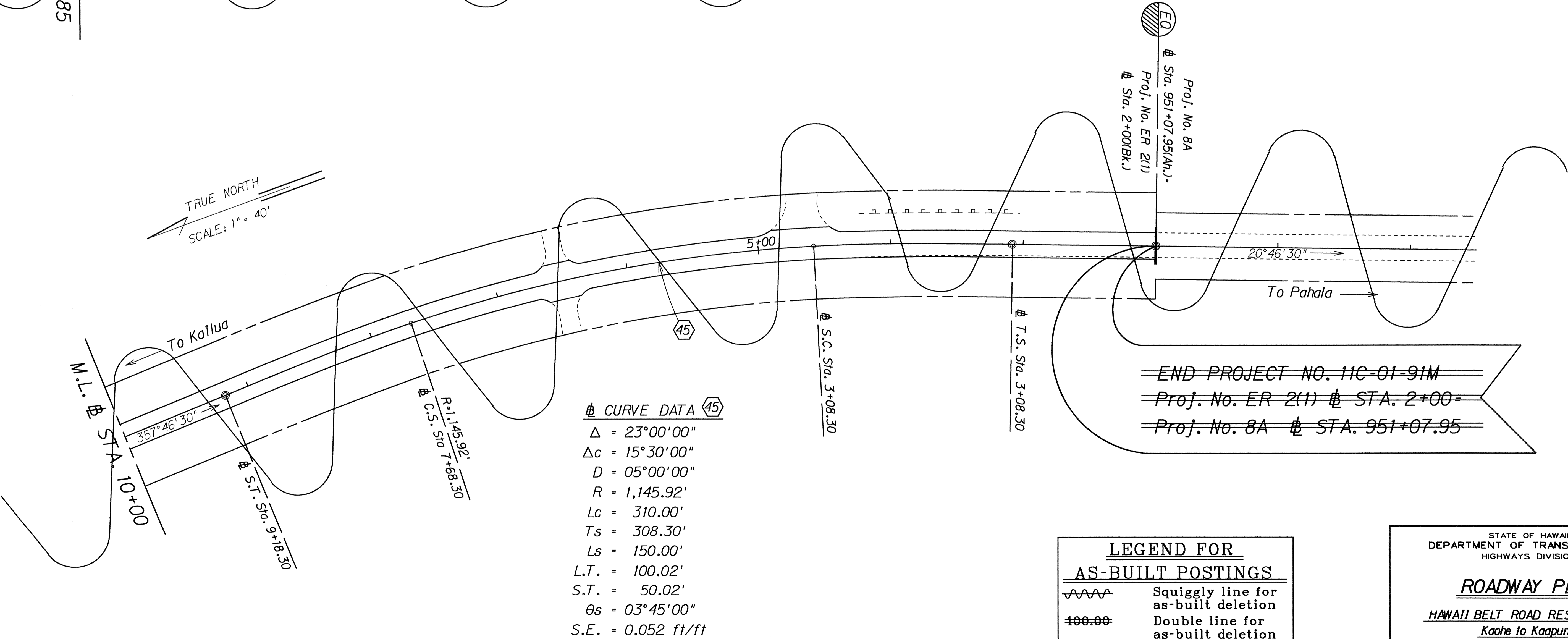
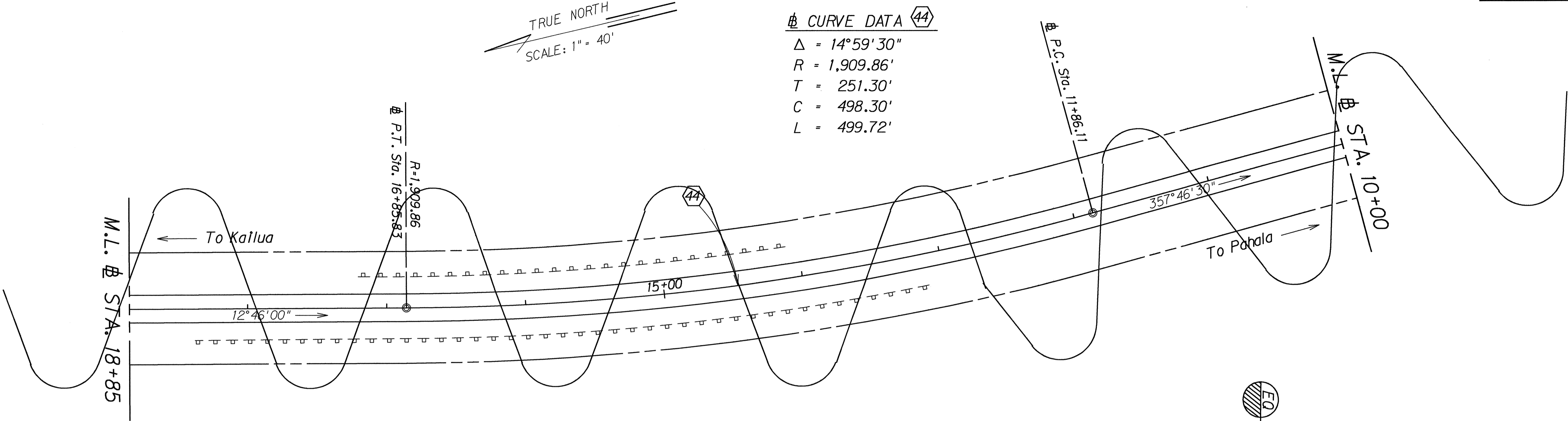

STATE OF HAWAII
DEPARTMENT OF TRANSPORTATION
HIGHWAYS DIVISION

ROADWAY PLAN

HAWAII BELT ROAD RESURFACING
Kahe to Kaapuna
Project No. 11C-01-91M

Scale: 1" = 40' Date: Sept., 1990
SHEET No. 9 OF 9 SHEETS

AS-BUILT