

FED. ROAD DIST. NO.	STATE	PROJ. NO.	FISCAL YEAR	SHEET NO.	TOTAL SHEETS
HAWAII	HAW.	11C-01-91M	1991	13	23

LEGEND

	4 each Type A Raised Pavement Markers Type CL Raised Pavement Markers @ 40' - 0" o.c.
	4 each Type J Raised Pavement Markers Type DL Raised Pavement Markers @ 40' - 0" o.c.
	8" White Stripe with Type CL Raised Pavement Markers @ 20' - 0" o.c. (Tape, Type I or Thermoplastic Extrusion)
	4" Double Solid Yellow with Type DL Raised Pavement Markers @ 20' - 0" o.c. (Tape, Type I or Thermoplastic Extrusion)
	4" Double Solid Yellow Stripes with Type HL Raised Pavement Markers @ 20' - 0" o.c. (Tape, Type II or Thermoplastic Extrusion)
	4" Yellow Edge Stripe with Type HL Raised Pavement Markers @ 40' - 0" o.c. (Tape, Type II or Thermoplastic Extrusion)
	4" Double Solid White Stripes with Type CL Raised Pavement Markers @ 20' - 0" o.c. (Tape, Type I or Thermoplastic Extrusion)
	Lane Change Restriction Marking 4 each Type A Raised Pavement Markers Type CL Raised Pavement Markers @ 20' - 0" o.c. 4" White Stripe (Tape, Type I or Thermoplastic Extrusion)
	4" White Edge Stripe with Type CL Raised Pavement Markers @ 40' - 0" o.c. (Tape, Type II or Thermoplastic Extrusion)
	4" White Guide Lines (Thermoplastic Extrusion)
	Transverse Median Marking (Tape, Type II or Thermoplastic Extrusion)
	Transverse Shoulder Marking (Tape, Type II or Thermoplastic Extrusion)
	Channelizing Island or Deceleration Lane Gore (Tape, Type II or Thermoplastic Extrusion)
	Crosswalk and Stop Line. All Stop Lines shall be 10' - 0" from Crosswalk unless otherwise noted. The circled number indicates the number of lanes for payment. (Thermoplastic Extrusion)
	Pavement Arrow (Tape, Type I or Thermoplastic Extrusion)
	Pavement Word (Tape, Type I or Thermoplastic Extrusion)
	4 Each Type J Raised Pavement Markers Type DL Raised Pavement Markers @ 40' - 0" o.c. Type HL Raised Pavement Markers (Reflective Surface facing no-passing direction)
	4" Single Solid Yellow Stripe (Tape, Type I or Thermoplastic Extrusion)
	Extension of Edge Line, 4" Wide x 2' - 0" Long White Stripe @ 10' - 0" o.c. w/Type CL Markers @ 40' - 0" o.c. (Thermoplastic Extrusion)

NOTES

- Layout of pavement markings and striping shall be done by the Contractor and approved by the Engineer prior to any installation work.
- Existing pavement markings not incorporated in the final traffic pattern shall be removed as directed by the Engineer. Costs shall be incidental to the various pavement marking items.
- Raised pavement markers shall not be installed within crosswalks.
- Details of Type C, Type D and Type H Markers on Standard Plan Nos. TE-30, TE-31 and TE-32 shall be deleted and replaced with details of Type CL, Type DL and Type HL Markers as shown on this sheet. All references to Type C, Type D and Type H Markers in the plans shall mean Type CL, Type DL and Type HL Markers.
- Final locations of all signs shall be approved by the Engineer prior to any installation work.
- Existing signs not shown on these plans shall remain as posted unless otherwise directed by the Engineer. Removal and disposal of existing signs and/or posts as designated on these plans shall be incidental to the various signing items.
- Final locations of all Stop Lines shall be approved by the Engineer prior to installation.
- All pavement striping shall be as noted on the Legend or plans.
- All preformed pavement marking tapes over existing pavement shall be applied with an approved primer as recommended by the tape manufacturer and as approved by the Engineer. The primer shall be allowed to dry to the tacky stage prior to tape application.

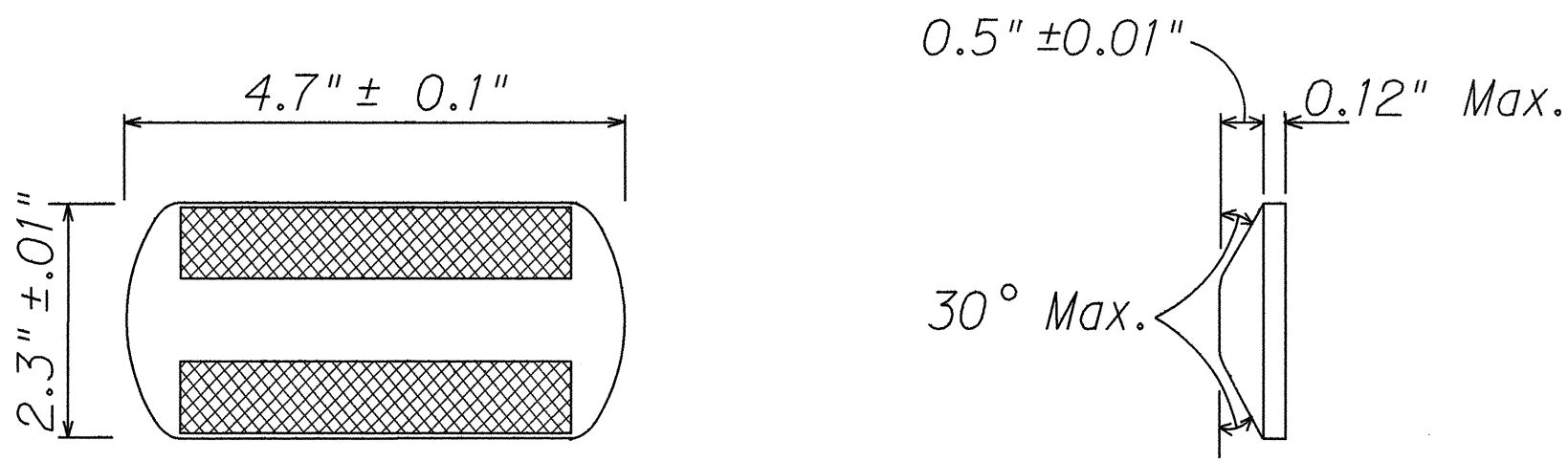

TYPE CL  
Red-Clear Reflective Marker  
or

TYPE DL  
Two-Way Yellow Reflective Marker  
or

TYPE HL  
One-Way Yellow Reflective Marker

RAISED PAVEMENT MARKER DETAILS

Not to Scale

STATE OF HAWAII  
DEPARTMENT OF TRANSPORTATION  
HIGHWAYS DIVISION

PAVEMENT MARKING

LEGEND, DETAILS & NOTES

HAWAII BELT ROAD RESURFACING

Kaohi to Kaapuna

Project No. 11C-01-91M

Date: Mar., 1991

SHEET No. T1 OF 11 SHEETS

AS-BUILT

FED. ROAD DIST. NO.	STATE	FED. AID PROJ. NO.	FISCAL YEAR	SHEET NO.	TOTAL SHEETS
HAWAII	HAW.	11C-01-91M	1991	14	23

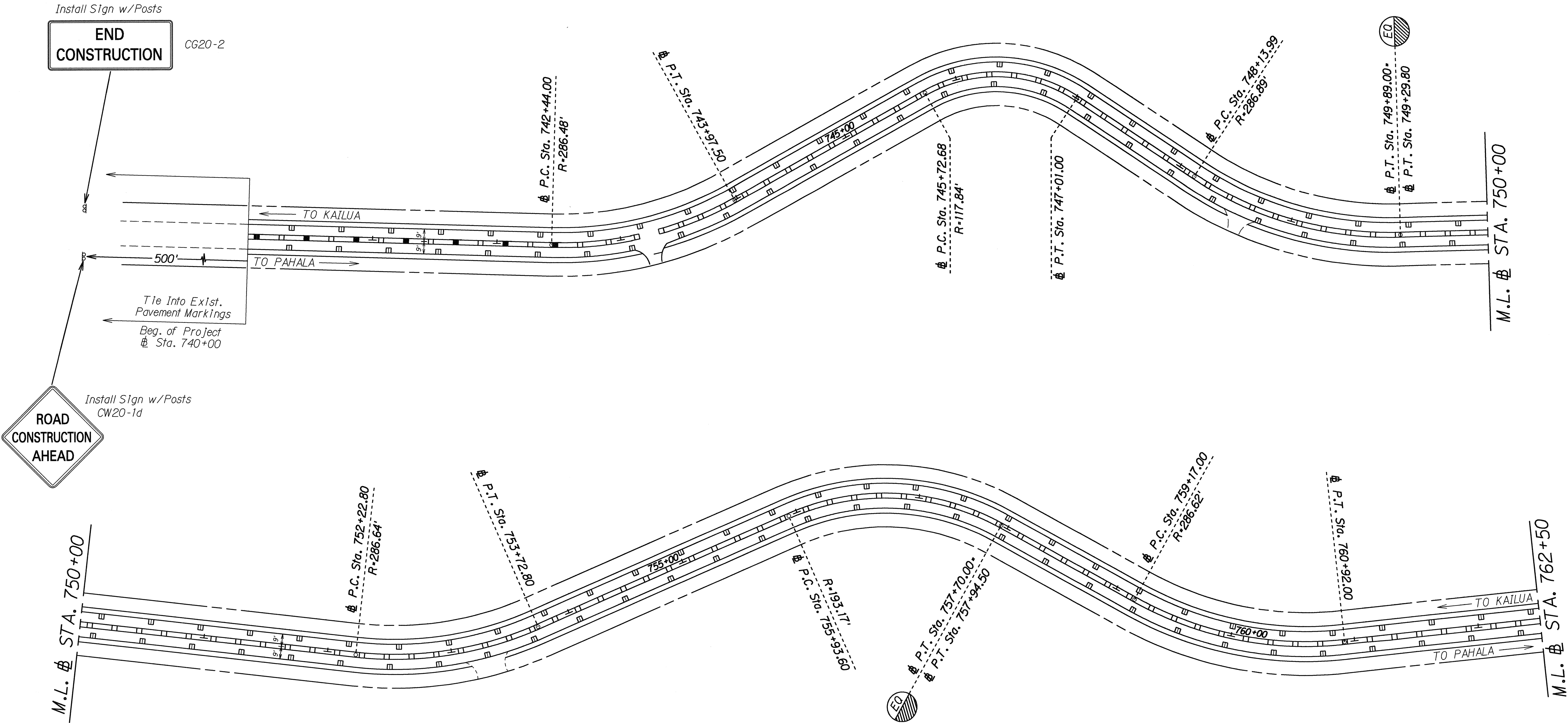

LEGEND FOR  
AS-BUILT POSTINGS

Squiggly line for  
as-built deletion

Double line for  
as-built deletion

Text for as-built  
posting

STATE OF HAWAII  
DEPARTMENT OF TRANSPORTATION  
HIGHWAYS DIVISION  
PAVEMENT MARKING &  
STRIPING PLAN  
HAWAII BELT ROAD RESURFACING  
Kaohe to Kaapuna  
Project No. 11C-01-91M  
Scale: 1" = 40'  
Date: Mar., 1991  
SHEET No. T2 OF 11 SHEETS

ORIGINAL PLAN	SURVEY PLOTTED BY	DATE
NOTE BOOK	DRAWN BY	
	DESIGNED BY	
	QUANTITIES BY	
	CHECKED BY	
	No.	



FED. ROAD DIST. NO.	STATE	PROJ. NO.	FISCAL YEAR	SHEET NO.	TOTAL SHEETS
HAWAII	HAW.	11C-01-91M	1991	15	23

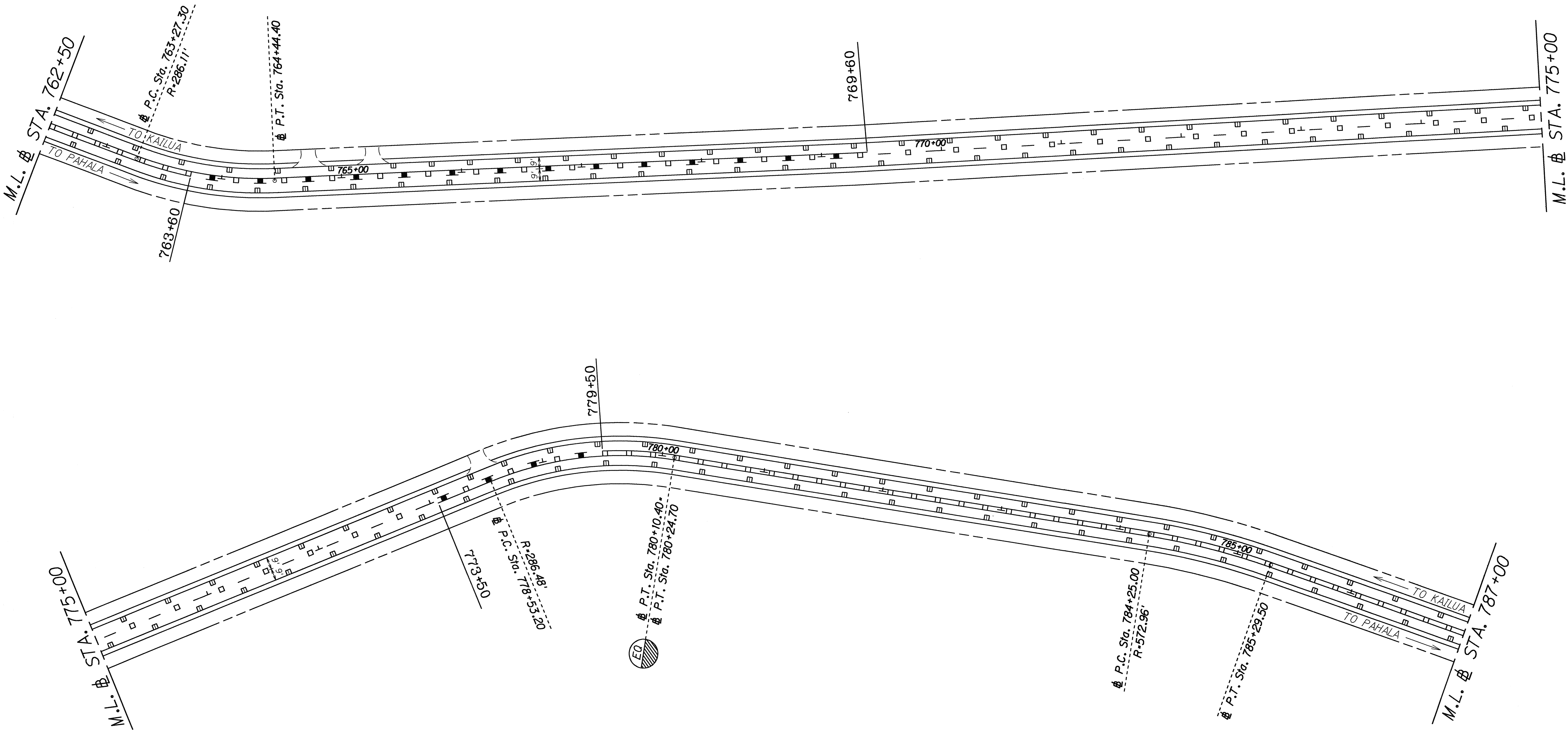

SURVEY PLOTTED BY	DATE
DRAWN BY	
DESIGNED BY	
QUANTITIES BY	
CHECKED BY	
ORIGINAL PLAN	
NOTE BOOK	
N <sub>o</sub> .	

LEGEND FOR AS-BUILT POSTINGS	
	Squiggly line for as-built deletion
	Double line for as-built deletion
Roadway	Text for as-built posting

STATE OF HAWAII  
DEPARTMENT OF TRANSPORTATION  
HIGHWAYS DIVISION

PAVEMENT MARKING &  
STRIPING PLAN

HAWAII BELT ROAD RESURFACING  
Kahe to Kaapuna  
Project No. 11C-01-91M

Scale: 1" = 40'  
Date: Mar., 1991

SHEET No. 13 OF 11 SHEETS

FED. ROAD DIST. NO.	STATE	PROJ. NO.	FISCAL YEAR	SHEET NO.	TOTAL SHEETS
HAWAII	HAW.	11C-01-91M	1991	16	23

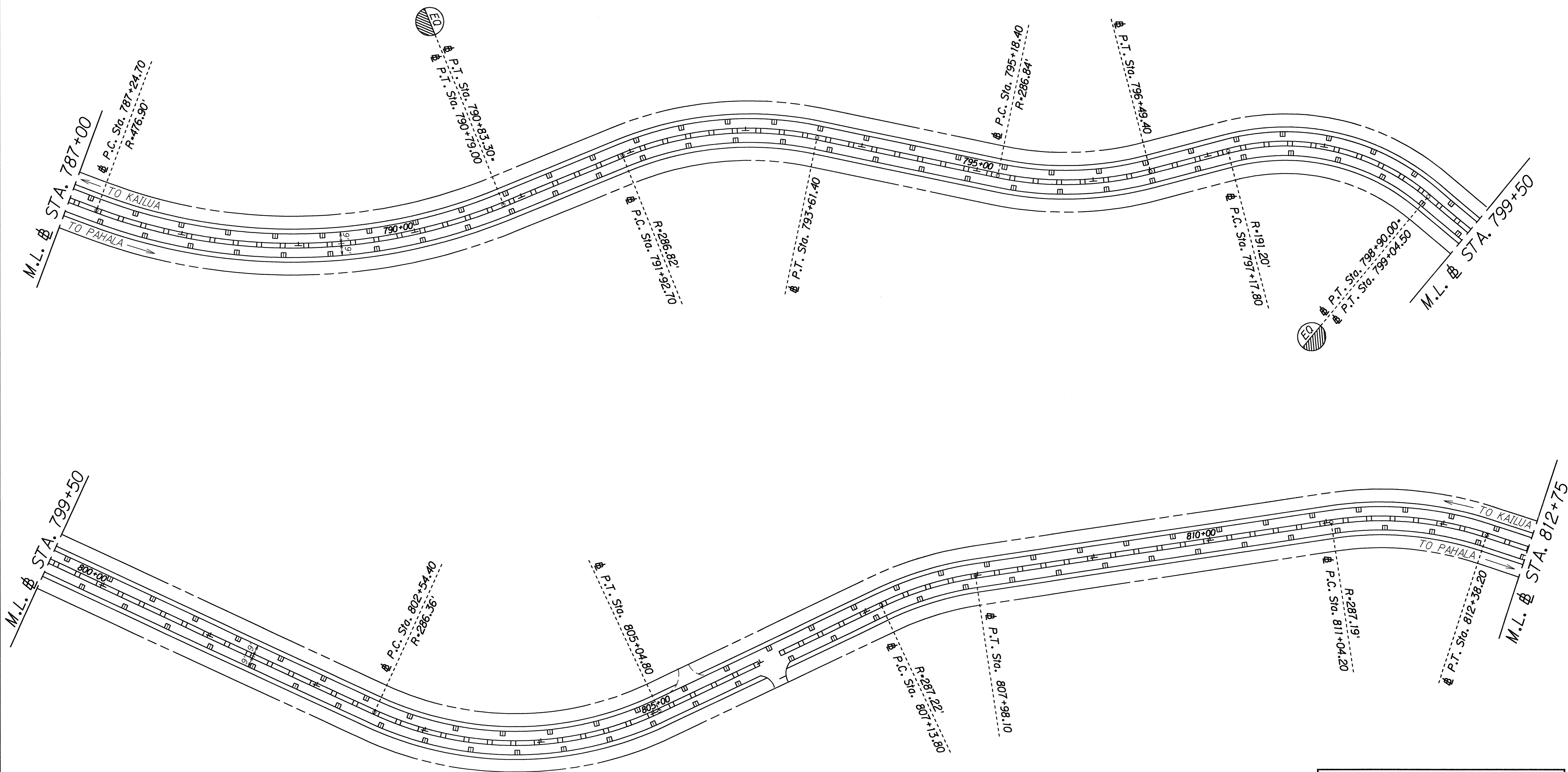

STATE OF HAWAII  
DEPARTMENT OF TRANSPORTATION  
HIGHWAYS DIVISION

**PAVEMENT MARKING &  
STRIPING PLAN**

HAWAII BELT ROAD RESURFACING  
Kaohoe to Kaapuna  
Project No. 11C-01-91M

Scale: 1" = 40'      Date: Mar., 1991

SHEET No. T4 OF 11 SHEETS

FED. ROAD DIST. NO.	STATE	PROJ. NO.	FISCAL YEAR	SHEET NO.	TOTAL SHEETS
HAWAII	HAW.	11C-01-91M	1991	17	23

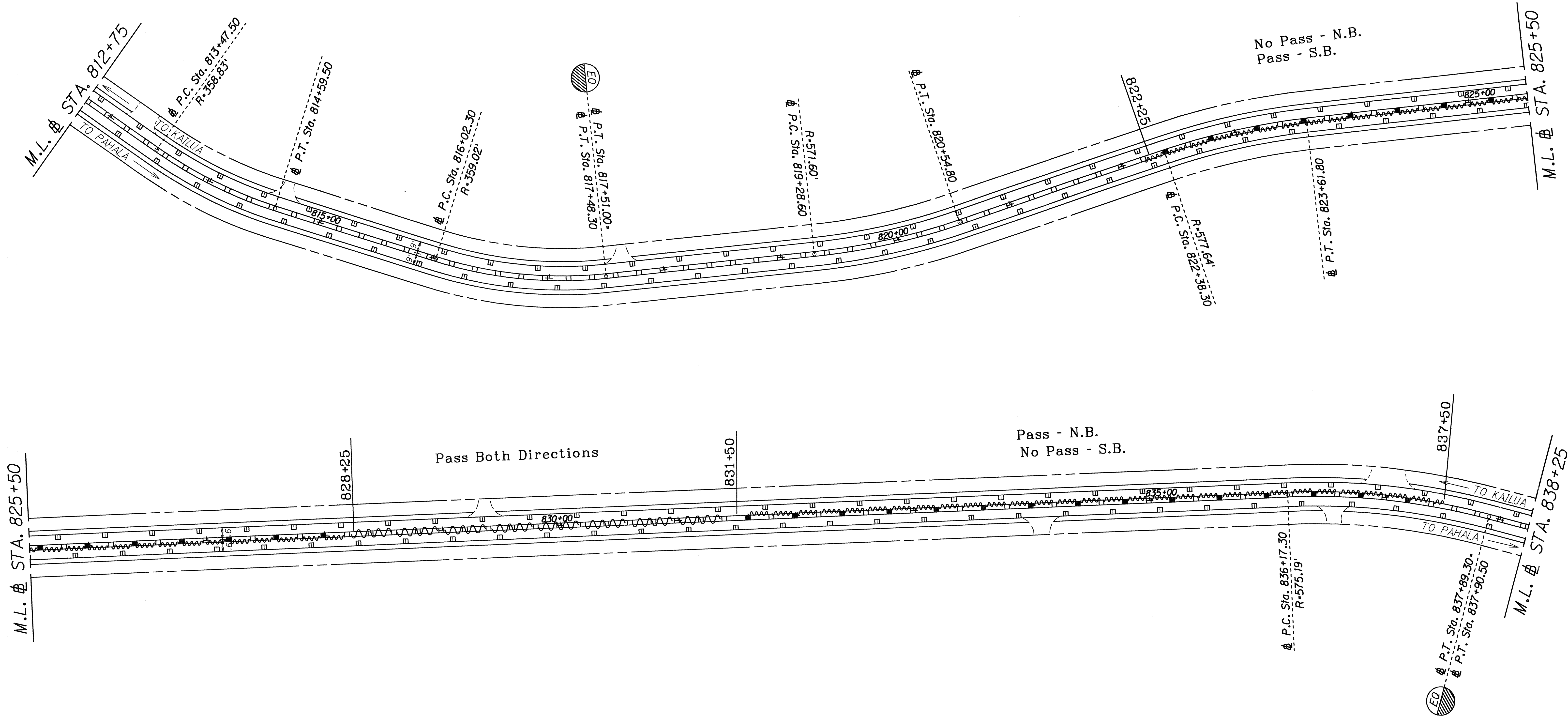

ORIGINAL PLAN	SURVEY PLOTTED BY	DATE
TRACED BY		
NOTED BY		
CHECKED BY		

LEGEND FOR AS-BUILT POSTINGS	
	Squiggly line for as-built deletion
	Double line for as-built deletion
Roadway	Text for as-built posting

STATE OF HAWAII  
DEPARTMENT OF TRANSPORTATION  
HIGHWAYS DIVISION

PAVEMENT MARKING &  
STRIPING PLAN  
HAWAII BELT ROAD RESURFACING  
Kaohe to Kaapuna  
Project No. 11C-01-91M

Scale: 1" = 40'  
Date: Mar., 1991

SHEET No. T5 OF 11 SHEETS

AS-BUILT



FED. ROAD DIST. NO.	STATE	PROJ. NO.	FISCAL YEAR	SHEET NO.	TOTAL SHEETS
HAWAII	HAW.	11C-01-91M	1991	18	23

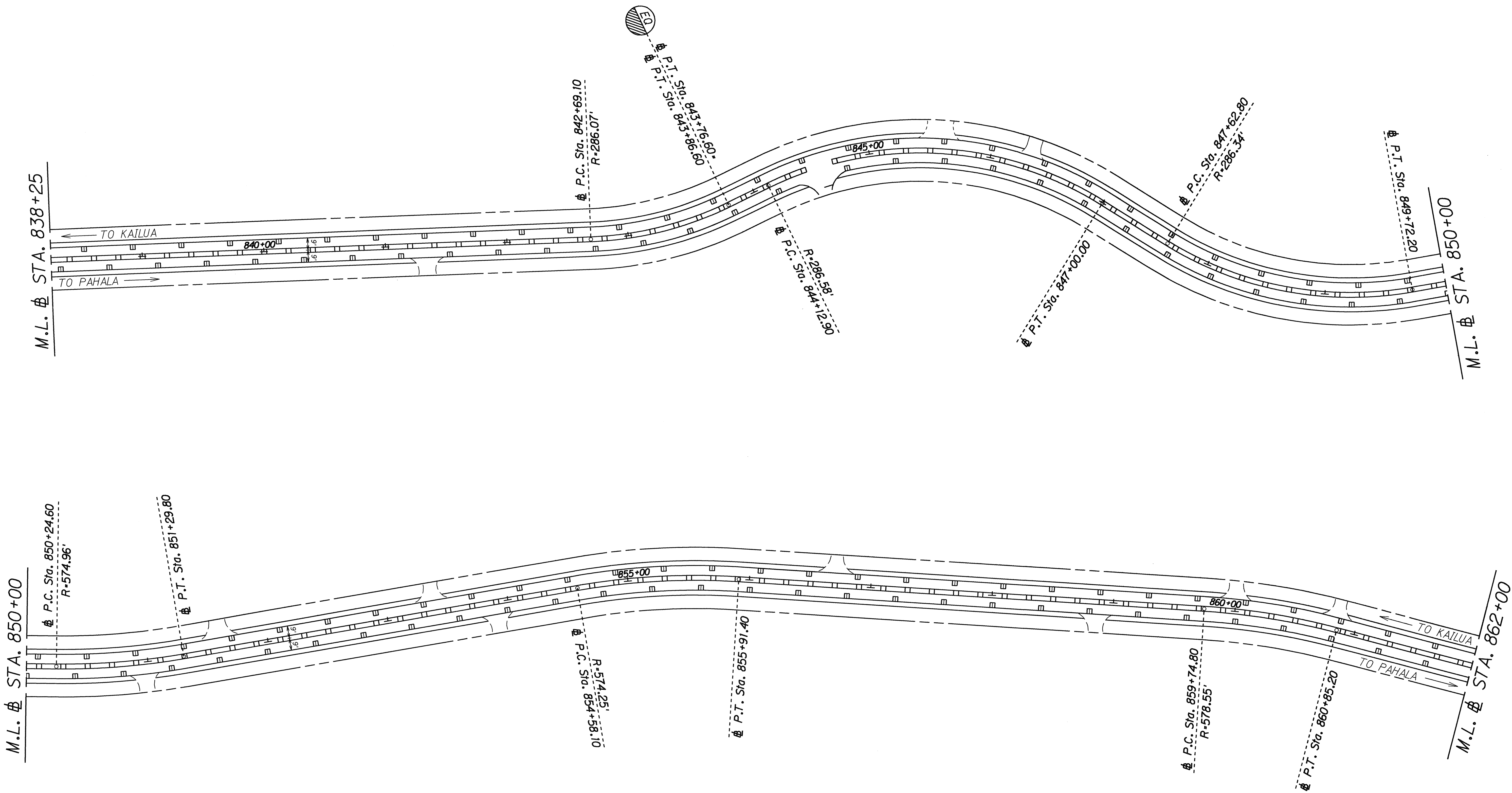

STATE OF HAWAII  
DEPARTMENT OF TRANSPORTATION  
HIGHWAYS DIVISION

**PAVEMENT MARKING &  
STRIPING PLAN**

HAWAII BELT ROAD RESURFACING  
Kaahe to Kaapuna  
Project No. 11C-01-91M

Scale: 1" = 40' Date: Mar., 1991

SHEET No. 16 OF 11 SHEETS

AS-BUILT

FED. ROAD DIST. NO.	STATE	PROJ. NO.	FISCAL YEAR	SHEET NO.	TOTAL SHEETS
HAWAII	HAW.	11C-01-91M	1991	19	23

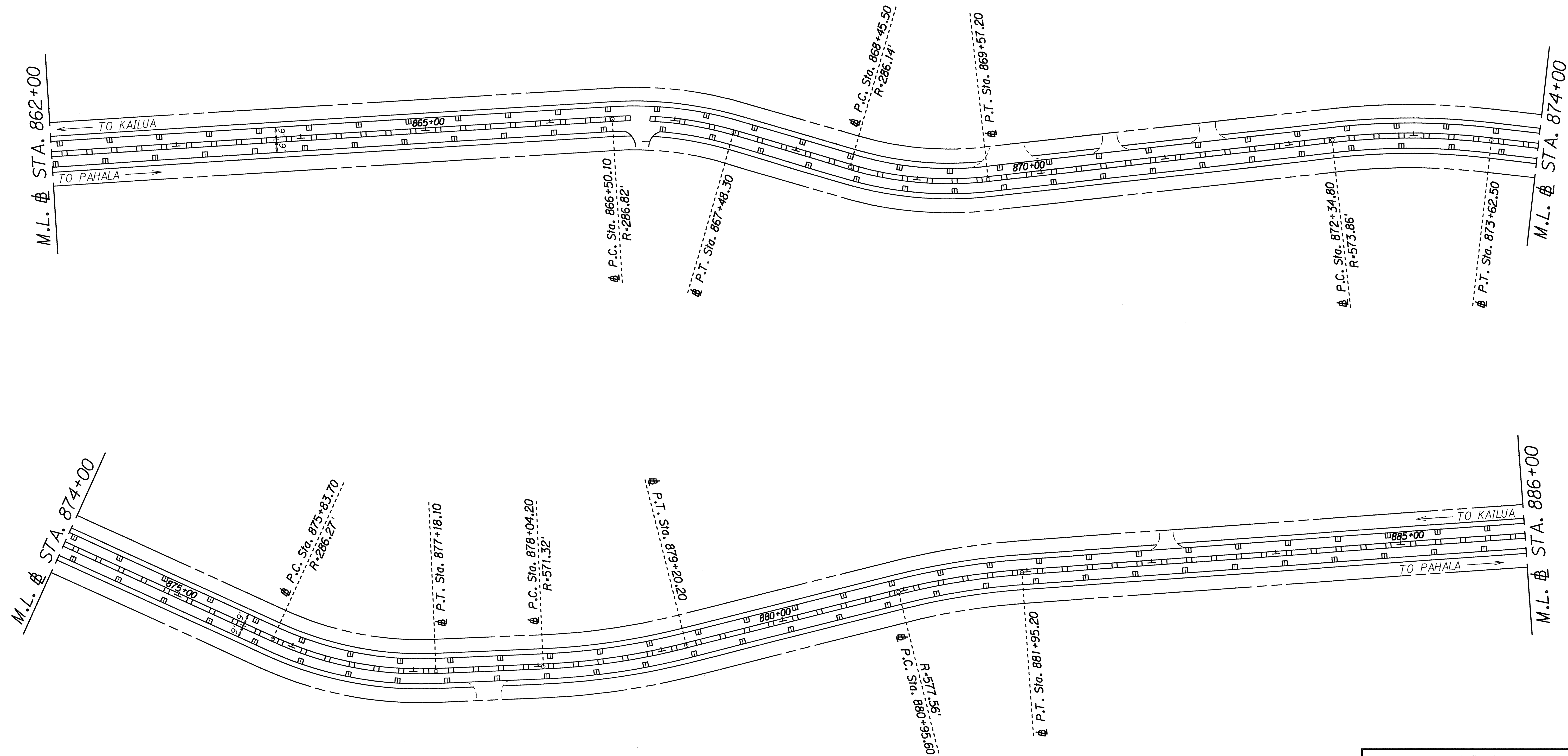

ORIGINAL PLAN	SURVEY PLOTTED BY	DATE
NOTE BOOK	DRAWN BY	
	DESIGNED BY	
	QUANTITIES BY	
	CHECKED BY	

STATE OF HAWAII  
DEPARTMENT OF TRANSPORTATION  
HIGHWAYS DIVISION

**PAVEMENT MARKING &  
STRIPING PLAN**

HAWAII BELT ROAD RESURFACING  
Kaho to Kaapuna  
Project No. 11C-01-91M

Scale: 1" = 40' Date: Mar., 1991

SHEET No. 17 OF 11 SHEETS

AS-BUILT

FED. ROAD DIST. NO.	STATE	PROJ. NO.	FISCAL YEAR	SHEET NO.	TOTAL SHEETS
HAWAII	HAW.	11C-01-91M	1991	20	23

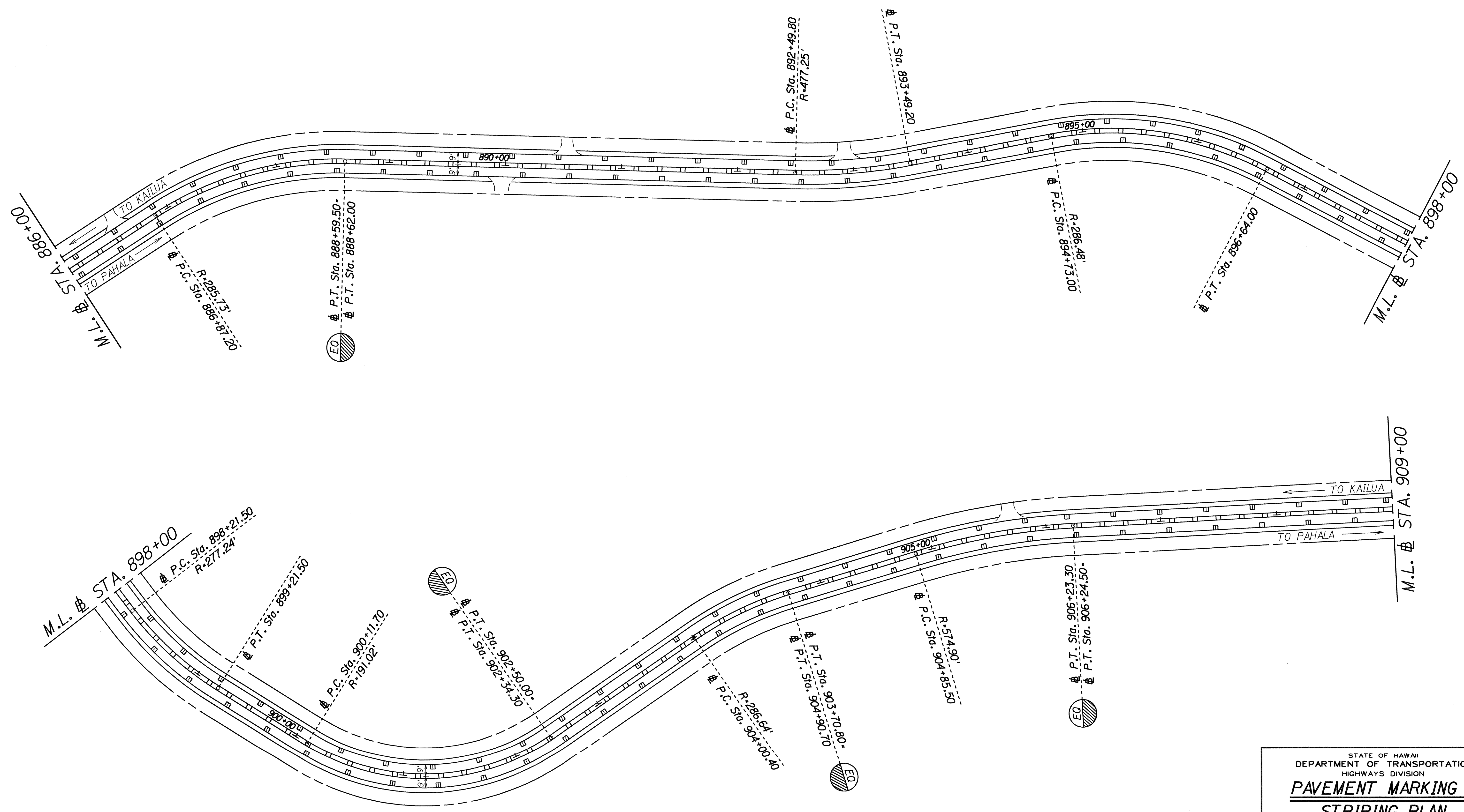

ORIGINAL	SURVEY PLOTTED BY	DATE
PLAN	DRAWN BY	
NOTE BOOK	DESIGNED BY	
	QUANTITIES BY	
	CHECKED BY	

STATE OF HAWAII  
DEPARTMENT OF TRANSPORTATION  
HIGHWAYS DIVISION

**PAVEMENT MARKING &  
STRIPING PLAN**

**HAWAII BELT ROAD RESURFACING**  
*Kaohi to Kaapuna*  
Project No. 11C-01-91M

Scale: 1" = 40' Date: Mar., 1991

SHEET No. 18 OF 11 SHEETS

AS-BUILT



FED. ROAD DIST. NO.	STATE	PROJ. NO.	FISCAL YEAR	SHEET NO.	TOTAL SHEETS
HAWAII	HAW.	11C-01-91M	1991	21	23

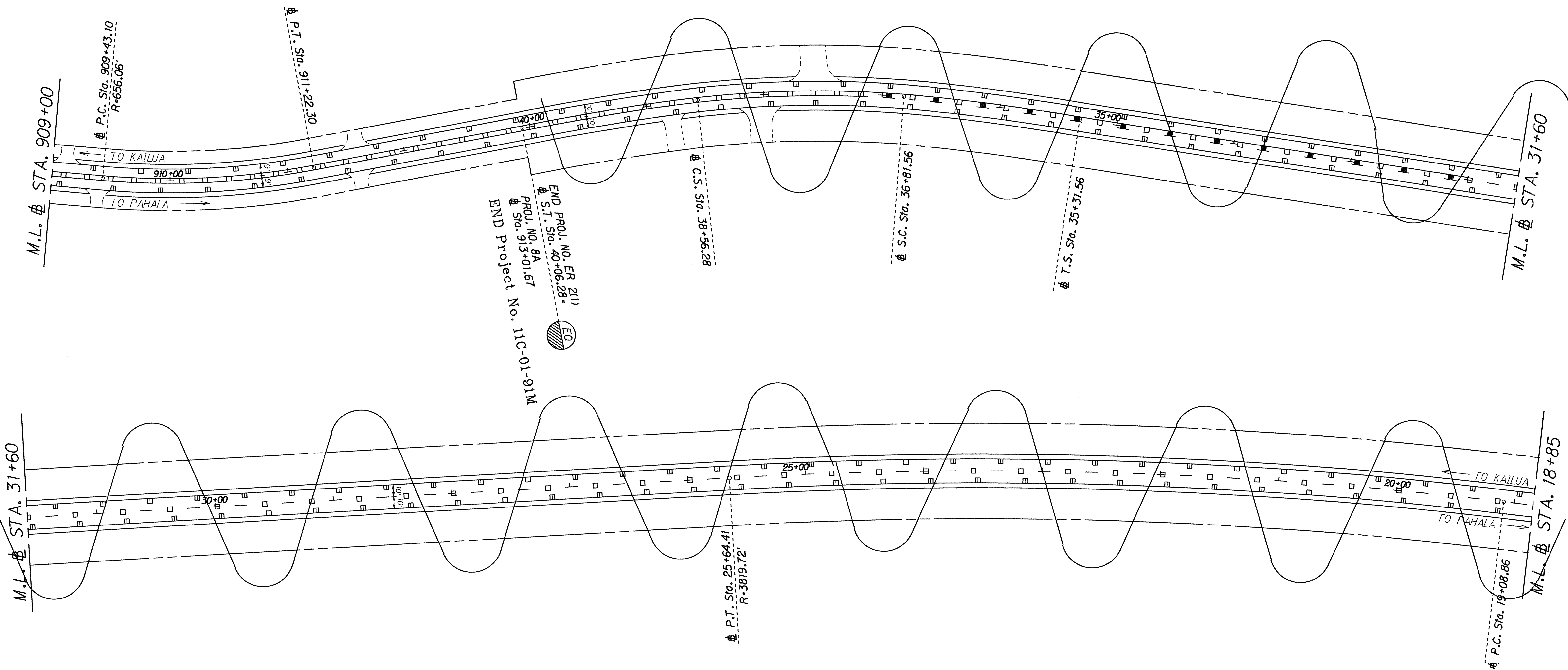

ORIGINAL	SURVEY PLOTTED BY	DATE
PLAN	DESIGNED BY	
NOTE BOOK	TRACED BY	
	QUANTITIES BY	
	CHECKED BY	
No.		

LEGEND FOR AS-BUILT POSTINGS	
	Squiggly line for as-built deletion
	Double line for as-built deletion
Roadway	Text for as-built posting

STATE OF HAWAII  
DEPARTMENT OF TRANSPORTATION  
HIGHWAYS DIVISION

**PAVEMENT MARKING &  
STRIPING PLAN**

HAWAII BELT ROAD RESURFACING  
Kaohe to Kaapuna  
Project No. 11C-01-91M

Scale: 1" = 40' Date: Mar., 1991

SHEET No. 79 OF 11 SHEETS

AS-BUILT

FED. ROAD DIST. NO.	STATE	PROJ. NO.	FISCAL YEAR	SHEET NO.	TOTAL SHEETS
HAWAII	HAW.	11C-01-91M	1991	22	23

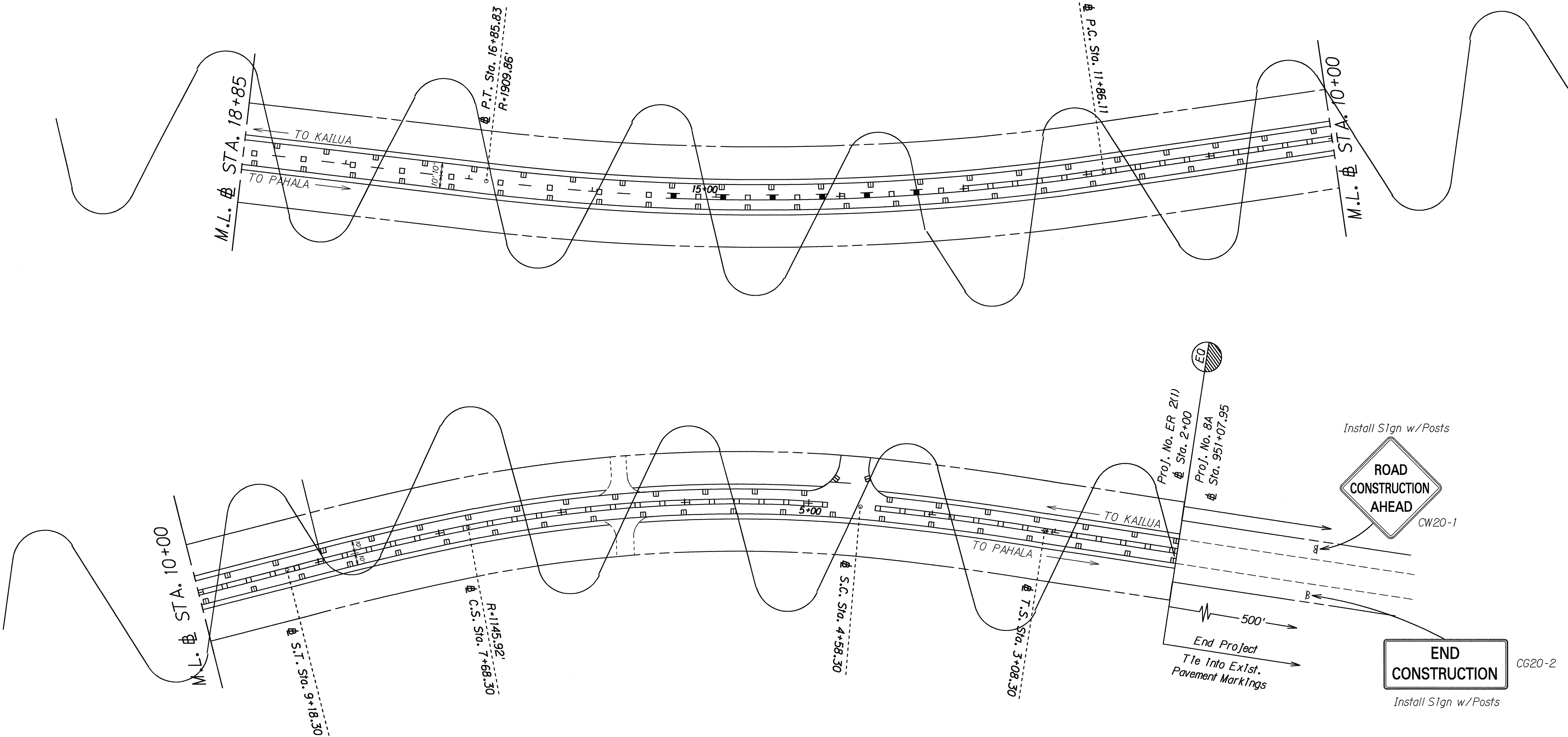

ORIGINAL PLAN	DATE
DRAWN BY	
DESIGNED BY	
QUANTITIES BY	
CHECKED BY	
NO.	

LEGEND FOR AS-BUILT POSTINGS	
	Squiggly line for as-built deletion
	Double line for as-built deletion
Roadway	Text for as-built posting

STATE OF HAWAII  
DEPARTMENT OF TRANSPORTATION  
HIGHWAYS DIVISION

**PAVEMENT MARKING & STRIPING PLAN**  
HAWAII BELT ROAD RESURFACING  
Kaohoe to Kaapuna  
Project No. 11C-01-91M

Scale: 1" = 40'  
Date: Mar., 1991

SHEET No. 11 OF 11 SHEETS

FED. ROAD DIST. NO.	STATE	PROJ. NO.	FISCAL YEAR	SHEET NO.	TOTAL SHEETS
HAWAII	HAW.	11C-01-91M	1991	23	23

PAVEMENT MARKING SUMMARY	
DESCRIPTION	QUANTITY
PAVEMENT MARKERS	
TYPE CL _____	<del>8921,060</del> EACH
TYPE DL _____	<del>803,957</del> EACH
TYPE HL _____	<del>60,444</del> EACH
TYPE J _____	<del>304,364</del> EACH
TAPE - TYPE I OR THERMOPLASTIC EXTRUSION	
4-INCH PAVEMENT STRIPE (YELLOW) _____	<del>2400</del>
DOUBLE 4-INCH PAVEMENT STRIPE (YELLOW) _____	<del>1,750</del> L. F.
	<del>16,911</del> L. F.
	<del>14,474</del>
TAPE - TYPE II OR THERMOPLASTIC EXTRUSION	
4-INCH PAVEMENT STRIPE (WHITE) _____	<del>35,136</del>
	<del>42,394</del> L. F.
THERMOPLASTIC EXTRUSION	
12-INCH PAVEMENT STRIPE (WHITE) _____	60 L. F.

CONSTRUCTION SIGN SUMMARY			
SIGN NO.	MESSAGE	W/POST	W/O POST
CW20-1d	ROAD CONSTRUCTION AHEAD	2	
CG20-2	END CONSTRUCTION	2	
	TOTAL	4	0

ORIGINAL PLAN	SURVEY PLOTTED BY _____ DATE _____
NOTE BOOK	DRAWN BY _____
	TRACED BY _____
	DESIGNED BY _____
	QUANTITIES BY _____
N <sub>o</sub> _____	CHECKED BY _____

<u>LEGEND FOR</u> <u>AS-BUILT POSTINGS</u>	
	Squiggly line for as-built deletion
<del>100.00</del>	Double line for as-built deletion
Roadway	Text for as-built posting

STATE OF HAWAII  
DEPARTMENT OF TRANSPORTATION  
HIGHWAYS DIVISION

**MISCELLANEOUS SUMMARIES**

**HAWAII BELT ROAD RESURFACING**  
**Kahe to Kaapuna**  
**Project No. 11C-01-91M**

*Date: Mar., 1991*

SHEET No. 111 OF 11 SHEETS