

| FED. ROAD DIST. NO. | STATE | PROJ. NO. | FISCAL YEAR | SHEET NO. | TOTAL SHEETS |
|---------------------|-------|-----------|-------------|-----------|--------------|
| HAWAII              | HAW.  | 11B-01-20 | 2022        | 24        | 34           |

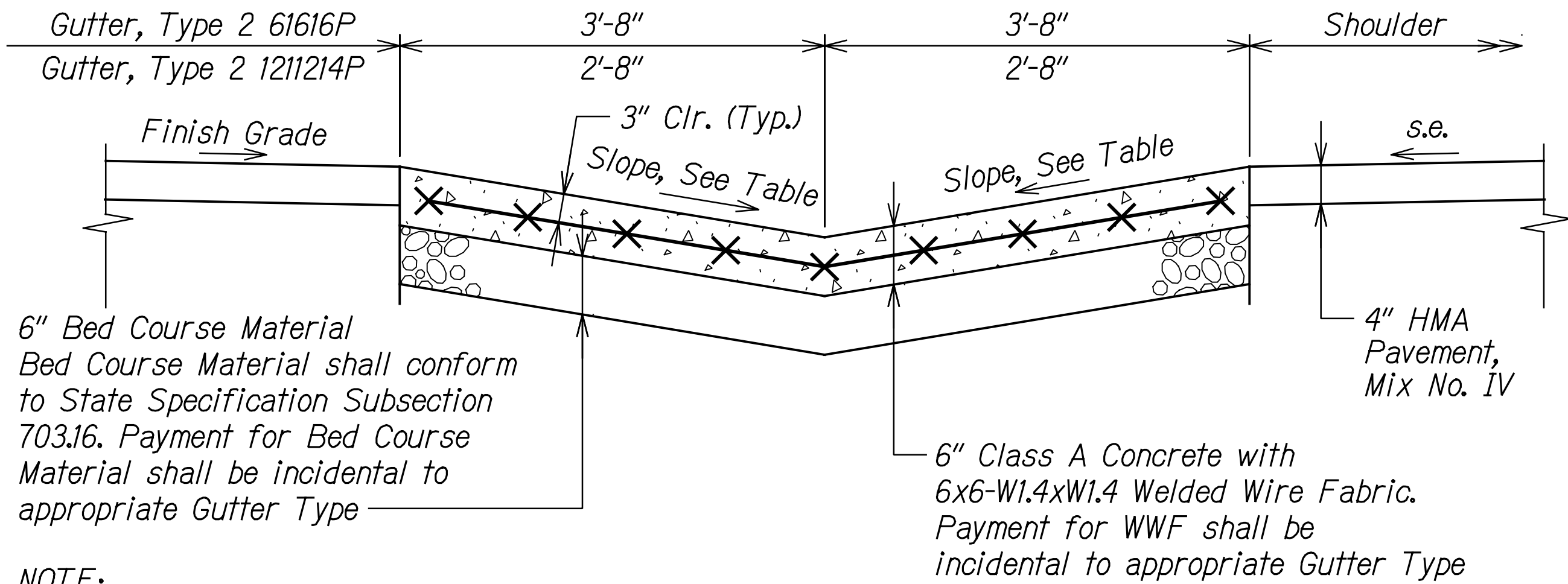

**NOTE:**

The Contractor shall provide contraction joints at 30' max. spacing. Payment for contraction joint shall be incidental to appropriate gutter type.

**TABLE GUTTER, TYPE 2 61616P OR 1211214P**  
Scale 1" = 1'-0"

| Type     | Slope | Gutter Width |
|----------|-------|--------------|
| 61616P   | 6:1   | 7'-4"        |
| 1211214P | 12:1  | 5'-4"        |

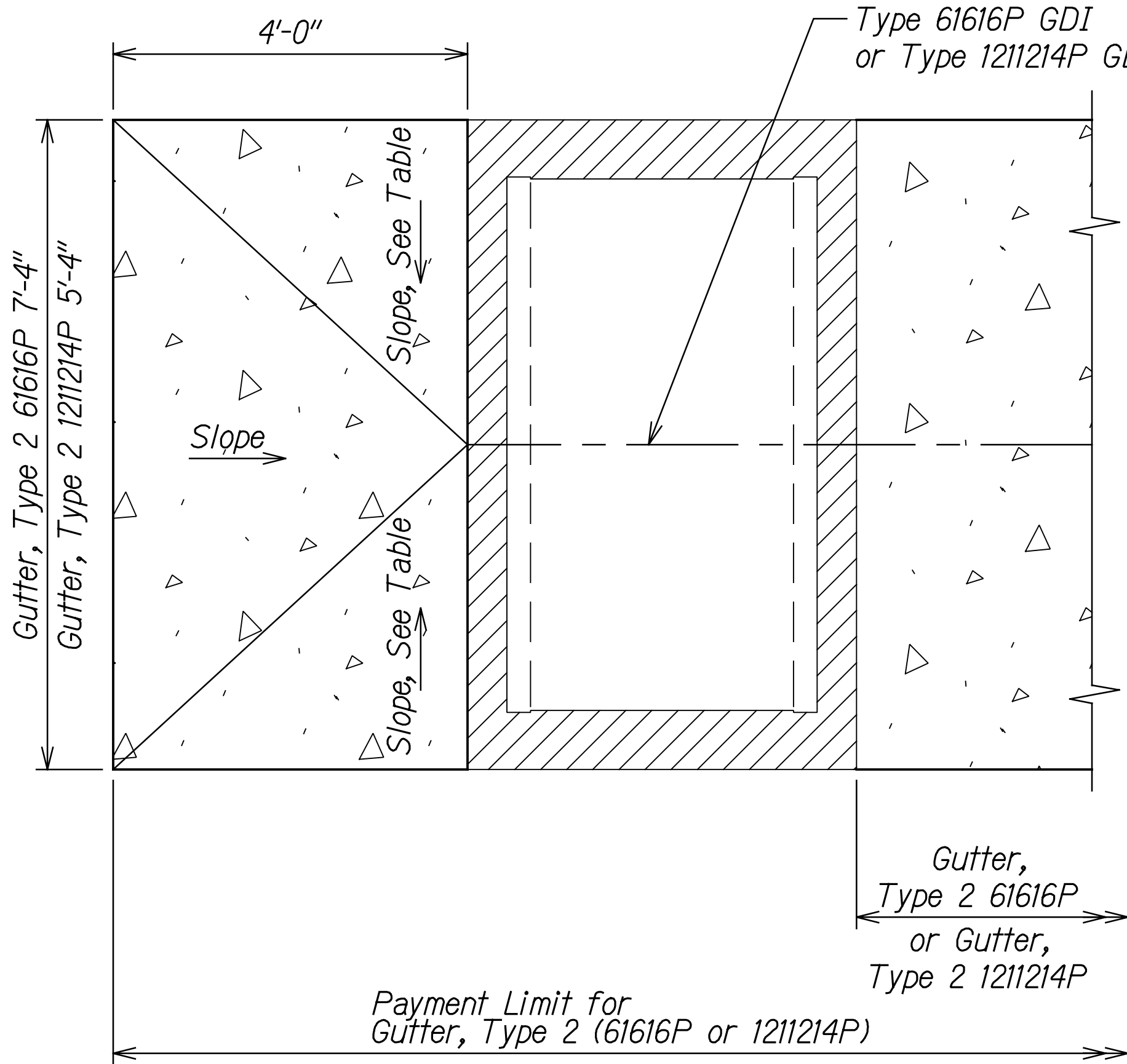

**BEGIN AND END OF GUTTER DETAIL**  
Not to Scale

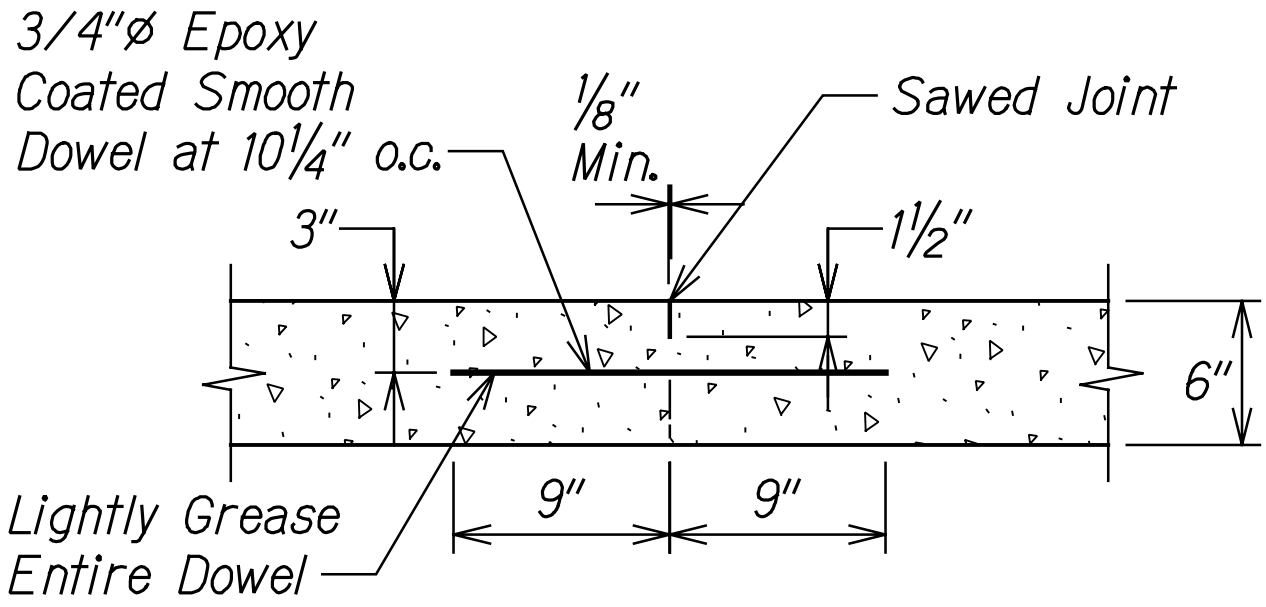

**CONTRACTION JOINT DETAIL**  
Not to Scale

**CONTRACTION JOINT NOTES:**

- Epoxy coated dowels shall conform to AASHTO M 284/M 284 M Grade 40 or 60.
- Contraction joints shall be placed at 30' max. spacing along gutter.
- Payment for contraction joints shall be incidental to appropriate gutter type.
- For joint filler, see State Specification Subsection 705.04.

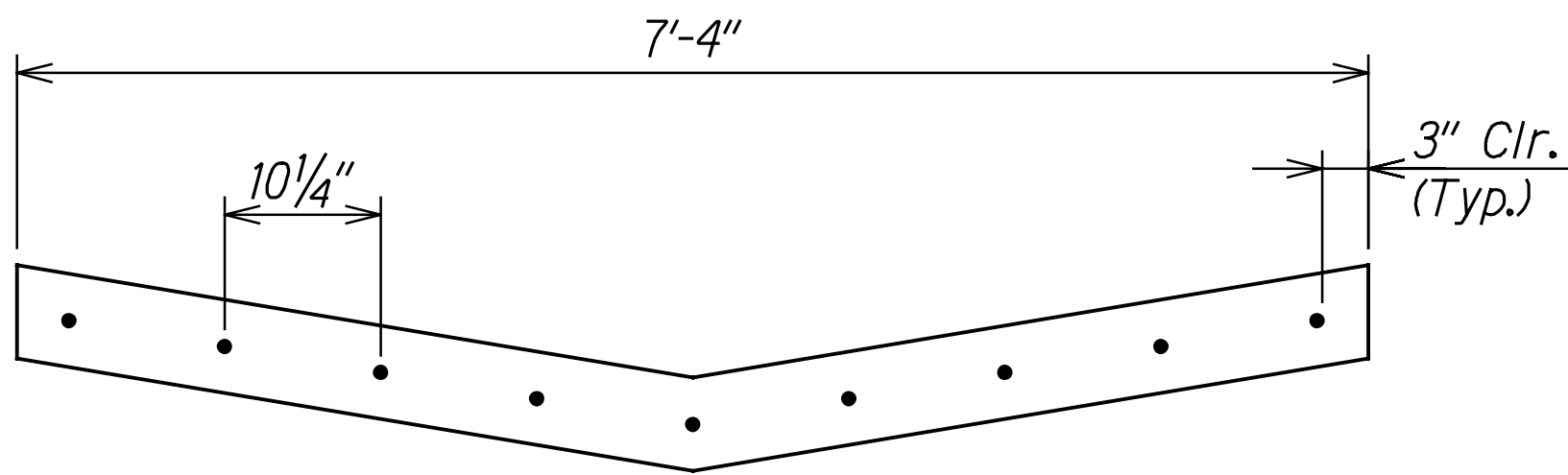

**GUTTER, TYPE 2 61616P DOWEL PLACEMENT AT JOINT LOCATIONS**  
Scale 1" = 1'-0"

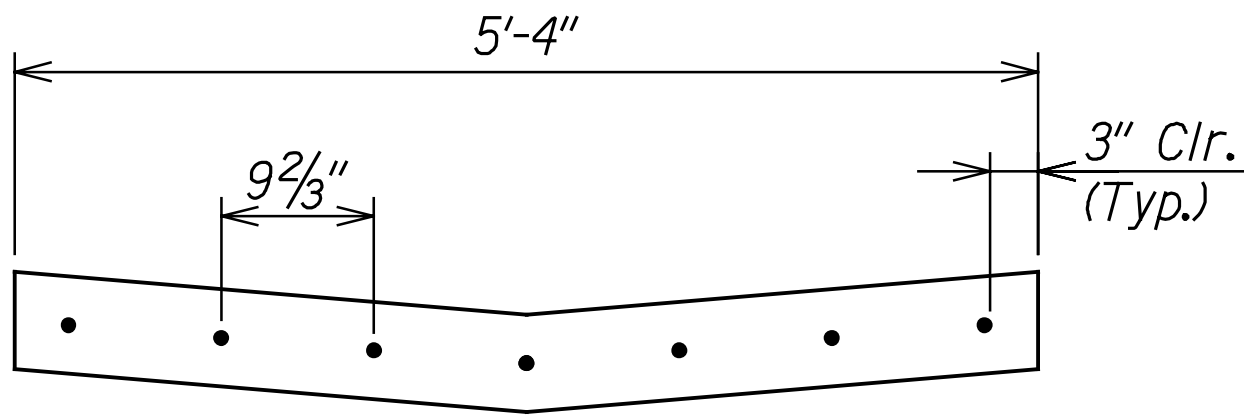

**GUTTER, TYPE 2 1211214P DOWEL PLACEMENT AT JOINT LOCATIONS**  
Scale 1" = 1'-0"

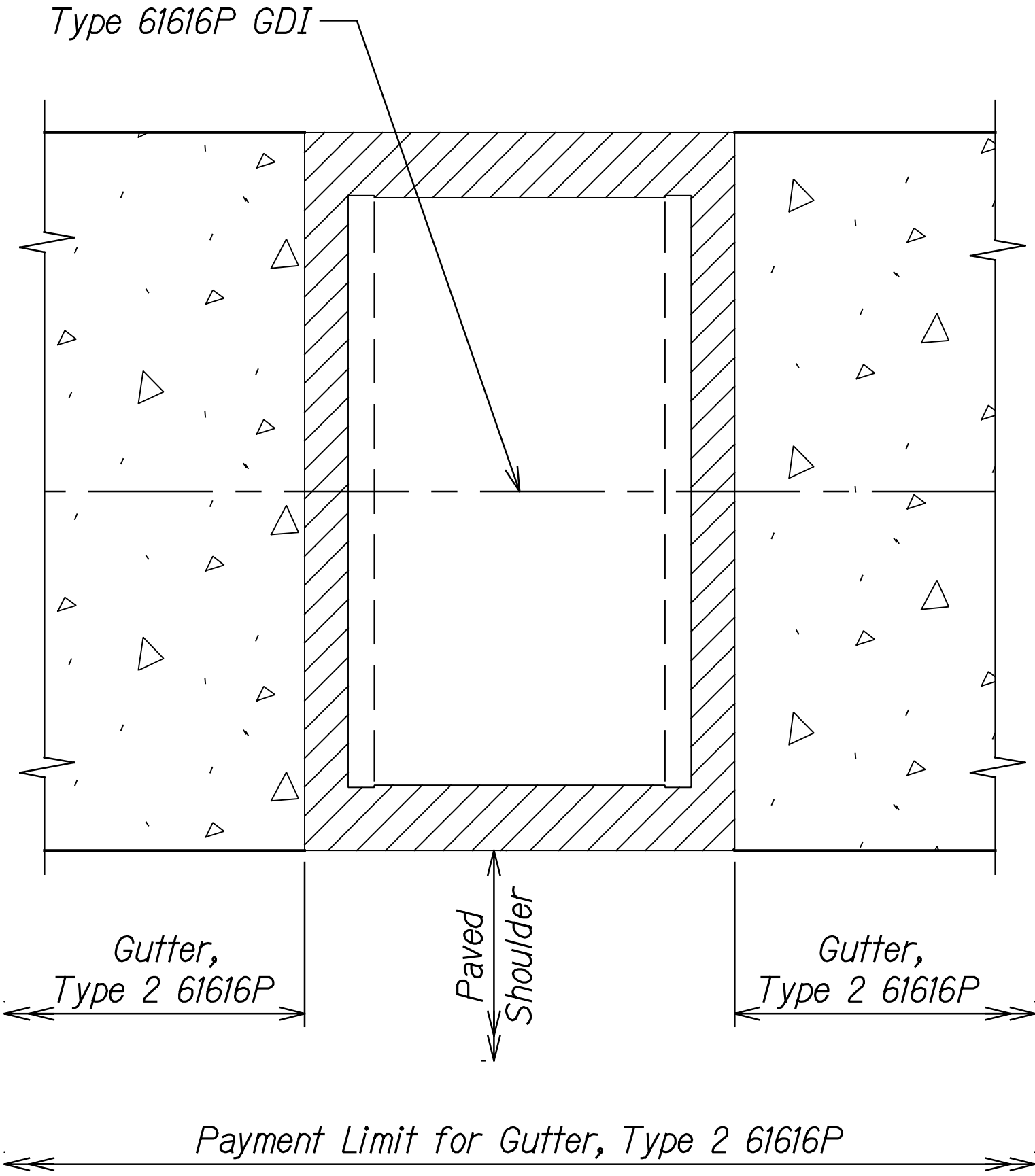

**GUTTER AT GDI DETAIL**  
Not to Scale

|                   |       |
|-------------------|-------|
| DATE              | _____ |
| SURVEY PLOTTED BY | _____ |
| DRAWN BY          | _____ |
| TRACED BY         | _____ |
| DESIGNED BY       | _____ |
| QUANTITIES BY     | _____ |
| CHECKED BY        | _____ |
| NO.               | _____ |

THIS WORK WAS PREPARED BY ME OR UNDER MY SUPERVISION.

*R. M. Urasaki* 04/30/22  
SIGNATURE EXPIRATION DATE OF THE LICENSE

STATE OF HAWAII  
DEPARTMENT OF TRANSPORTATION  
HIGHWAYS DIVISION

**MISCELLANEOUS DETAILS**

**KUAKINI HIGHWAY DRAINAGE IMPROVEMENTS**  
Vicinity of Mile Post 114  
Project No. 11B-01-20

Scale: None Date: Mar. 2021

