

FED. ROAD DIST. NO.	STATE	PROJ. NO.	FISCAL YEAR	SHEET NO.	TOTAL SHEETS
HAWAII	HAW.	11N-01-19M	2019	ADD. 10	26

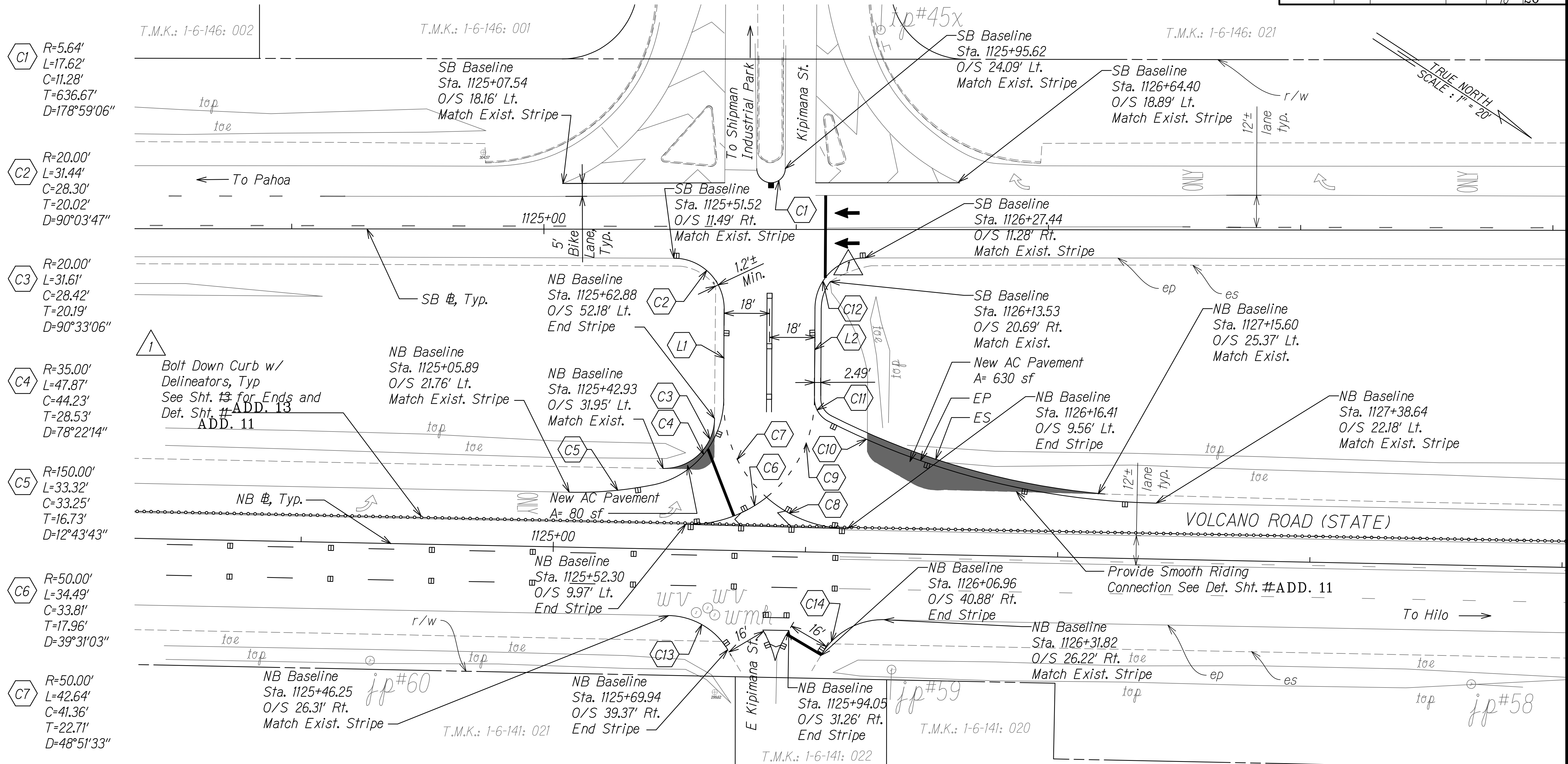

<div>C8</div> <div>R=50.00' L=35.08' C=34.37' T=18.30' D=40°11'58"</div>	<div>C10</div> <div>R=300.00' L=135.12' C=133.98' T=68.73' D=25°48'21"</div>	<div>C12</div> <div>R=20.00' L=31.31' C=28.21' T=19.90' D=89°42'00"</div>	<div>C14</div> <div>R=28.50' L=30.04' C=28.67' T=16.59' D=60°23'46"</div>
<div>C9</div> <div>R=50.00' L=44.89' C=43.40' T=24.08' D=51°26'17"</div>	<div>C11</div> <div>R=10.00' L=11.06' C=10.50' T=6.17' D=63°22'09"</div>	<div>C13</div> <div>R=28.00' L=28.23' C=27.05' T=15.45' D=57°46'14"</div>	<div>L1</div> <div>237°08'34" 35.61'</div> <div>L2</div> <div>237°08'34" 35.86'</div>

NOTES:

- For AC pavement section, see det. Sht #.
- For striping legend and callouts, see Shts 12 to 13.

ADD. 12 ADD. 13

GRAPHIC SCALE:

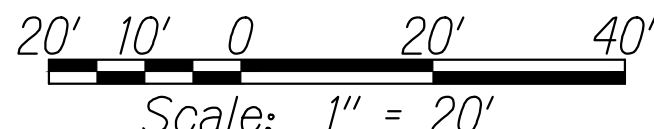

ADD. 11

**LEGEND FOR AS-BUILT POSTINGS**

~~~~~	Squiggly line for as-built deletion
<del>100.00</del>	Double line for as-built deletion
Roadway	Text for as-built posting

**ROBYN R. MCKINNEY**  
LICENSED PROFESSIONAL ENGINEER  
NO. 13480-C  
HAWAII, USA

THIS WORK WAS PREPARED BY ME OR UNDER MY SUPERVISION AND CONSTRUCTION OF THIS PROJECT WILL BE UNDER MY OBSERVATION.

*Robyn McKinney*  
SIGNATURE

APRIL 30, 2020  
EXPIRATION DATE OF THE LICENSE

6/10/19	1 Add Delineators
DATE	REVISION

STATE OF HAWAII  
DEPARTMENT OF TRANSPORTATION  
HIGHWAYS DIVISION

**INTERSECTION PLAN**

**VOLCANO ROAD TEMPORARY SIGNAL INSTALLATION**

**At Kipimana Street**

**Project No. 11N-01-19M**

Scale: 1" = 20' Date: April, 2019

SHEET No. 1 OF 1 SHEETS

"AS-BUILT"

ADD. 10

C:\M PROJECTS\2015\_160.004\_HDOT KIPIMANA TRAFFIC SIGNAL\G DWG\CIVIL\00 CAD DWGS\AS-BUILT DWGS\01 CE DWG\10 INTERSECTION PLAN.DWG 2/26/2021 11:34 AM KSAW