

FED. ROAD DIST. NO.	STATE	FED. AID PROJECT	FISCAL YEAR	SHEET NO.	TOTAL SHEETS
HAWAII	HAW.	STP-011-1(026)	2012	21	21

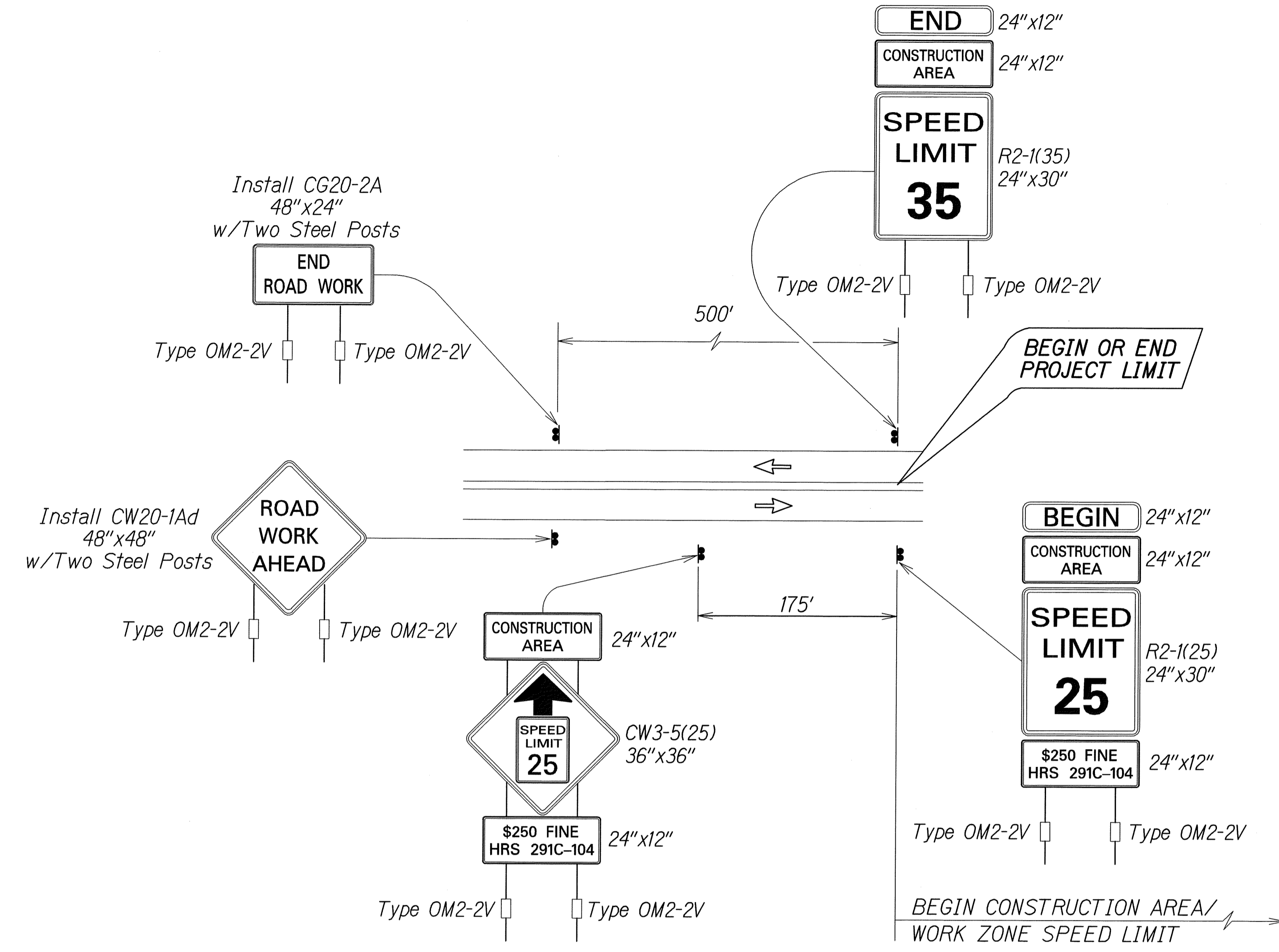

**Work Zone Notes:**

1. This Work Zone Sign Plan is intended for use on long-term stationary work zones/construction phases (3 days or more). Contractor shall use Traffic Control Plans shown in Section 645 of the Special Provisions.
2. All existing regulatory speed limit signs within the work zone/project limits shall be temporarily replaced with applicable signs. Work zone speed limit sign assemblies and supplemental signs shall be temporarily installed within work zone/project limits.
3. Work Zone sign assemblies shall be installed on both the approaching and trailing ends of each work zone as shown on this plan.
4. Each construction warning sign and work zone speed limit assembly shall have a minimum of two (2) Type OM2-2V. Installation of each Type OM2-2V shall be considered incidental to Item No. 645.1000 - Traffic Control.
5. Upon the completion of all physical work or as directed by the Engineer, all construction signs and work zone speed limit assemblies shall be removed. All speed limit signs and posts that were existing at the start of the project within the work zone/project limits shall be replaced.
6. Placement of Work Zone signs shall not obstruct the path of pedestrians and bicyclists.
7. Maintenance and removal of work zone speed limit sign assemblies shall be considered incidental to Item No. 645.1000 - Traffic Control.

**TYPICAL DETAIL FOR WORK ZONE SIGNS  
ON TWO LANE LOW SPEED HIGHWAY**

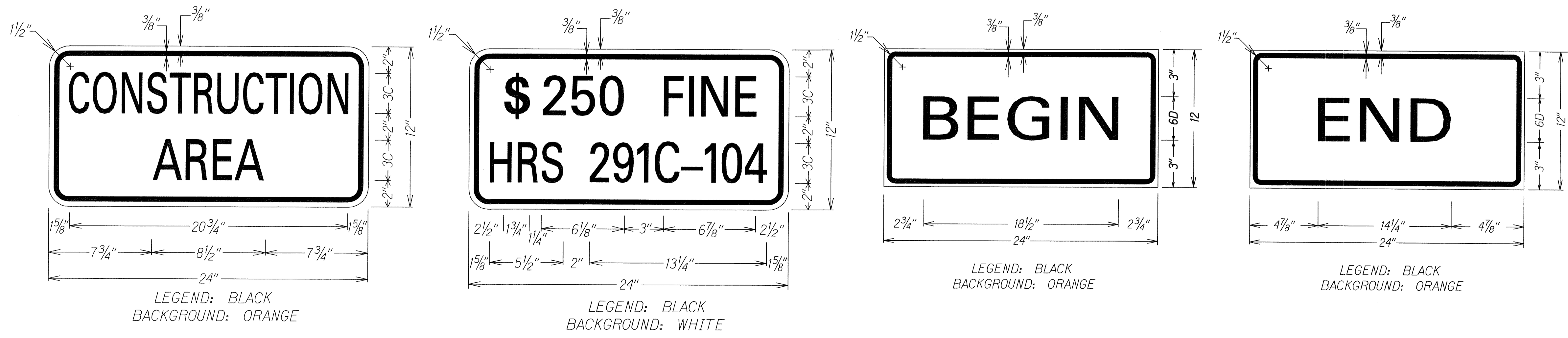

DATE	.....
SURVEY PLOTTED BY	.....
DRAWN BY	.....
NOTED BY	.....
DESIGNED BY	.....
CHECKED BY	.....

STATE OF HAWAII  
DEPARTMENT OF TRANSPORTATION  
HIGHWAYS DIVISION

**LOW SPEED UNDIVIDED HIGHWAY  
WORK ZONE SIGNING PLAN, NOTES & DETAILS**

MAMALAHOA HIGHWAY  
Pavement Preventive Maintenance  
Kaohoe to Kaapuna  
Federal Aid Project No. STP-011-1(026)  
Date: March, 2012

SHEET No. 1 OF 1 SHEETS