

FED. ROAD DIST. NO.	STATE	FED. AID PROJ. NO.	FISCAL YEAR	SHEET NO.	TOTAL SHEETS
HAWAII	HAW.	HS-STP-011-2(38)	2010	90	141

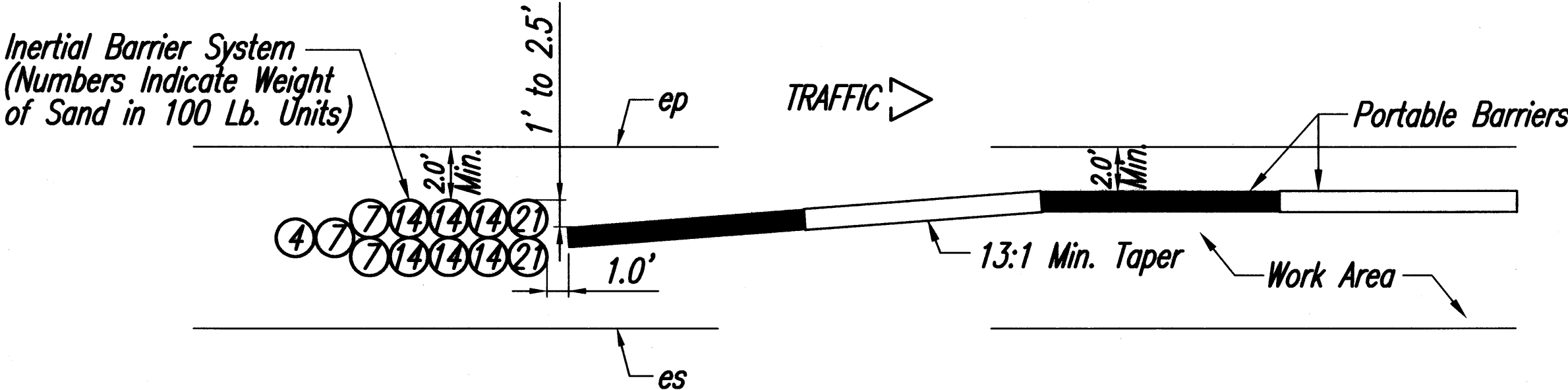

- Notes:
- Portable barriers shall be required whenever guardrails have been removed and will not be reinstalled at the end of the work day.
 - Portable barriers shall be either portable concrete barriers or portable water filled barriers. Installation of portable water filled barriers shall conform to manufacturer's recommendations as dictated by design speed and field conditions.
 - Providing, transporting, placing, maintaining, relocating and removal of portable barriers shall be considered incidental to the various items of work. See Section 645, WORK ZONE TRAFFIC CONTROL DEVICES of the Standard Specifications.
 - Ends of portable barriers shall be protected with inertial barriers as shown above.
 - Payment for furnishing and relocations of temporary inertial barriers for the different construction phases shall be incidental to the various items of work. See Section 645, WORK ZONE TRAFFIC CONTROL DEVICES of the Standard Specifications.

TYPICAL DETAIL - SHOULDER WORK AREA
Not to Scale

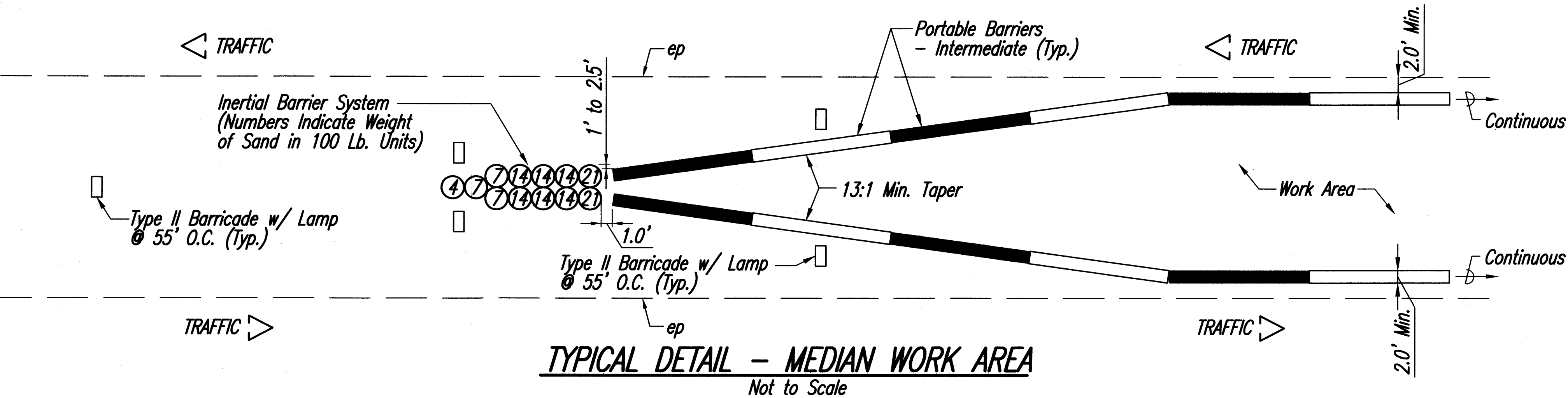
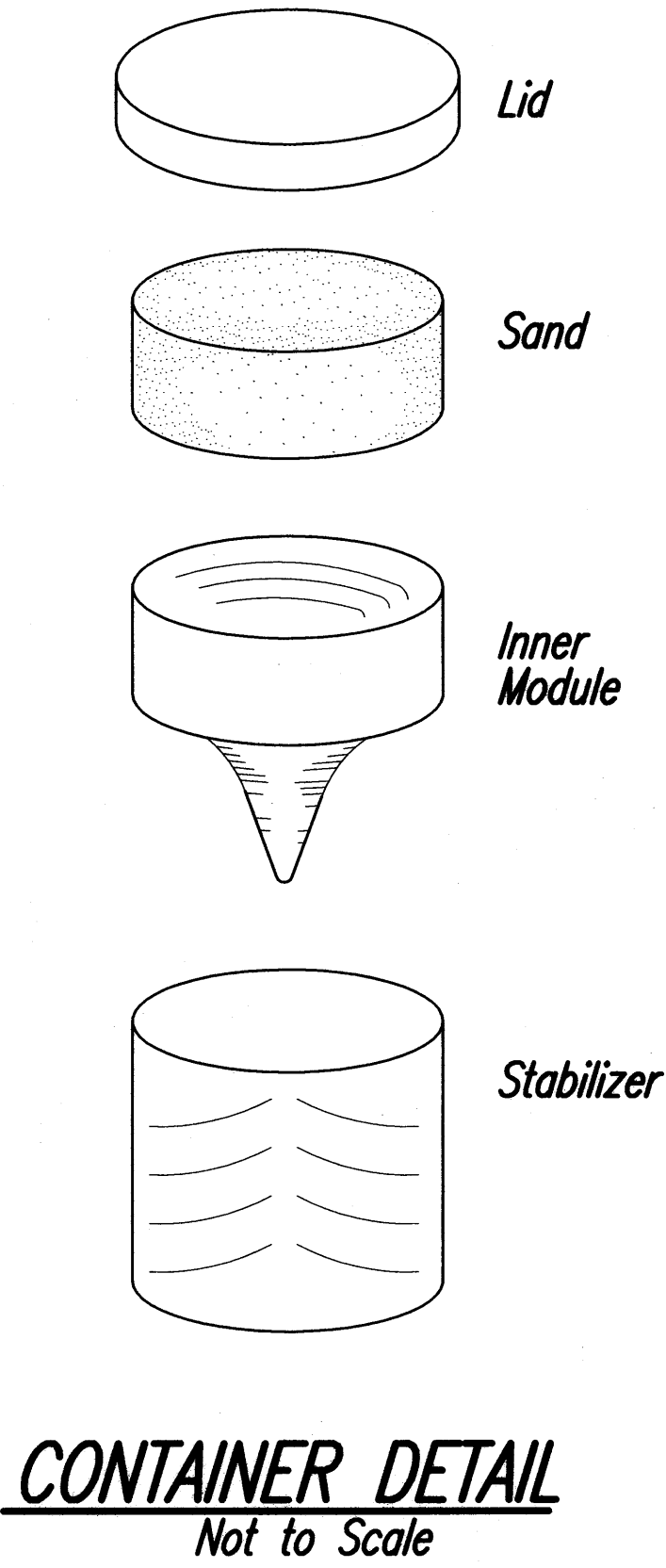

CONTAINER DETAIL
Not to Scale

ORIGINAL PLAN	DATE
DESIGNED BY	
TRACED BY	
NOTE BOOK	
QUANTITIES BY	
CHECKED BY	
No.	

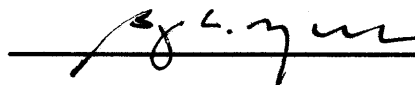
 LICENSE EXPIRES 4/30/12
 THIS WORK WAS PREPARED BY
 ME OR UNDER MY SUPERVISION

STATE OF HAWAII
DEPARTMENT OF TRANSPORTATION
HIGHWAYS DIVISION

INERTIAL BARRIER DETAILS

Volcano Road Intersection and Drainage Improvements

Federal-Aid Project No. HS-STP-011-2(38)

Scale: Not to Scale Date: November 2010

SHEET No. 12 OF 12 SHEETS