

FED. ROAD DIST. NO.	STATE	FED. AID PROJ. NO.	FISCAL YEAR	SHEET NO.	TOTAL SHEETS
HAWAII	HAW.	11JK-0E-844	1984	11	14



CW20-1a 48" x 48"



CW20-2d 48" x 48"



CW20-3b 48" x 48"



CW20-4d 48" x 48"



CW20-5d(L) 48" x 48"

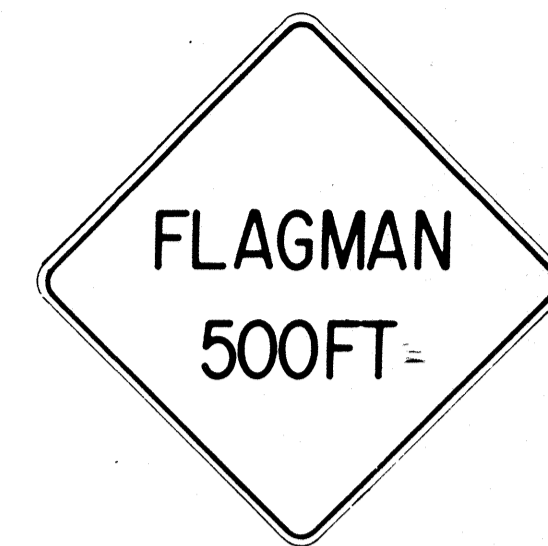

CW20-7c 48" x 48"



CW21-1 30" x 30"



CW21-2 30" x 30"



CW21-3 36" x 36"



CW21-4 36" x 36"



CW21-5 30" x 30"

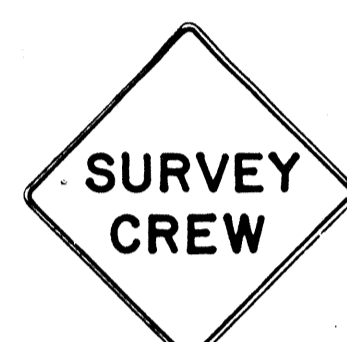

CW21-6 30" x 30"



CW22-1b 48" x 48"

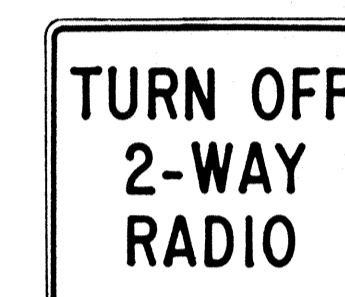

CW22-2 42" x 36"

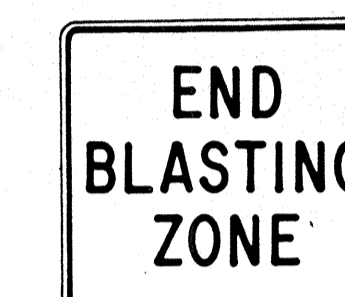

CW22-3 42" x 36"



CG20-1(5) 60" x 36"

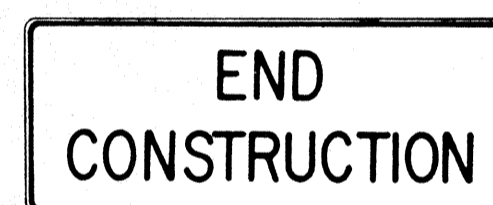

CG20-2 60" x 24"



CM4-9(R) 30" x 24"



CM4-10(R) 48" x 18"

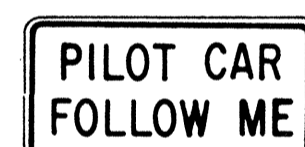

CG20-4 36" x 18"



CW23-1 36" x 36"

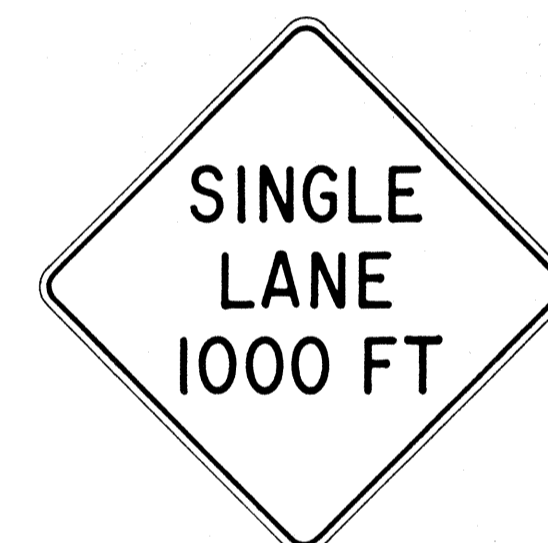

CW23-2b 48" x 48"



CW23-3(R) 48" x 48"

**GENERAL NOTES**

- Sign details shall conform to the FHWA publications "Manual on Uniform Traffic Control Devices for Streets and Highways," 1971, and "Standard Highway Signs," 1972, and as amended.
- All construction signs shall be reflectorized.
- All construction signs shall have 3/8" bolt holes drilled at appropriate locations.
- Numerals in ( ) indicates numerals to be inserted for sign message. (R) or (L) indicates right or left.
- For "CW" series signs, suffixes a,b,c and d are as follows:  
a-1500 FT, b-1000 FT, c-500 FT and d-AHEAD.

APPROVAL RECOMMENDED:  
*Erich Tanaka* 3/21/12  
 TRAFFIC ENGINEER DATE

APPROVED:  
*Muhammad Saleh* 3/23/12  
 ASSISTANT CHIEF, ENGINEERING DATE

NO.	REVISION	APPROVED BY	DATE
1	Supersedes Sht. DT 104 Approved 12-30-69	HT.	3/23/12
2	Revised General Note 1	HT.	10/10/14
3	Revised General Note 2	HT.	9-16-75
4	Revised General Note 2 and sign CG20-1(5)	HT.	9-14-76

STATE OF HAWAII  
 DEPARTMENT OF TRANSPORTATION  
 HIGHWAYS DIVISION

**STANDARD DETAILS**  
**CONSTRUCTION SIGNS**

NOT TO SCALE

ORIGINAL PLAN	DATE
DESIGNED BY	
QUANTITIES BY	
CHECKED BY	
No.	

FED. ROAD DIST. NO.	STATE	FED. AID PROJ. NO.	FISCAL YEAR	SHEET NO.	TOTAL SHEETS
HAWAII	HAW.	HJK-01-84M	1984	12	14

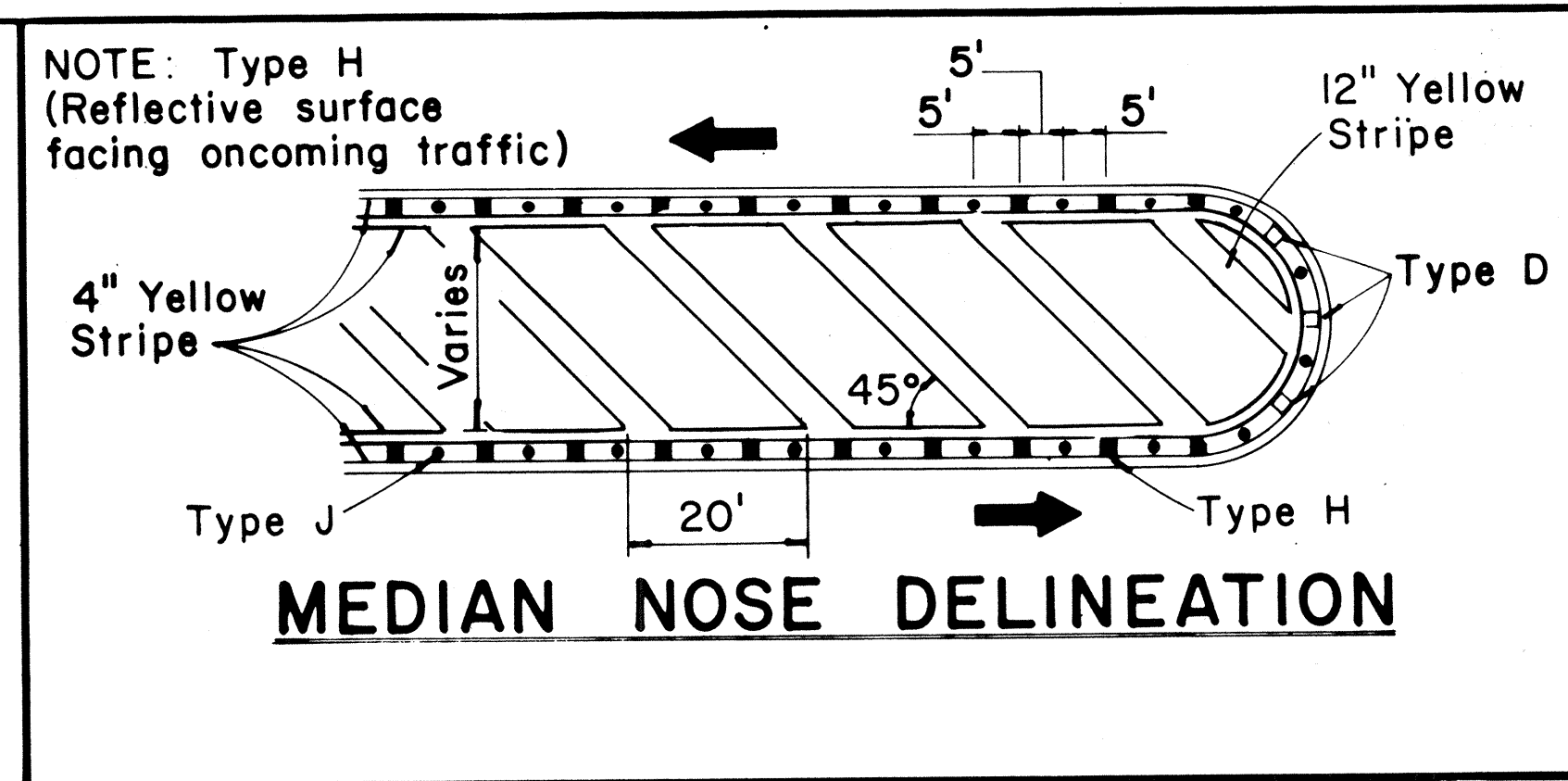
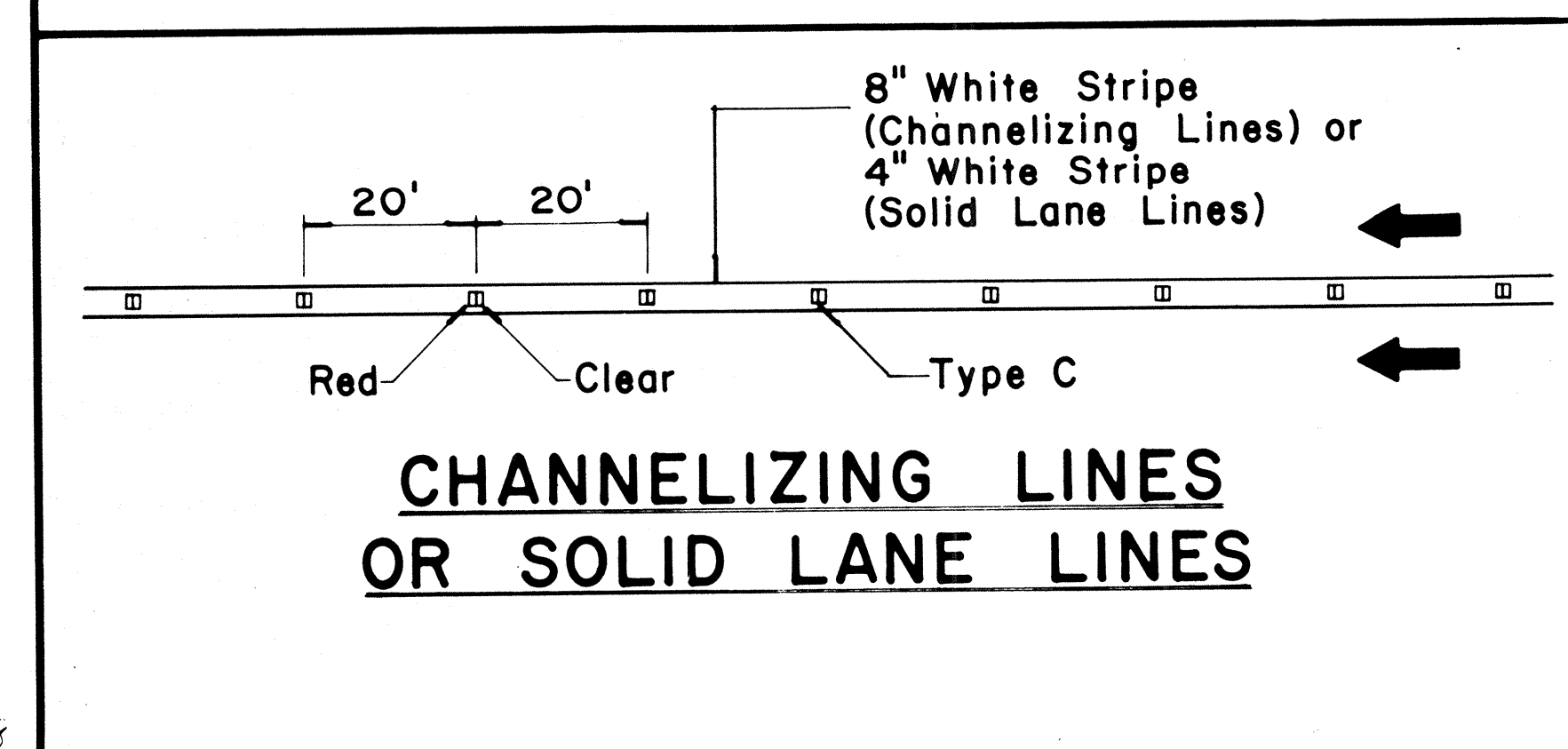
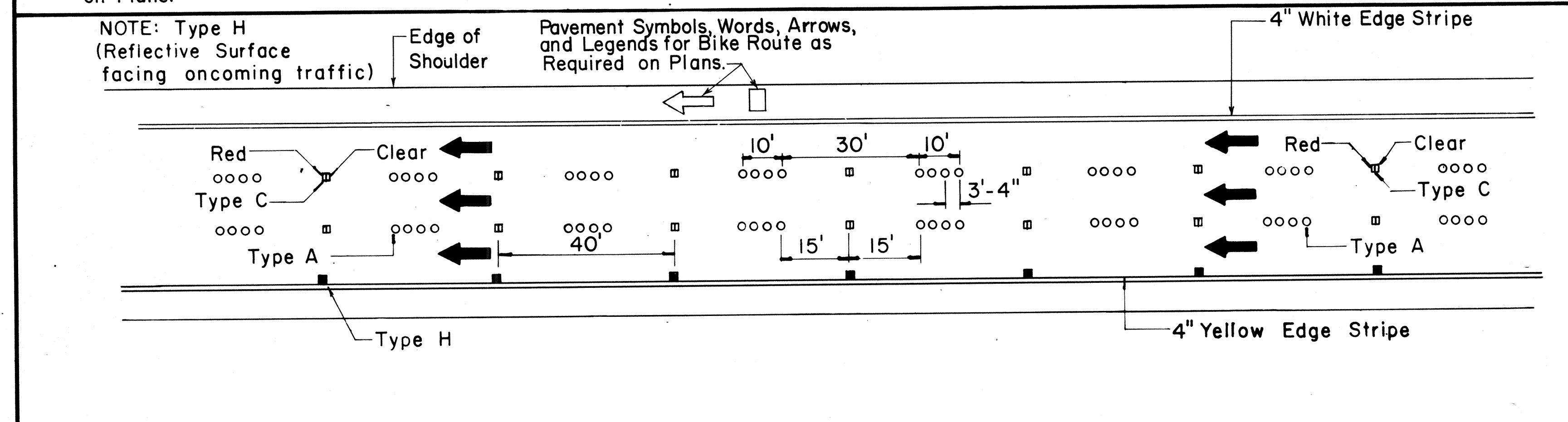
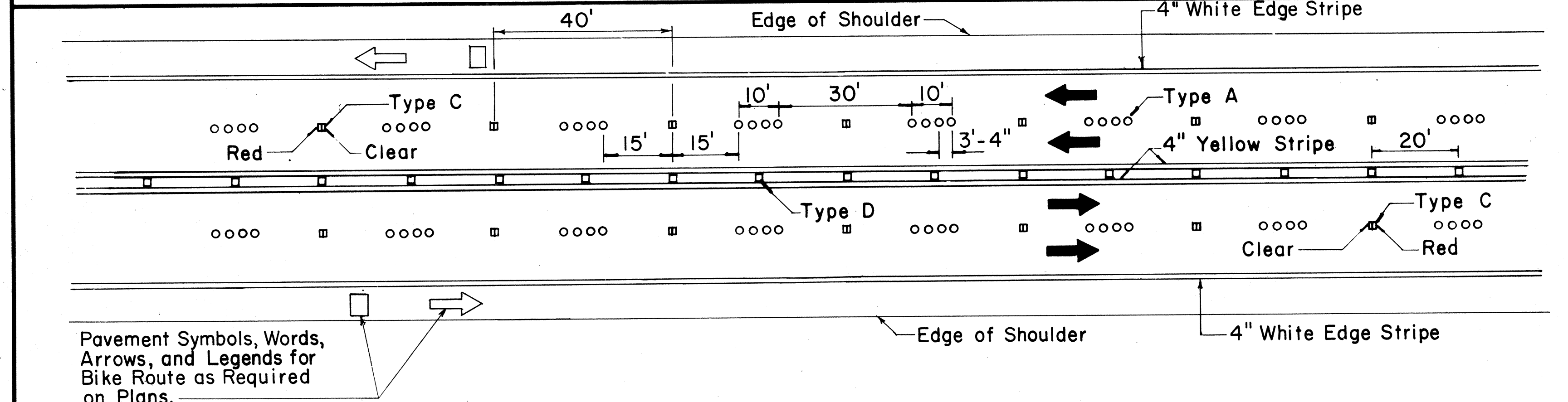
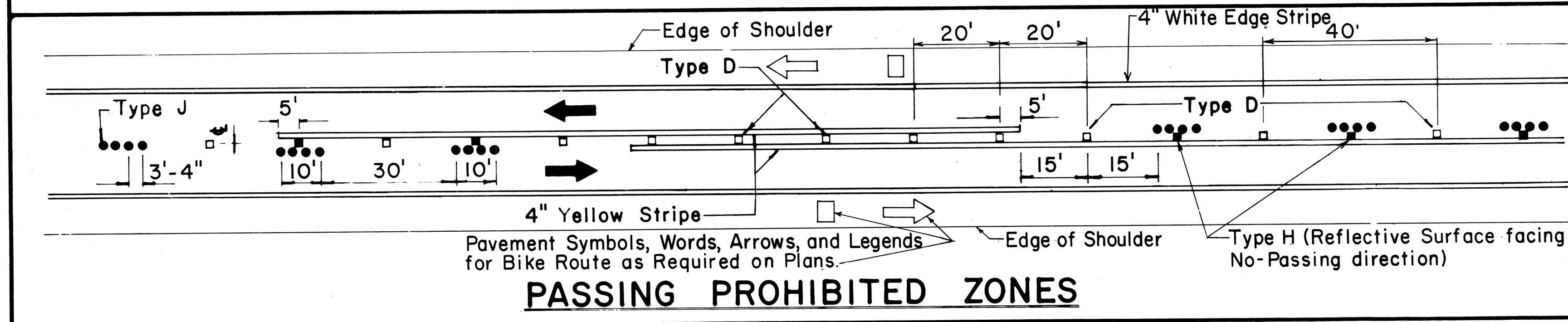
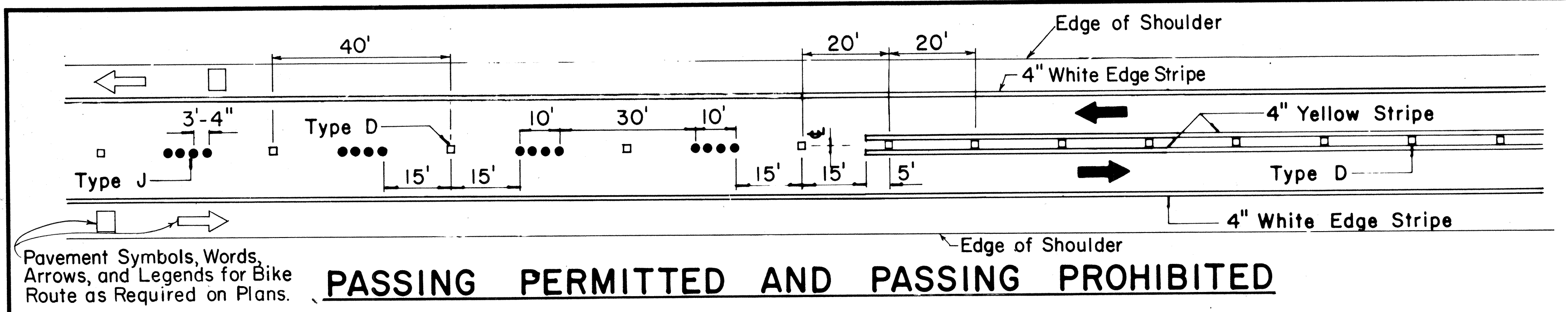

TWO - LANE

MULTI - LANE

DIVIDED HIGHWAY AND FREEWAY

MISCELLANEOUS

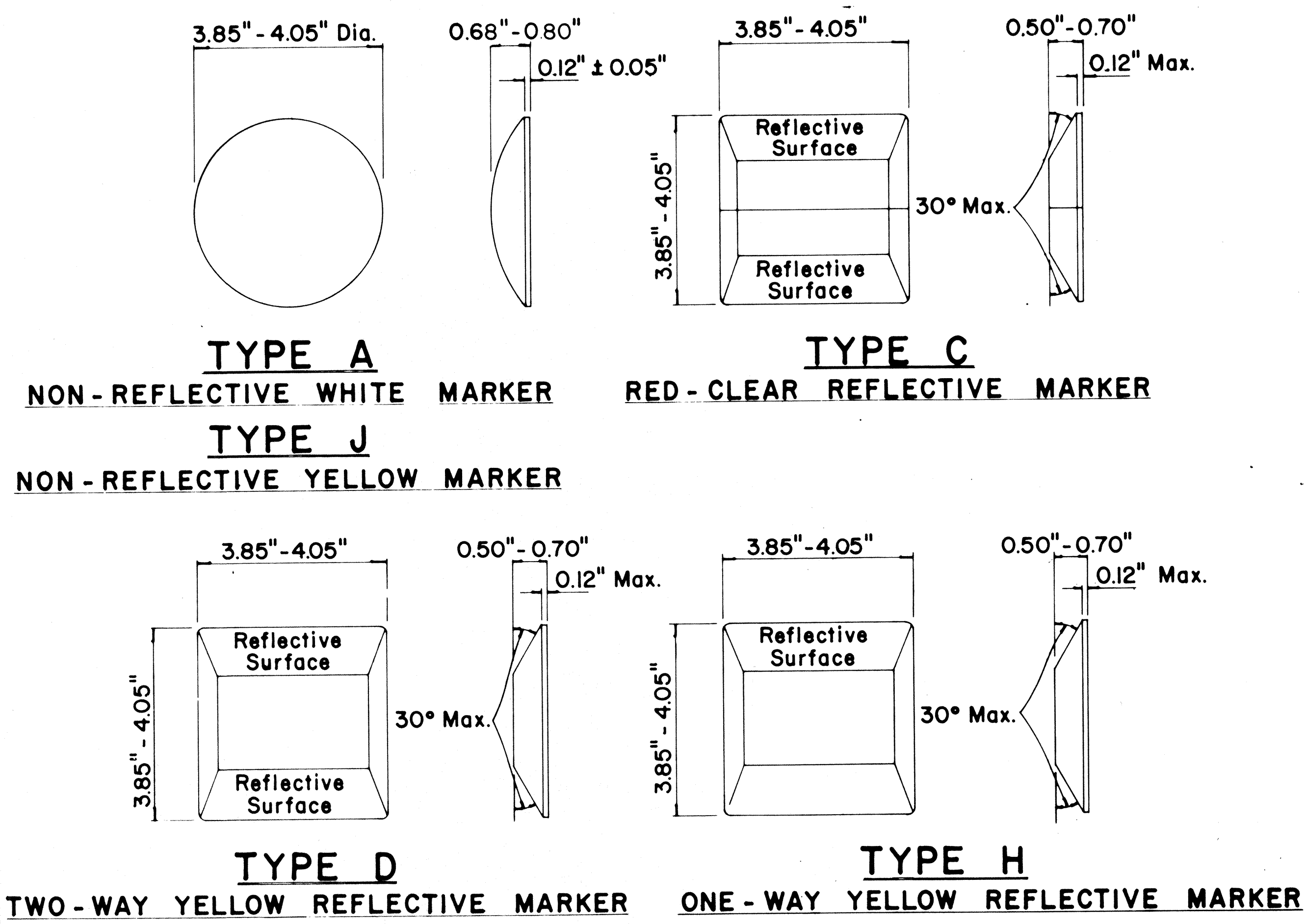

**GENERAL NOTES**

1. Pavement marking and striping shall conform to the latest "Manual on Uniform Traffic Control Devices for Streets and Highways," and as amended.
2. Layout and installation of pavement marking and striping shall be done by the Contractor. The Contractor shall check the layouts with the Engineer prior to performing work.
3. Edge lines shall not be continued through intersections and shall not be broken for driveways unless otherwise shown or directed.

**LEGEND**

- Type A
- Type C
- Type D
- Type H
- Type J

APPROVAL RECOMMENDED:  
*Erich Tanaka* 7/21/78  
 TRAFFIC ENGINEER DATE

APPROVED:  
*Herbert J. Zelenko* 1/24/78  
 ASSISTANT CHIEF, ENGINEERING DATE

No.	REVISION	APPROVED BY	DATE
1	Supersedes DT 300 approved 11/18/71.	H.T.	1/24/78
2	Delete Type A Markers from Bike Route Delineation.	H.T.	10/15/79
3	Added General Note 3. Revised left edge stripe.	H.T.	9-28-83

STATE OF HAWAII  
 DEPARTMENT OF TRANSPORTATION  
 HIGHWAYS DIVISION

**STANDARD DETAILS**  
**RAISED PAVEMENT MARKERS**  
**AND STRIPING**

Not to Scale July 1978

SHEET No. OF SHEETS DT 300

SURVEY PLOTTED BY  
 DRAWN BY  
 CHECKED BY  
 ORIGINAL PLAN  
 NOTE BOOK  
 No.



FED. ROAD DIST. NO.	STATE	FED. AID PROJ. NO.	FISCAL YEAR	SHEET NO.	TOTAL SHEETS
HAWAII	HAW.	HTK-01-8AM	1984	13	14

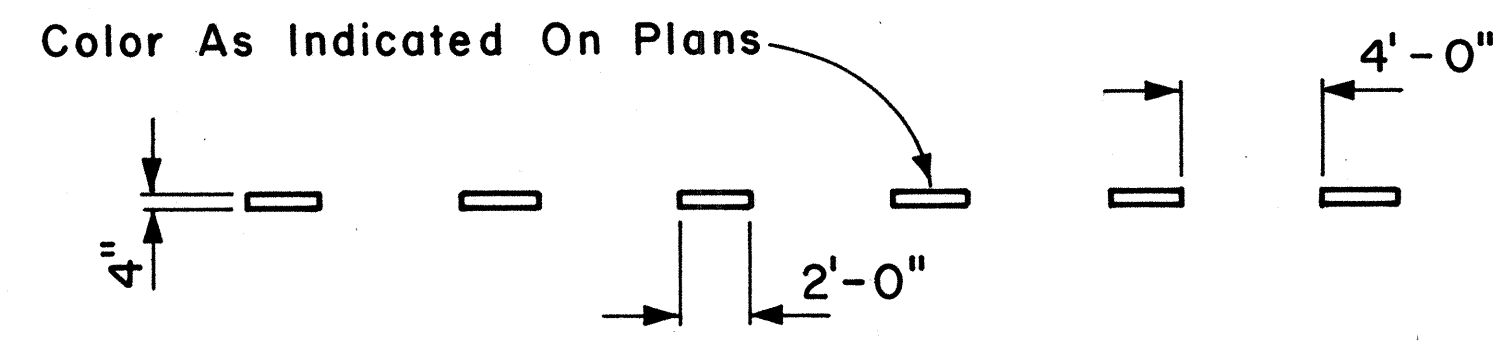

**4" GUIDE LINE**

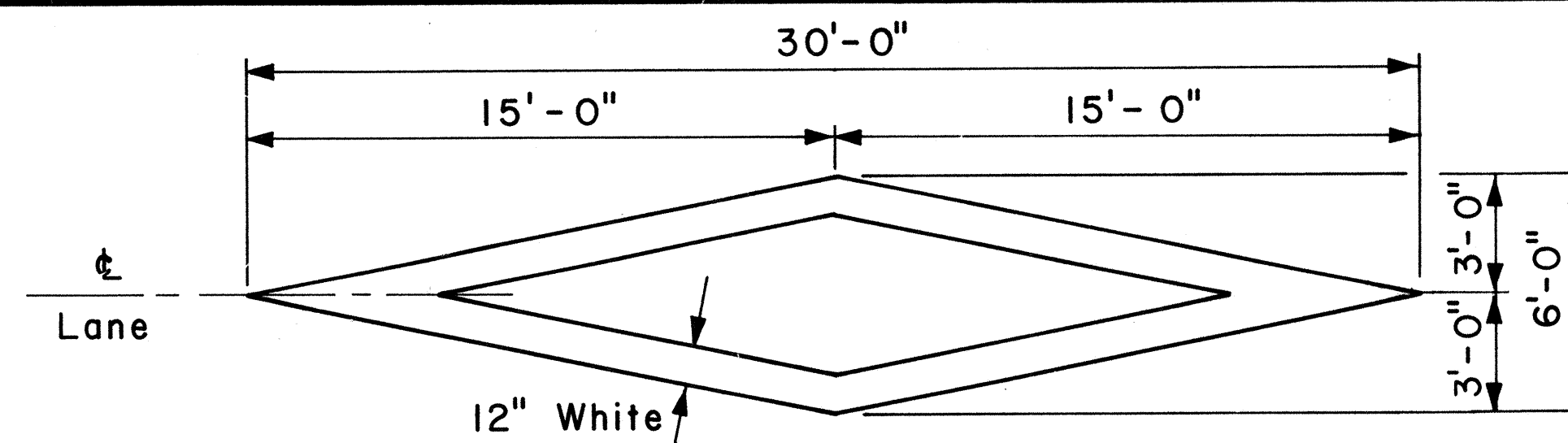

**PAVEMENT DIAMOND**

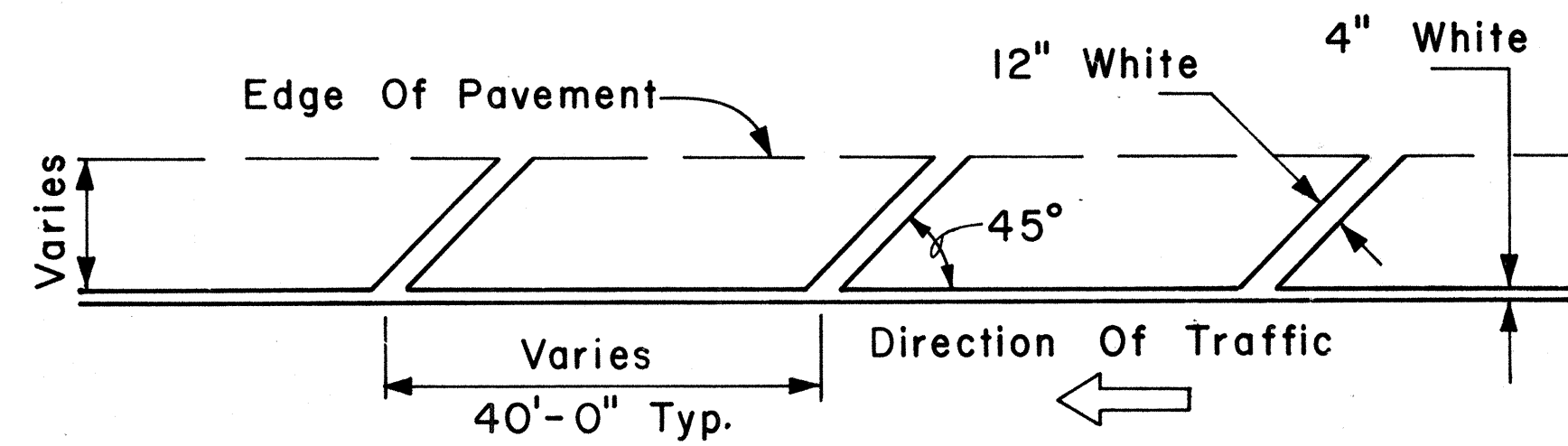

**TRANSVERSE RIGHT SHOULDER MARKING**

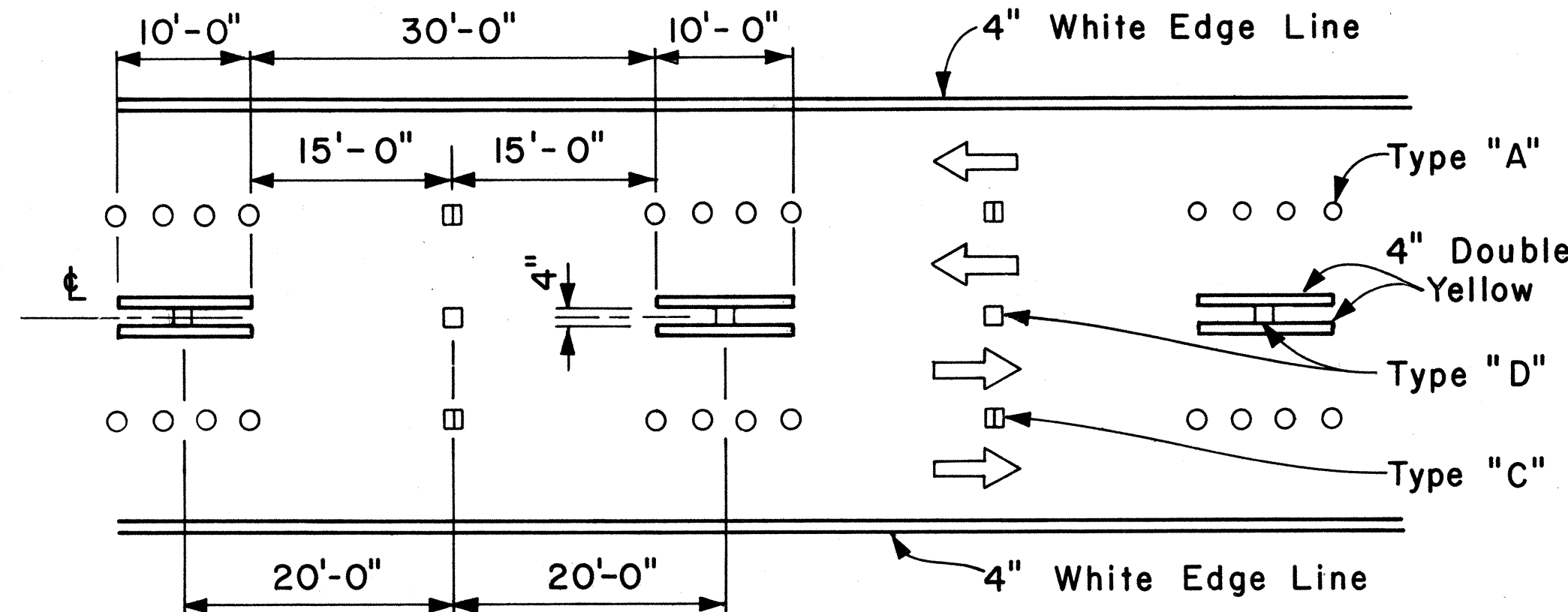

NOTE: Traffic Cone Usage Required.

**MULTI-LANE REVERSIBLE LANES**

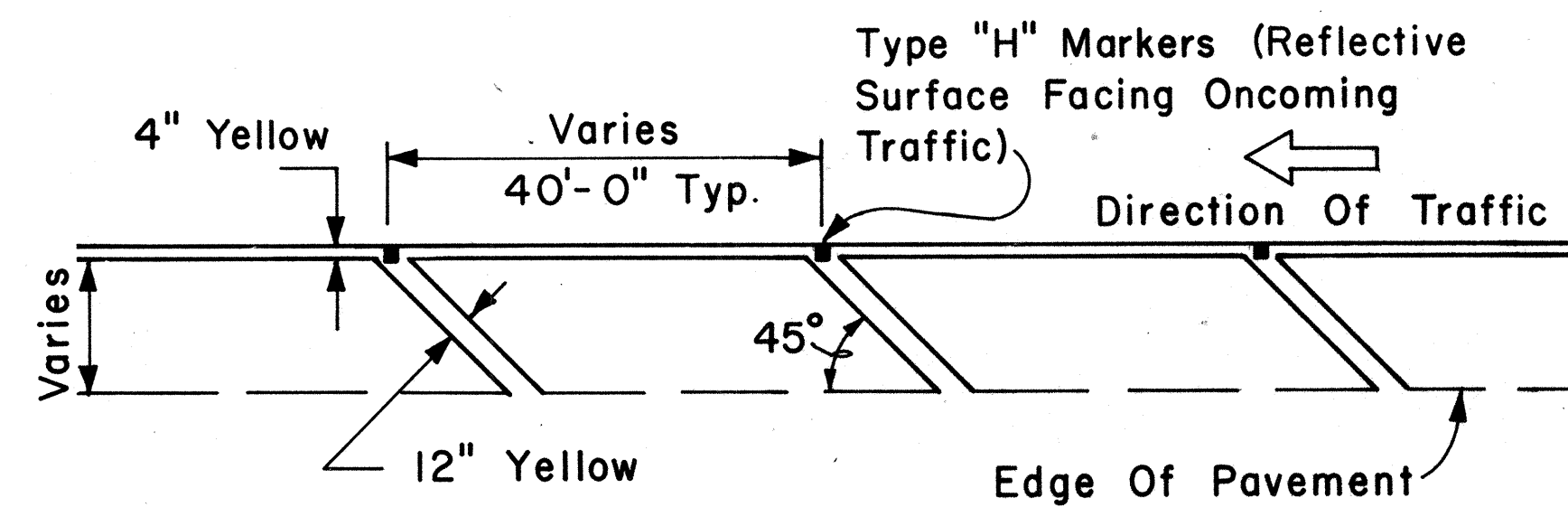

**TRANSVERSE LEFT SHOULDER MARKING**

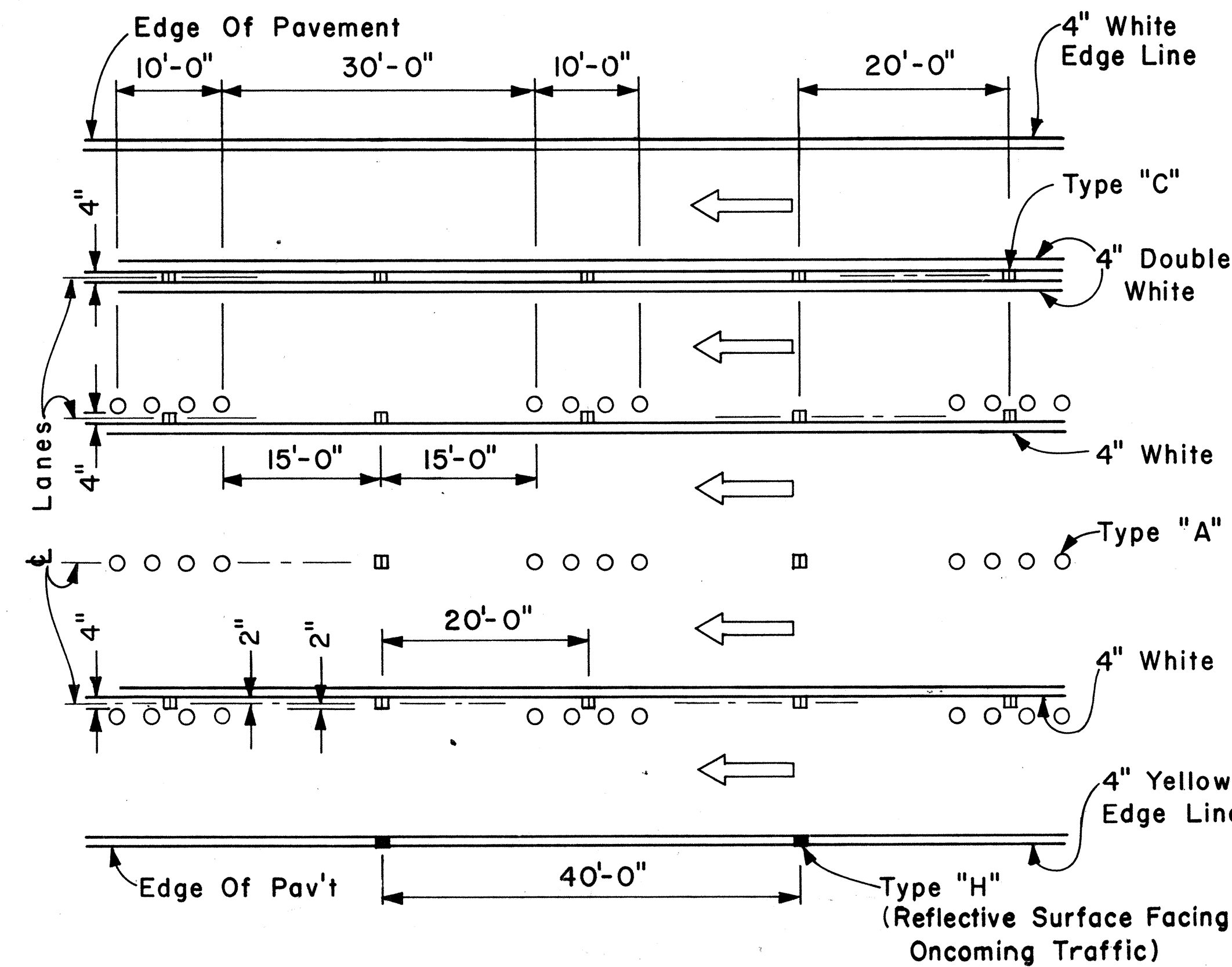

**MULTI-LANE LANE CHANGE RESTRICTION ZONES**

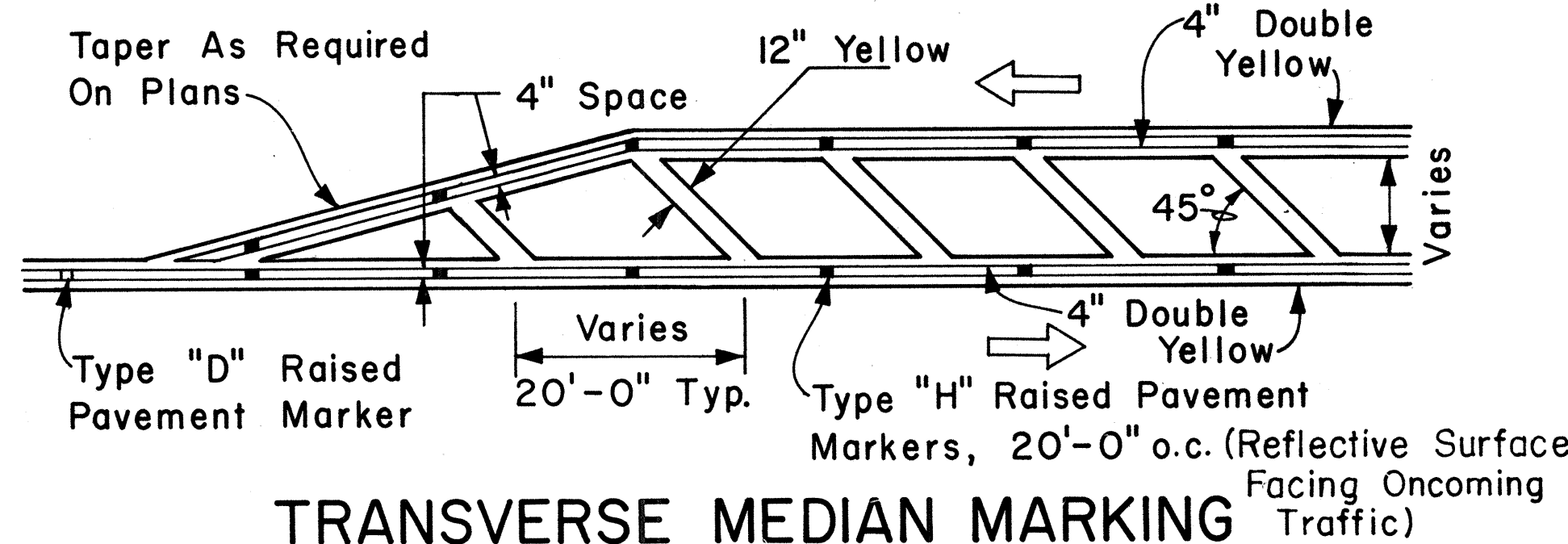

**TRANSVERSE MEDIAN MARKING**

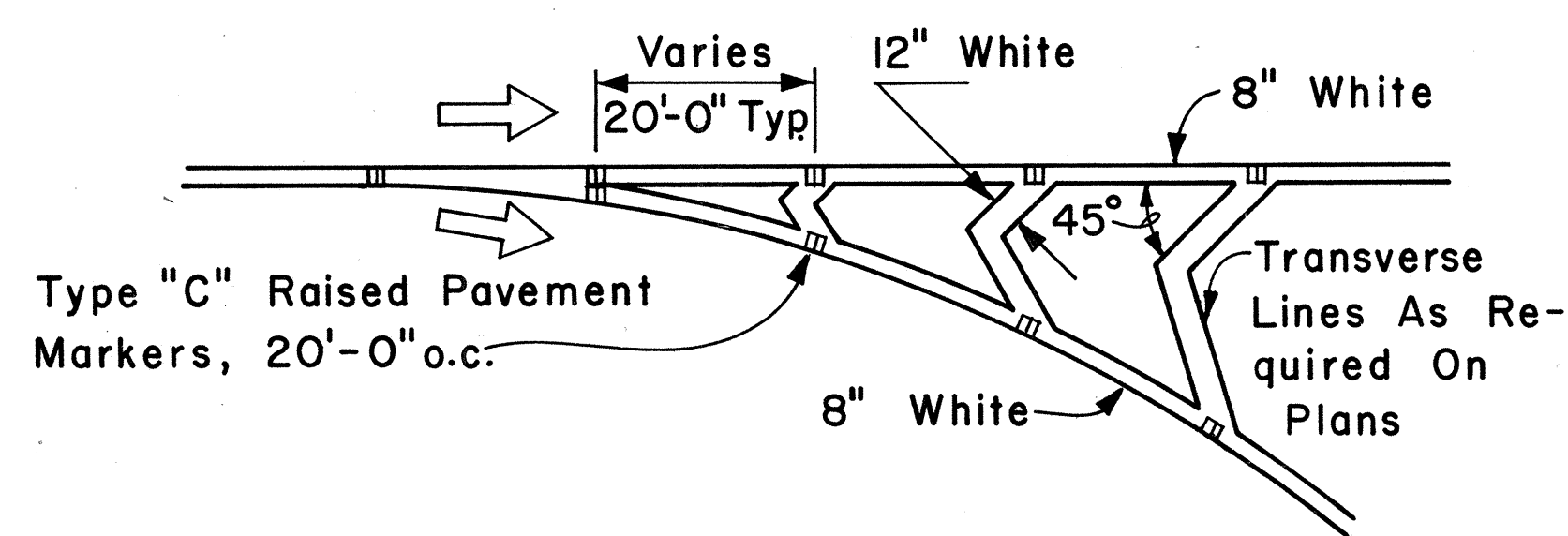

**CHANNELIZING ISLAND**

**GENERAL NOTES:**

1. Pavement marking and striping shall conform to the latest edition of the "Manual on Uniform Traffic Control Devices for Streets and Highways," by the FHWA, and as amended.
2. Layout of pavement markings and striping shall be done by the Contractor. The Contractor shall check layout of markings and striping with the Engineer prior to performing work.
3. For additional pavement marking details, see sheet DT 300.

ORIGINAL PLAN	DATE
DRAWN BY	
DESIGNED BY	
QUANTITIES BY	
CHECKED BY	
No.	

APPROVAL RECOMMENDED:  
*Etsuki Tanaka* 5/2/78  
 TRAFFIC ENGINEER DATE

APPROVED:  
*Harbor 2. Zaisaku* 5/3/78  
 ASSISTANT CHIEF, ENGINEERING DATE

NO.	REVISION	APPROVED BY	DATE

STATE OF HAWAII  
 DEPARTMENT OF TRANSPORTATION  
 LAND TRANSPORTATION FACILITIES DIVISION  
**STANDARD DETAILS**  
 MISCELLANEOUS  
 PAVEMENT MARKINGS  
 Scale: Not to Scale Date: April, 1978  
 SHEET No. OF SHEETS DT 302

FED. ROAD DIST. NO.	STATE	FED. AID PROJ. NO.	FISCAL YEAR	SHEET NO.	TOTAL SHEETS
HAWAII	HAW.	117K-01-844	1984	14	14

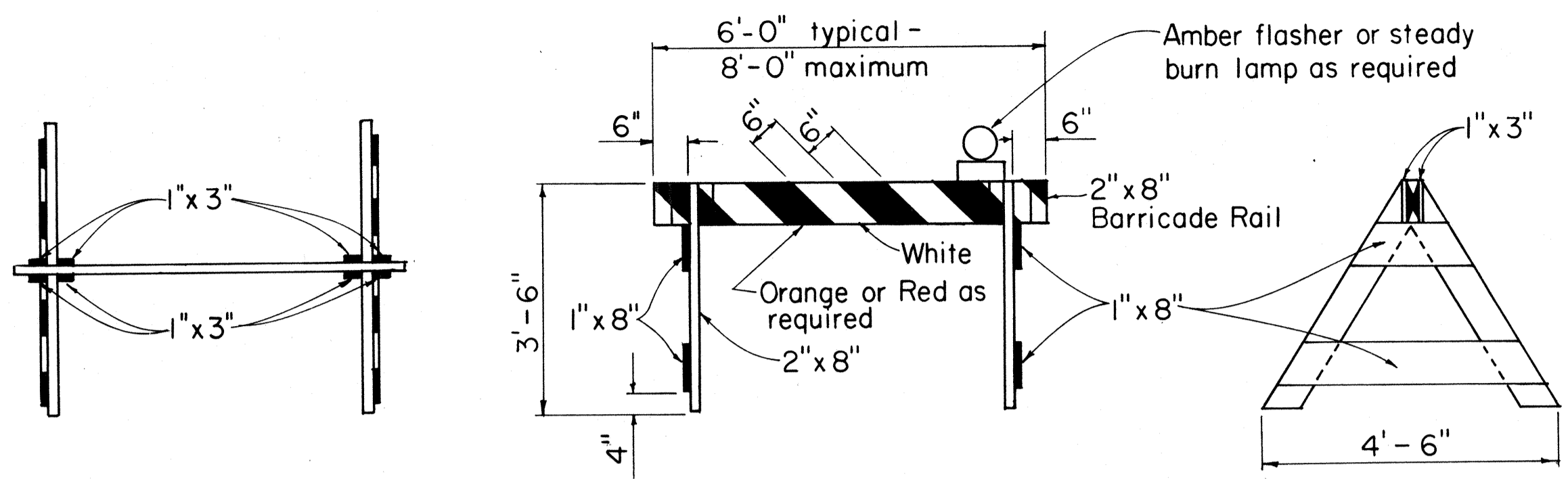

PLAN VIEW

FRONT VIEW

END VIEW

TYPE I BARRICADE  
Scale: 1/2" = 1'-0"

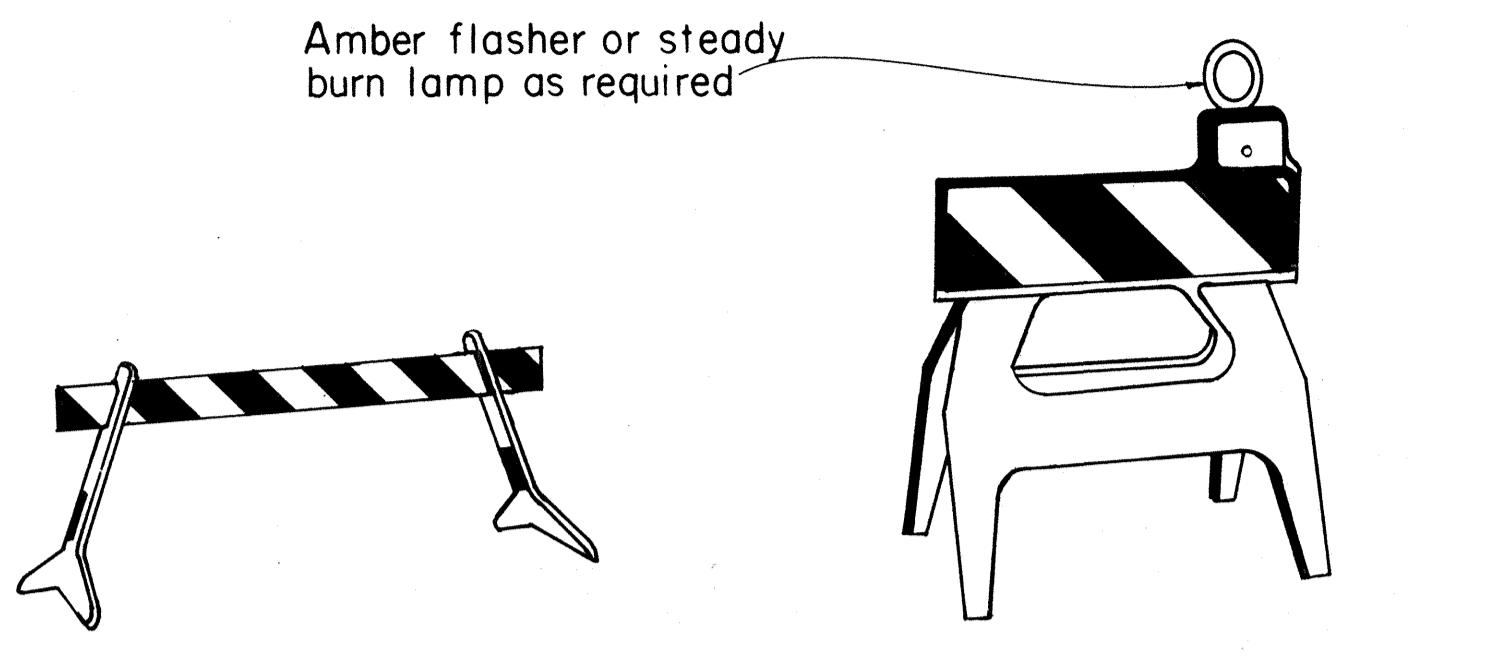

TYPE I

TYPE I

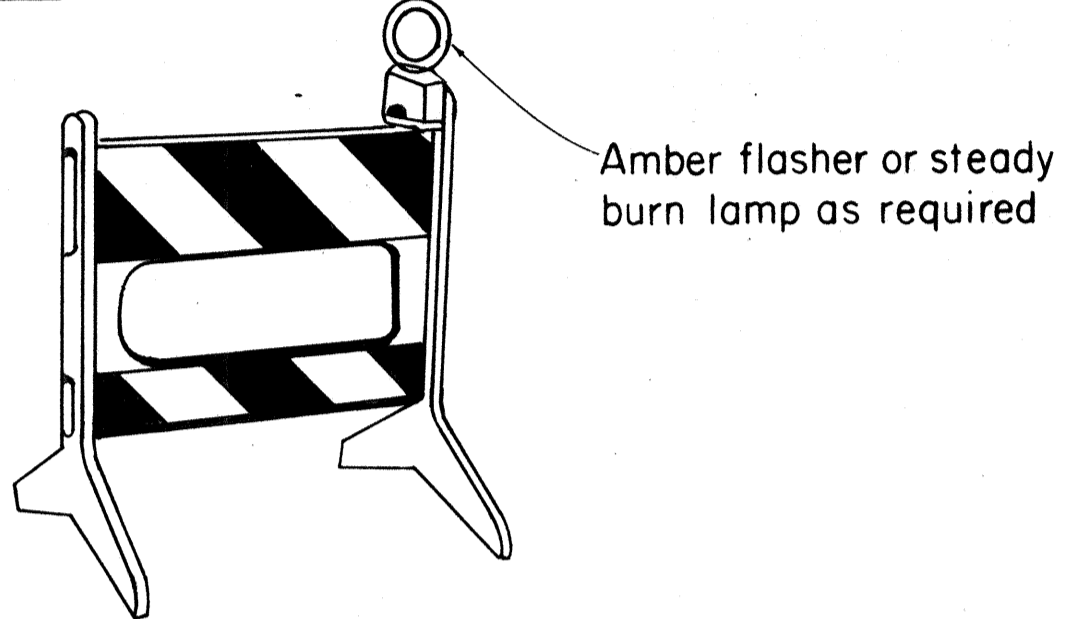

TYPE II

GENERAL NOTES

1. The front and back faces of each barricade rail shall be reflectorized with stripes sloping downward toward the same side (traveled way) of each barricade.
2. Contractor may submit alternate barricade designs for approval.
3. Sandbags or other approved weights shall not be placed on top of any striped rail.
4. The Contractor is directed to Section 626.

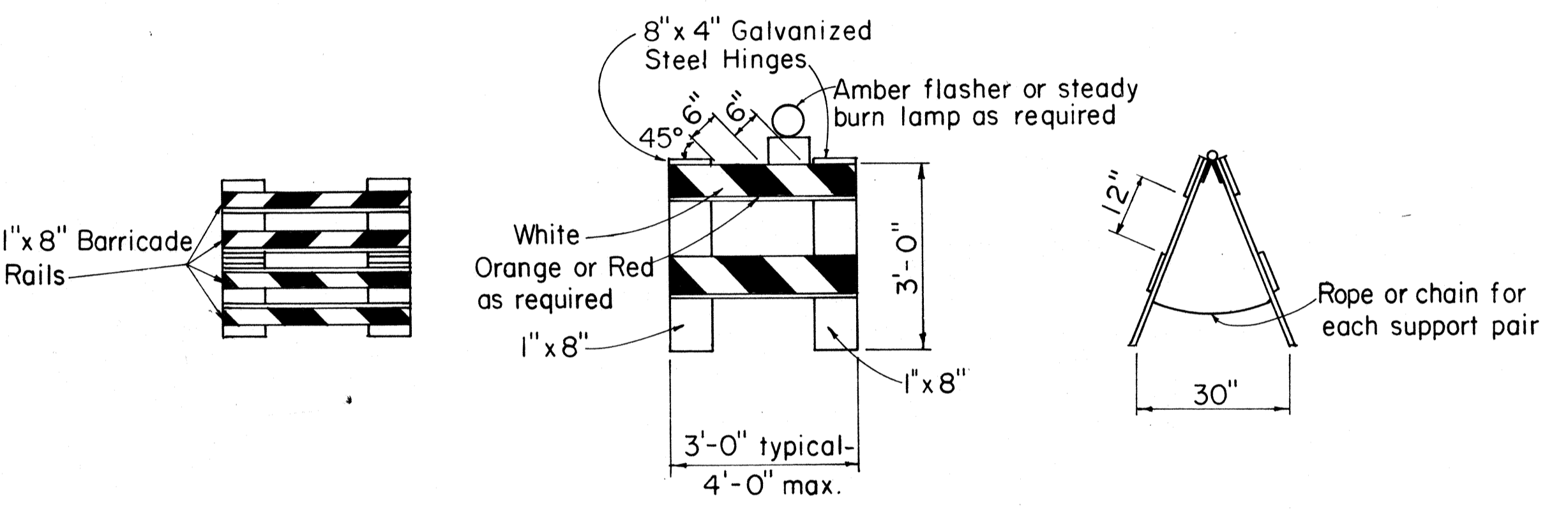

PLAN VIEW

FRONT VIEW

END VIEW

TYPE II BARRICADE  
Scale: 1/2" = 1'-0"

PLASTIC MOLDED BARRICADE OPTIONS\*

Not to Scale

\*Shop Drawings must be submitted for approval.

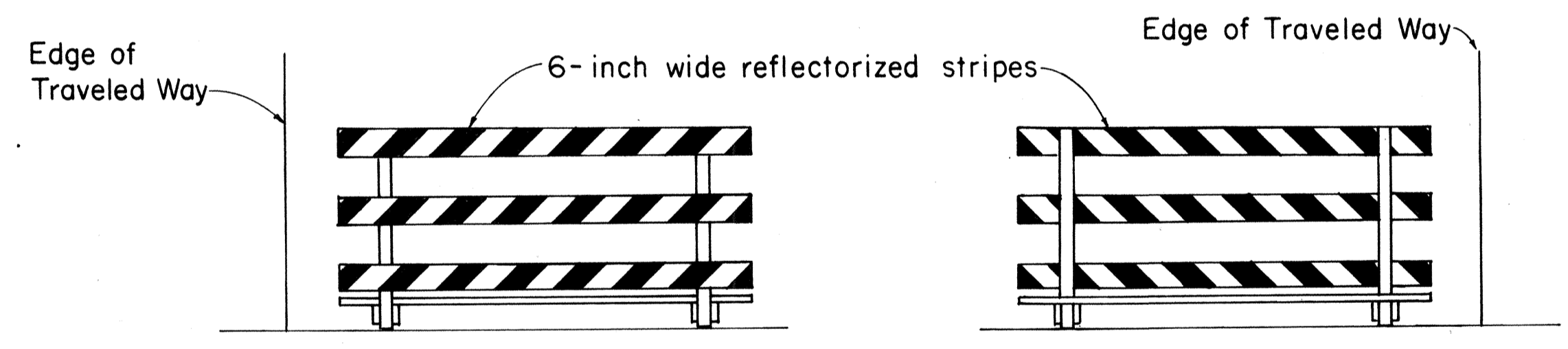

FRONT FACE

BACK FACE

TYPICAL BARRICADE STRIPING DETAILS\*\*

Not to Scale

\*\* Similar for Types I & II

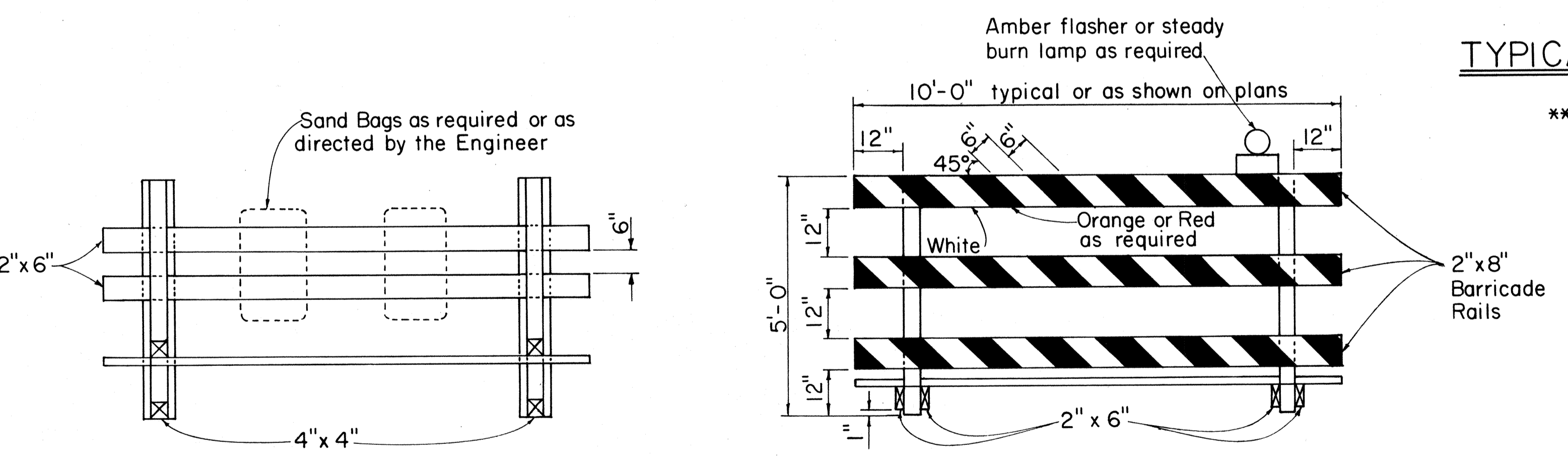

PLAN VIEW

FRONT VIEW

END VIEW

TYPE III BARRICADE  
Scale: 1/2" = 1'-0"

NO.	REVISION	APPROVED BY	DATE
1	Supersedes DT 800 Approved 12/30/69	H.T.	10/23/81

APPROVAL RECOMMENDED:  
*Etsuki Tanaka* 10/21/81  
 TRAFFIC ENGINEER DATE

APPROVED:  
*Robert S. Satoishi* 10/23/81  
 ASSISTANT CHIEF, ENGINEERING DATE

STATE OF HAWAII  
 DEPARTMENT OF TRANSPORTATION  
 HIGHWAYS DIVISION

STANDARD DETAILS  
BARRICADES

SCALE: As Shown  
 SHEET No. OF SHEETS DT 800

ORIGINAL PLAN	DATE
SURVEY PLOTTED BY	
DRAWN BY	
TRACED BY	
DESIGNED BY	
QUANTITIES BY	
CHECKED BY	
No.	