

FED. ROAD DIST. NO.	STATE	PROJ. NO.	FISCAL YEAR	SHEET NO.	TOTAL SHEETS
HAWAII	HAW.	HWY-H-01-86	1987	C.O. 67	115

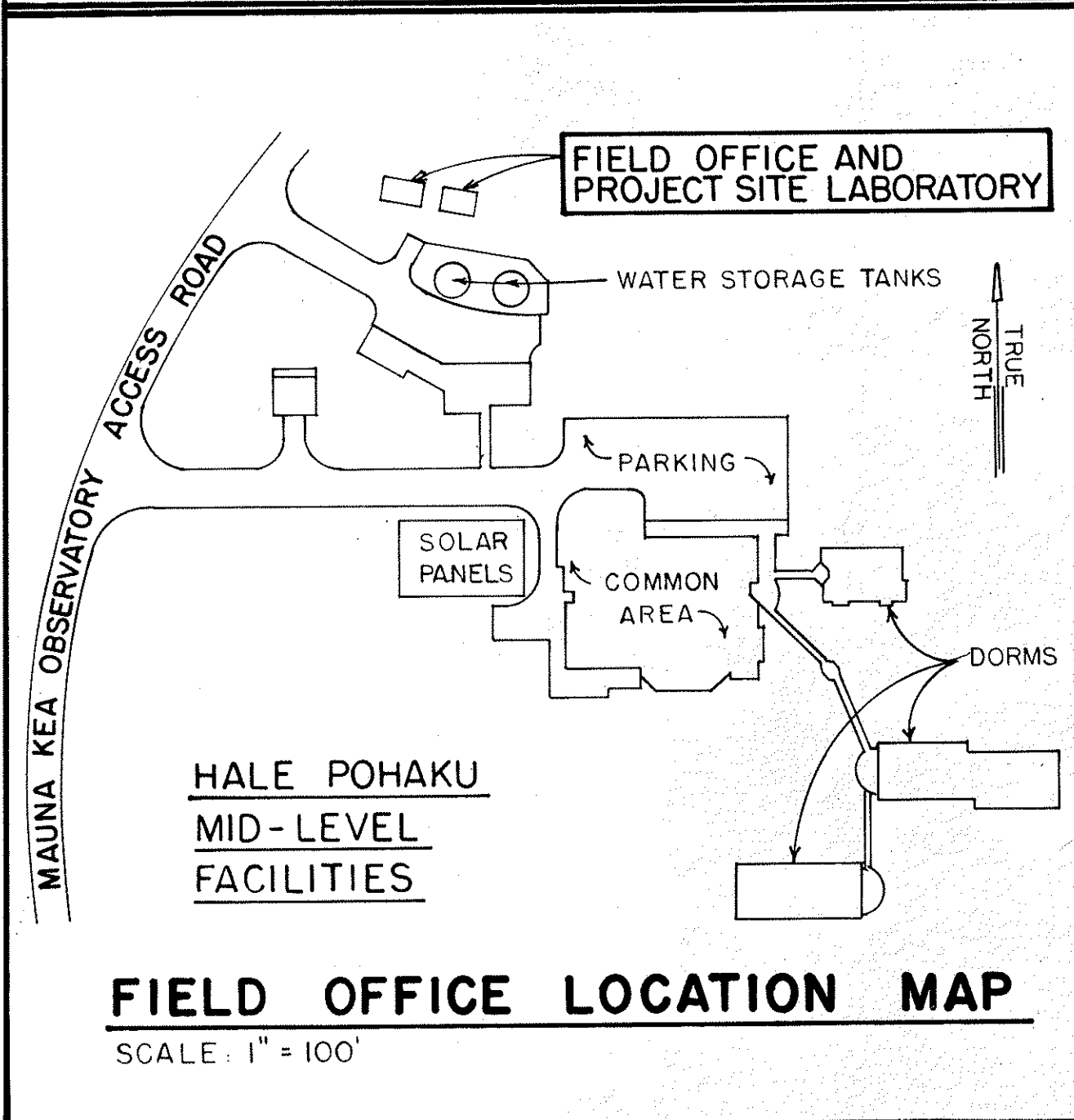
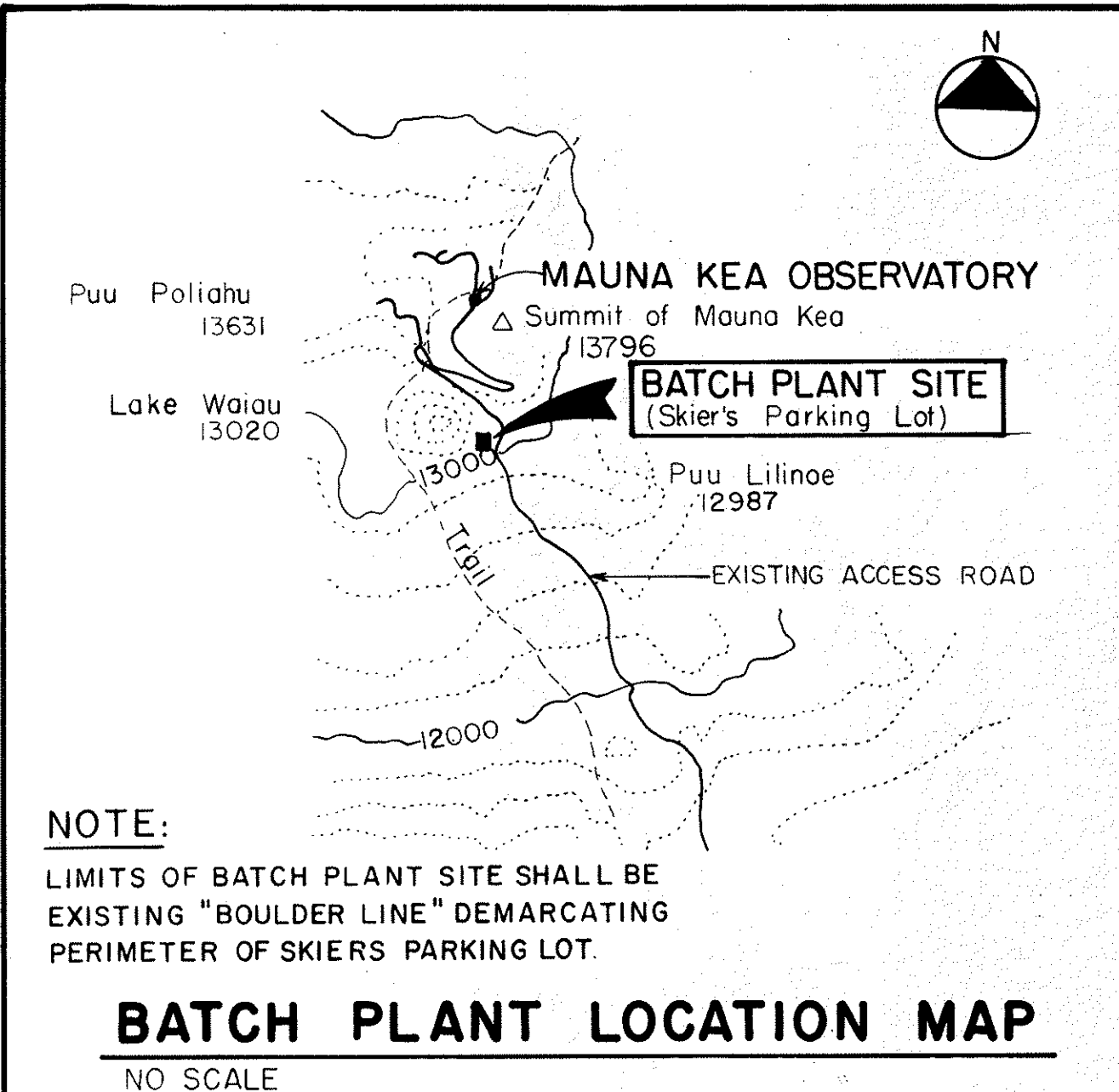

3/21/88

DATE

ROAD IMPROVEMENTS EXTENDED TO STA. 131+50 (C.C.O.2)

REVISION

BOYCE S. FUKUNAGA

REGISTERED PROFESSIONAL ENGINEER

No. 2107-C

HAWAII, U.S.A.

STATE OF HAWAII

DEPARTMENT OF TRANSPORTATION

HIGHWAYS DIVISION

**SHEET LAYOUT PLANS, FIELD OFFICE AND BATCH PLANT LOCATION MAPS**

MAUNA KEA OBSERVATORY ACCESS ROAD

PHASE II-A

PROJECT NO. HWY-H-01-86

SCALE: AS SHOWN

THIS WORK WAS PREPARED BY ME OR UNDER MY SUPERVISION

Boyce S. Fukunaga

FUKUNAGA & ASSOCIATES

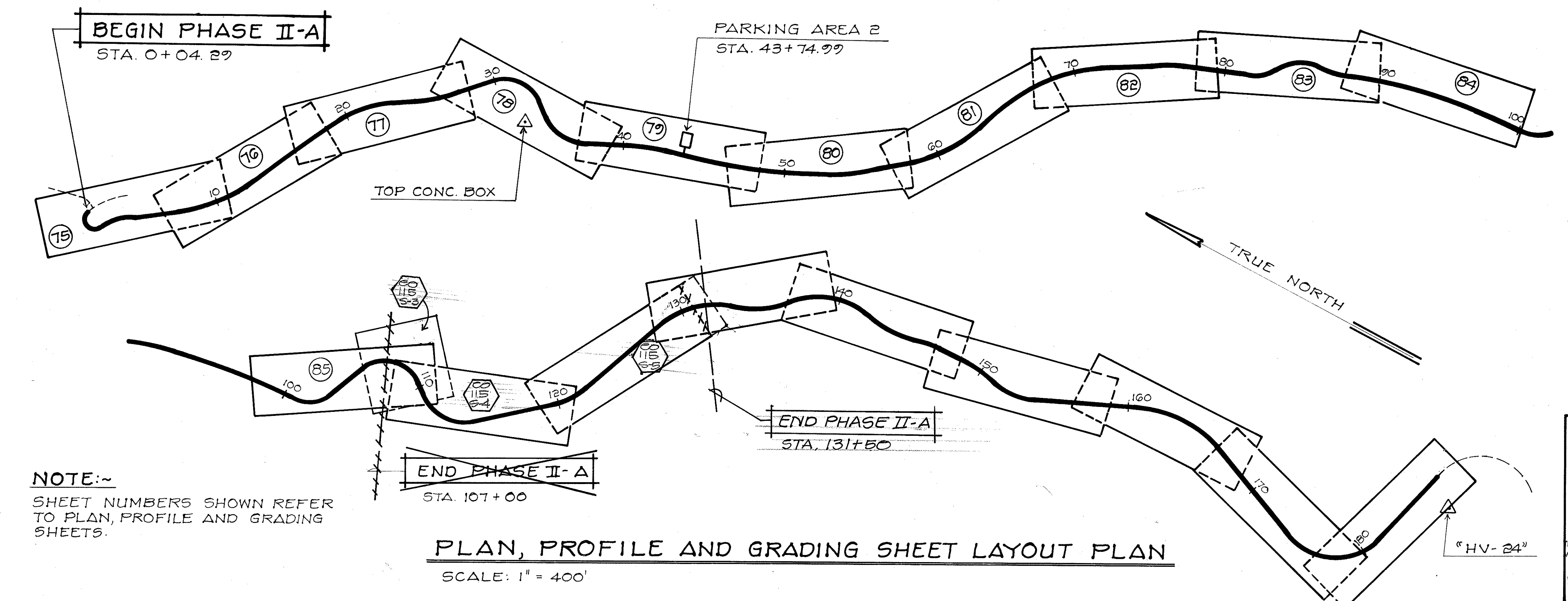
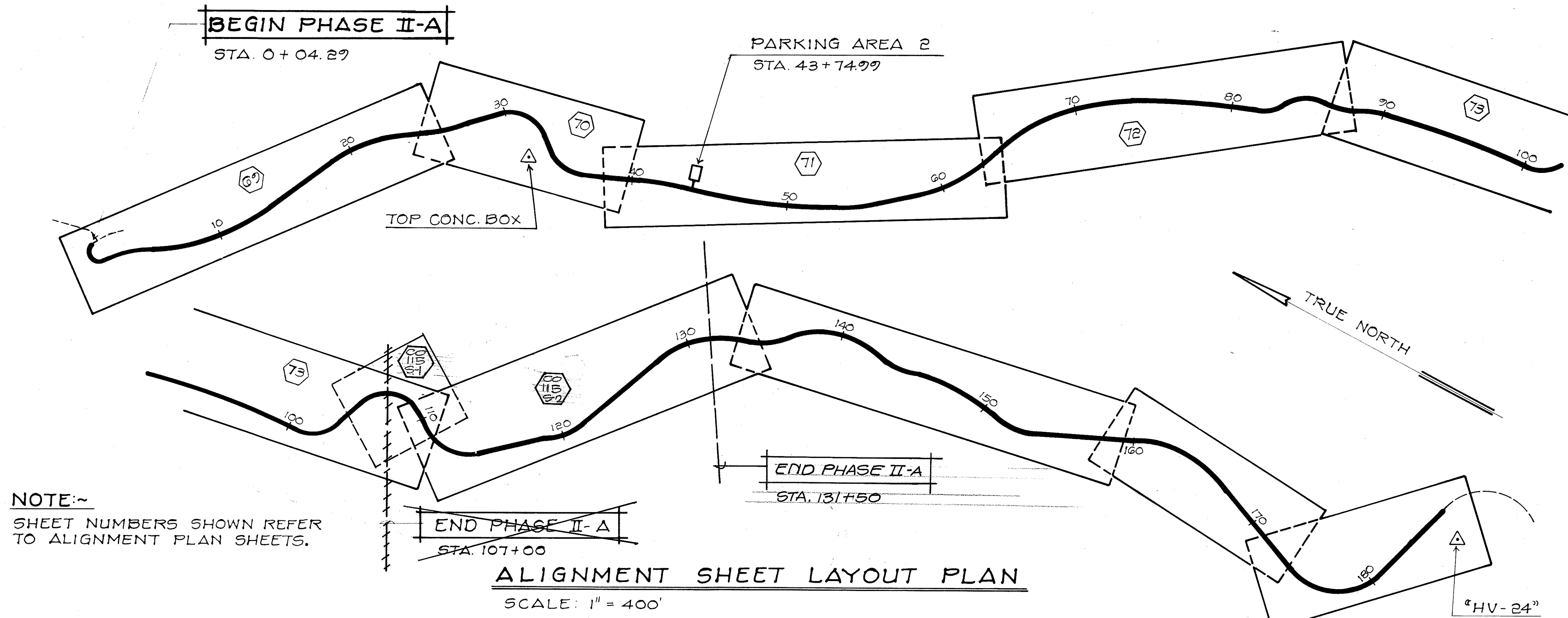

SURVEY PLOTTED BY	DATE
DRAWN BY	
DESIGNED BY	
QUANTITIES BY	
CHECKED BY	
ORIGINAL PLAN	
NOTE BOOK	
No.	