

FED. ROAD DIST. No.	STATE	FED. AID PROJ. No.	FISCAL YEAR	SHEET No.	TOTAL SHEETS
HAWAII	HAW.	ER 8(1)	1961	2	7
		ER 8(2)	1961	2	7

Revised July 31, 1961

Contractor shall fill in proper figures in place of Capital letters of Transportation.

STATE - FEDERAL HIGHWAY CONSTRUCTION

2.921 MILES COST \$ 000,000
STATE FUNDS 50% FEDERAL-AID FUNDS 50%

HAWAII U.S. DEPT. OF COMMERCE
DIVISION OF BUREAU OF HIGHWAYS PUBLIC ROADS

PROJECTS ER 8(1) AND ER 8(2)

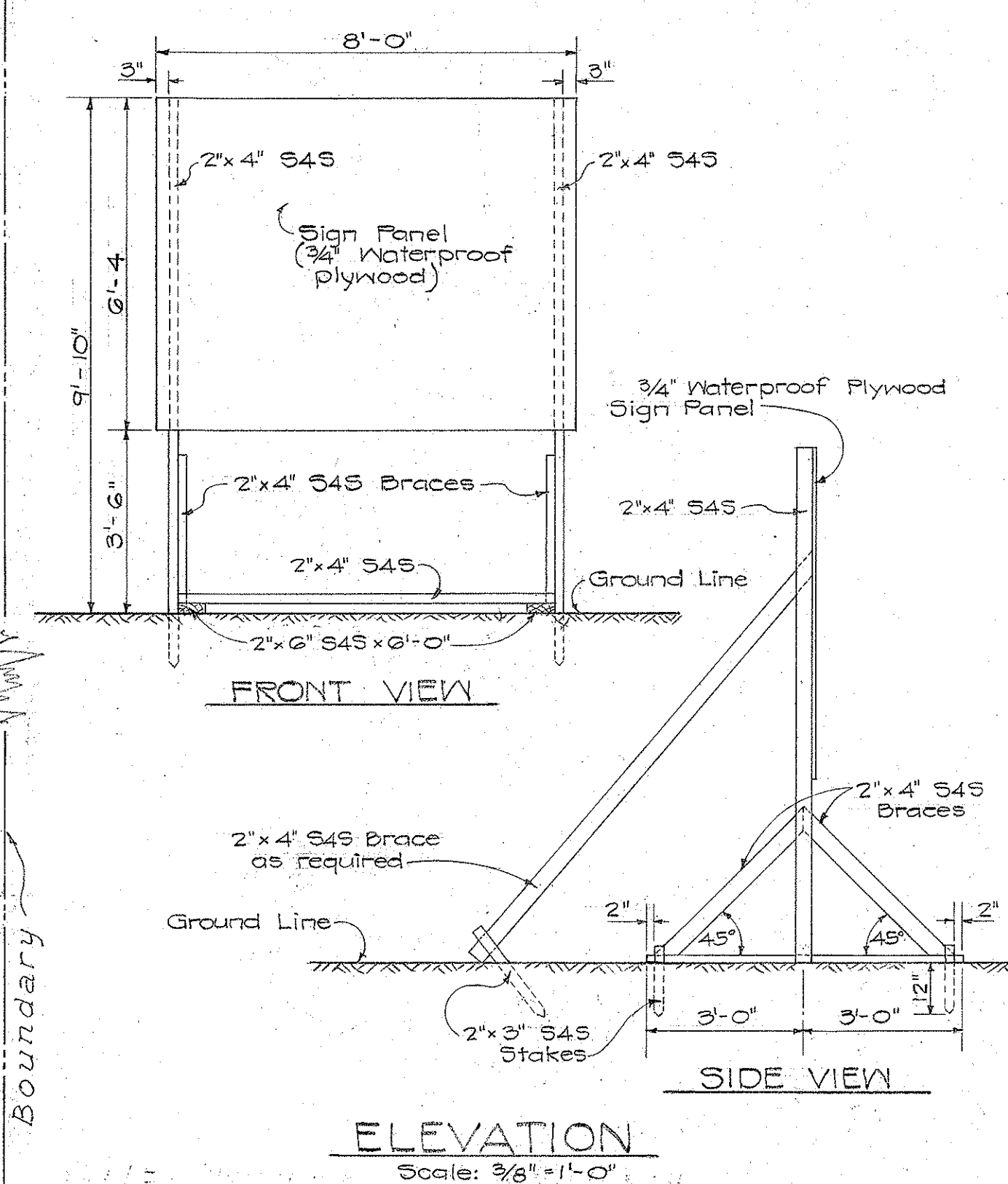

CONSTRUCTION IDENTIFICATION SIGN
(TWO REQUIRED)
Scale: 3/4" = 1'-0"

NOTE:
The locations of the Construction Identification Signs shown on these Plans are approximate only, the Engineer shall determine the exact locations and placements in the field.

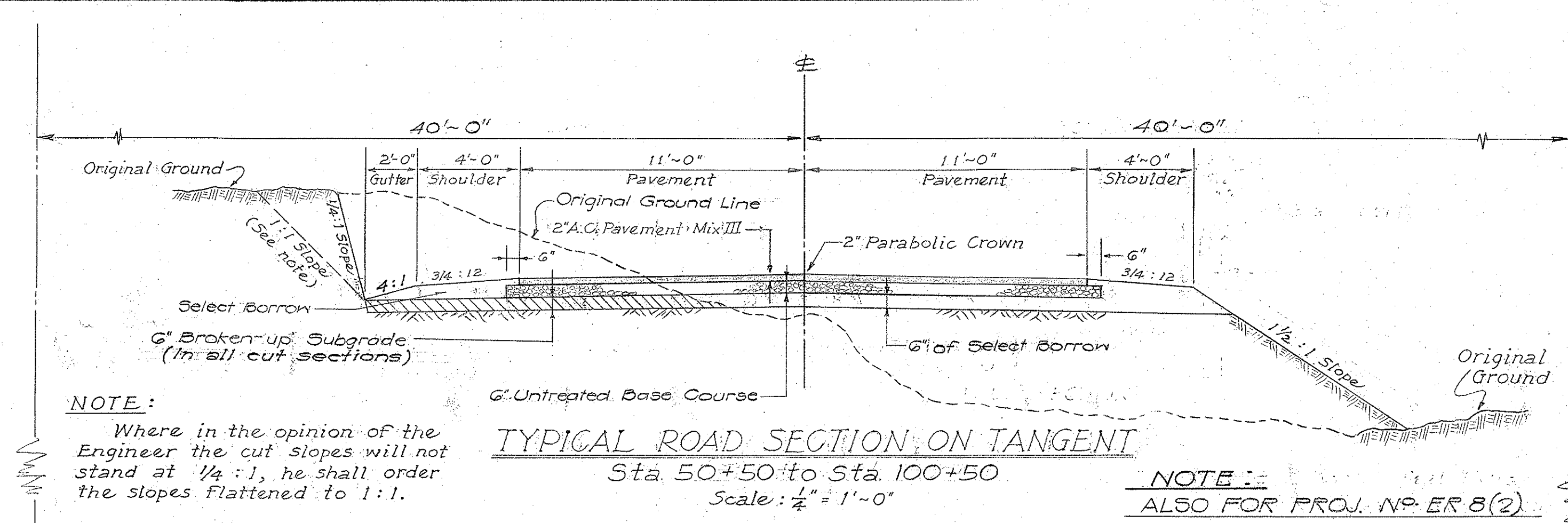

NOTE:
Where in the opinion of the Engineer the cut slopes will not stand at 1/4 : 1, he shall order the slopes flattened to 1 : 1.

NOTE:
ALSO FOR PROJ. NO. ER 8(2)

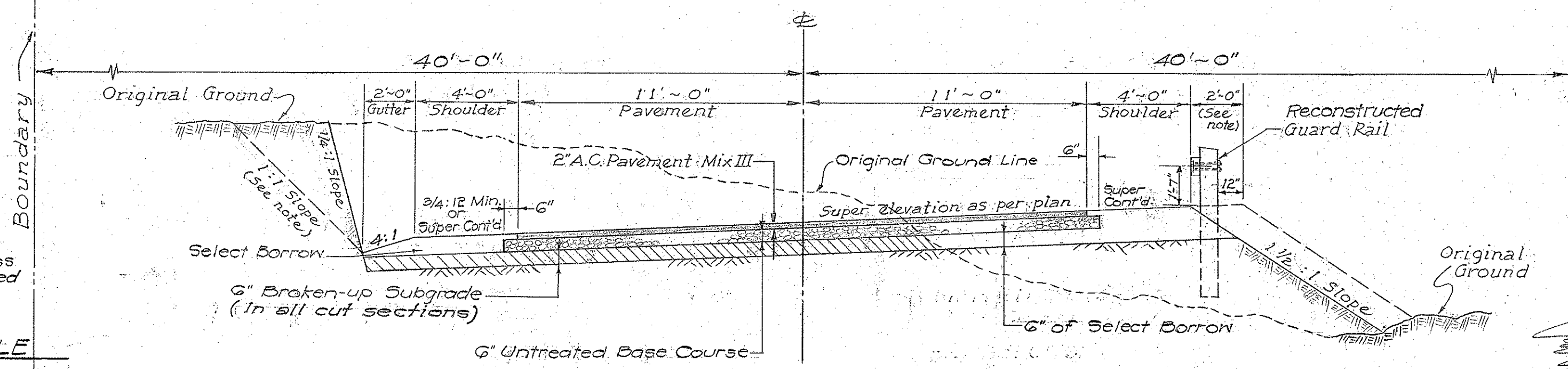

NOTE:
Fill slopes shall be flattened as per Fill Slope Table with excess material where ordered by the Engineer.

FILL SLOPE TABLE

0' - 4'	4:1 Slope
4' - 10'	3:1 to 2:1 Slope
10' - Over	1 1/2 : 1 Slope

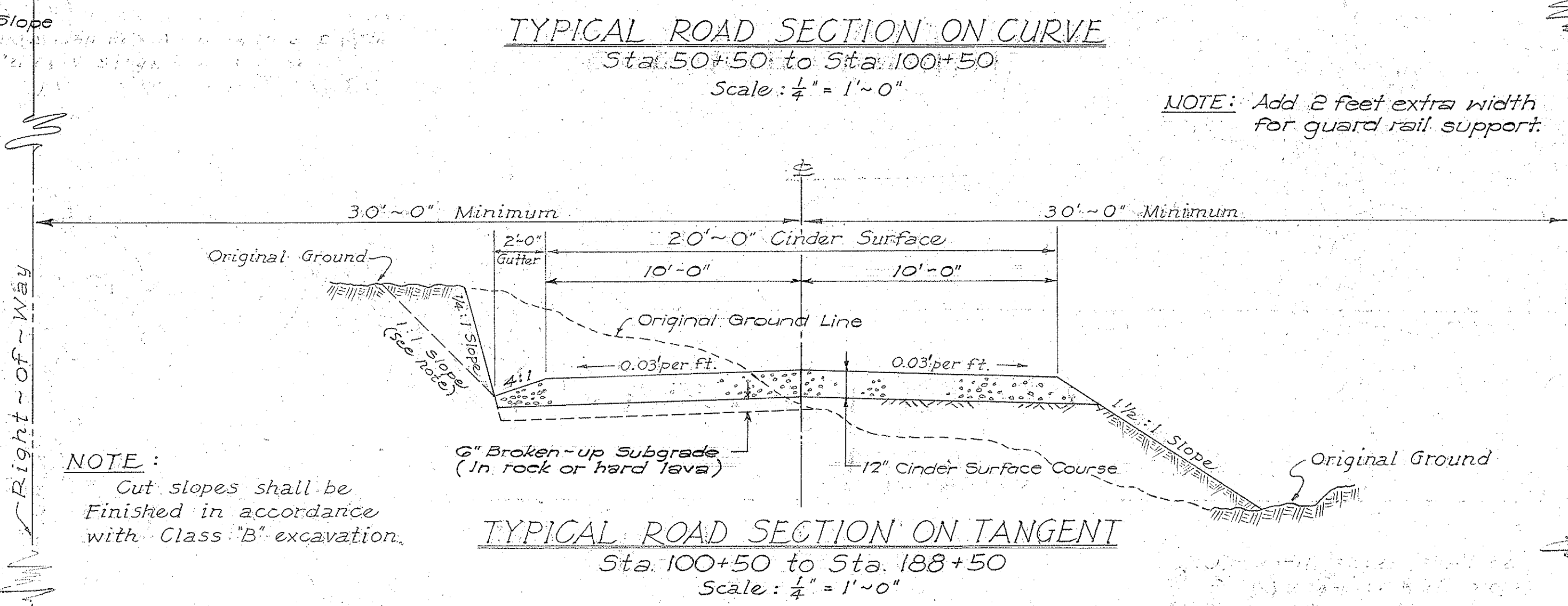

NOTE:
Cut slopes shall be finished in accordance with Class 'B' excavation.

NOTE: Add 2 feet extra width for guard rail support.

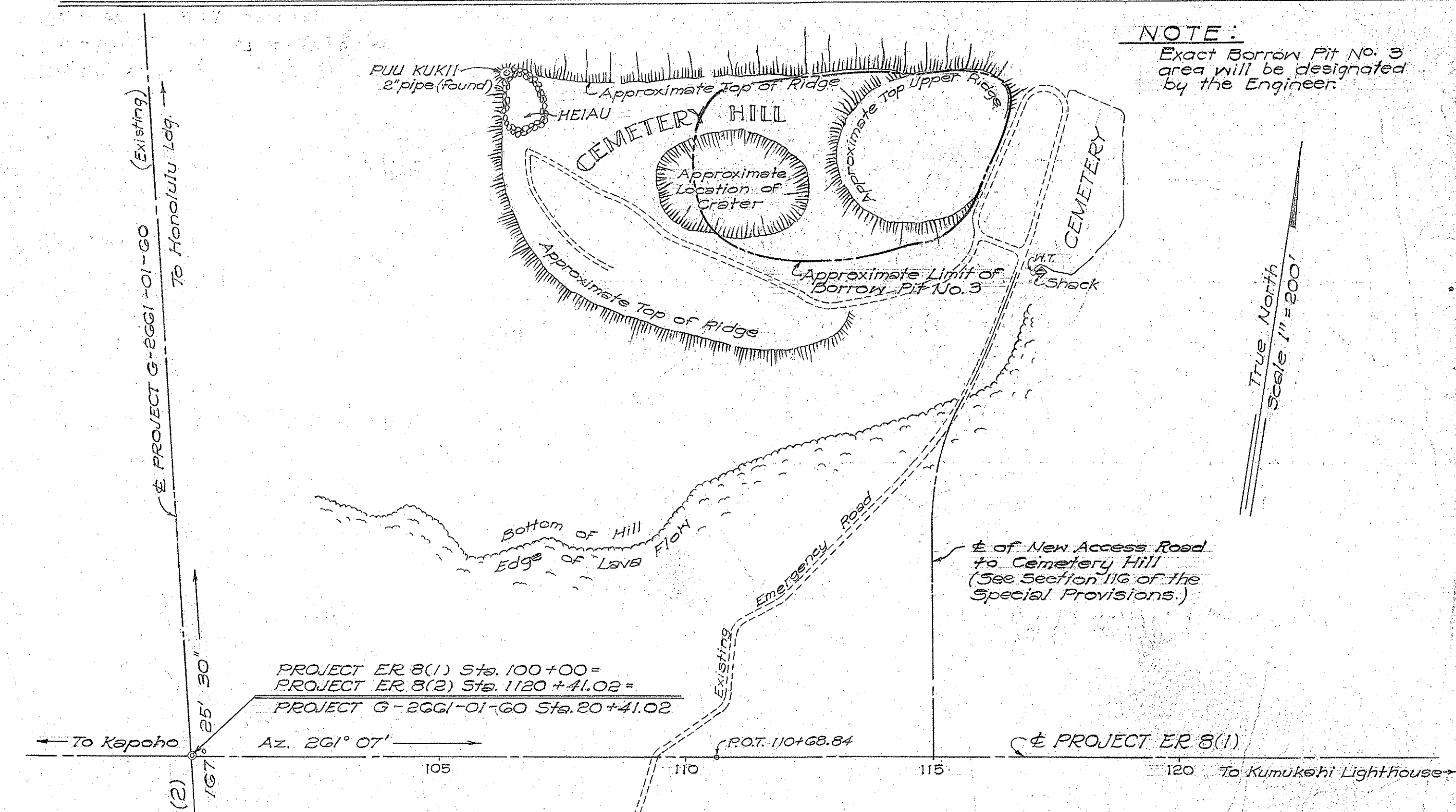
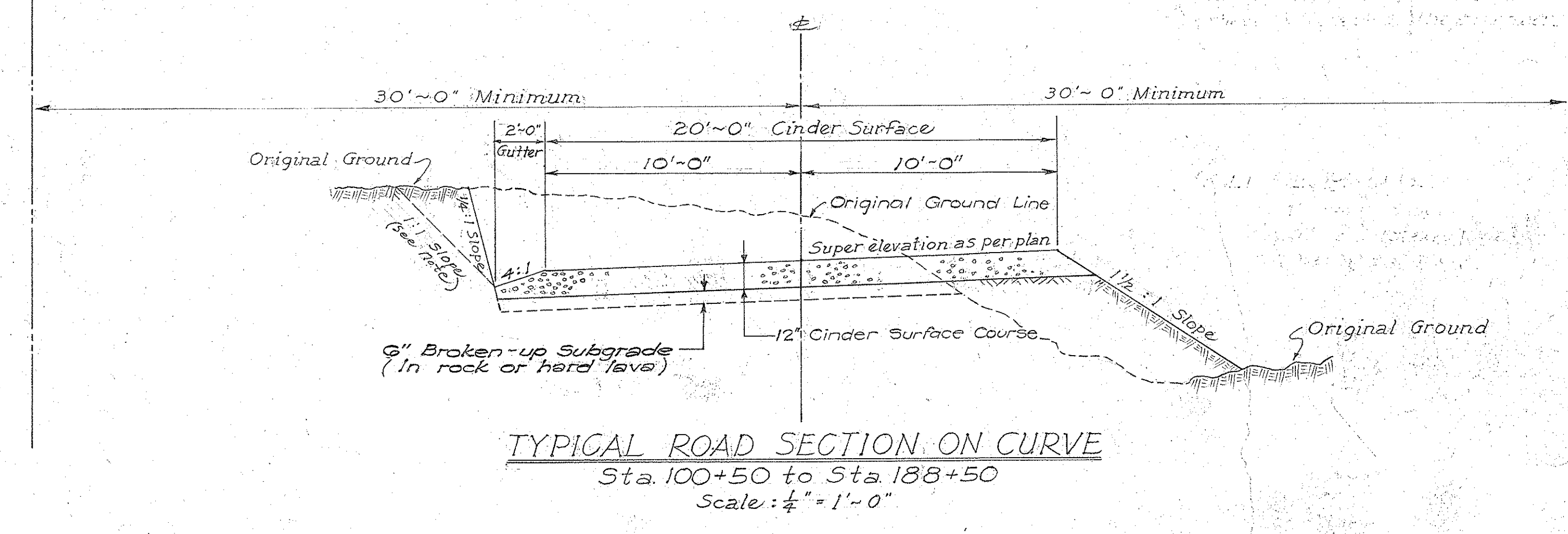

NOTE:
Exact Borrow Pit No. 3 area will be designated by the Engineer.

DEPARTMENT OF TRANSPORTATION
DIVISION OF HIGHWAYS
STATE OF HAWAII

TYPICAL SECTIONS
KAPOHO - KUMUKAHI ROAD
PROJ. NO. ER 8(1)
KAPOHO - POHOIKI ROAD
PROJ. NO. ER 8(2)
PUNA, HAWAII

Scale: As Noted Date: Nov. 1960