

FED. ROAD DIST. No.	STATE	FED. AID PROJ. No.	FISCAL YEAR	SHEET No.	TOTAL SHEETS
HAWAII	HAW.	ER 8(1)	1961	2	7
		ER 8(2)	1961	2	7

Revised July 31, 1961

Contractor shall fill in proper figures in place of Capital letters of Transportation.

STATE - FEDERAL HIGHWAY CONSTRUCTION

2.921 MILES COST \$ 000,000
STATE FUNDS 50% FEDERAL-AID FUNDS 50%

HAWAII U.S. DEPT. OF COMMERCE
DIVISION OF BUREAU OF HIGHWAYS PUBLIC ROADS

PROJECTS ER 8(1) AND ER 8(2)

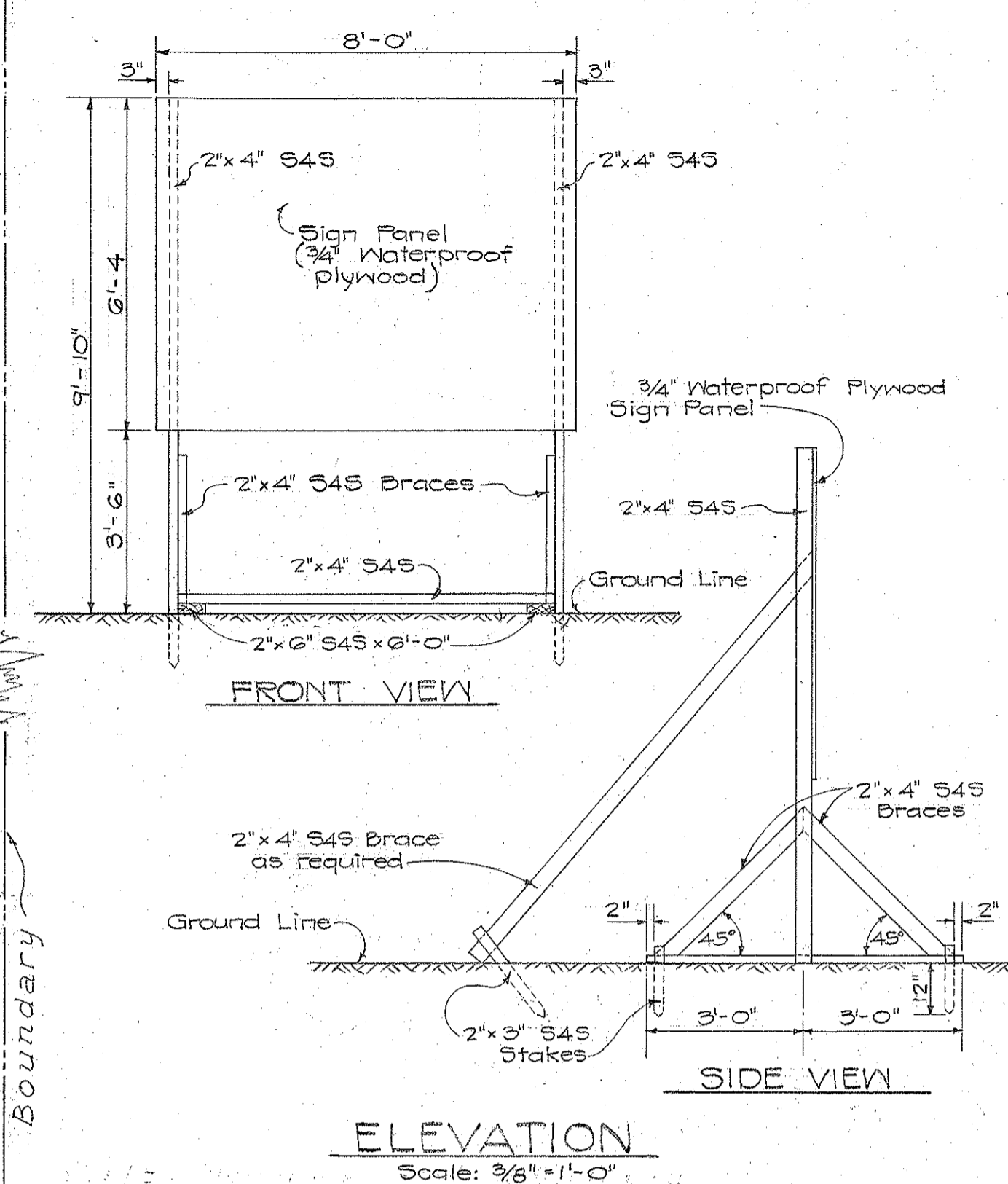

CONSTRUCTION IDENTIFICATION SIGN
(TWO REQUIRED)
Scale: 3/8" = 1'-0"

NOTE:
The locations of the Construction Identification Signs shown on these Plans are approximate only, the Engineer shall determine the exact locations and placements in the field.

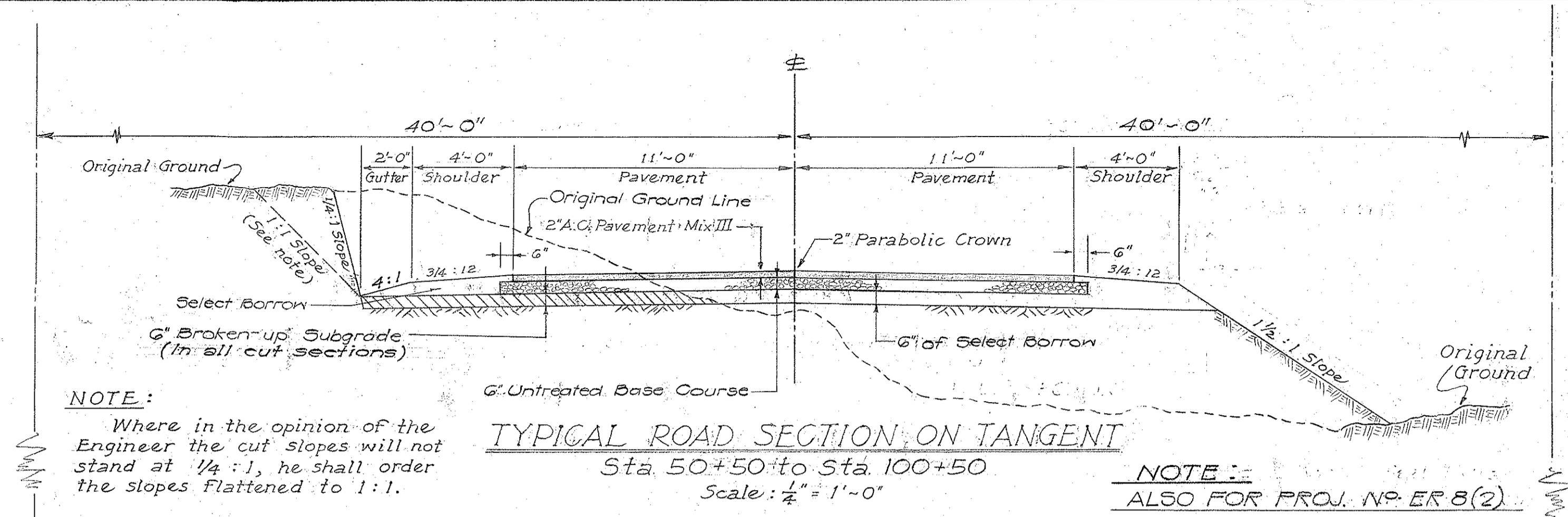

TYPICAL ROAD SECTION ON TANGENT
Sta. 50+50 to Sta. 100+50
Scale: 1/4" = 1'-0"

NOTE:
ALSO FOR PROJ. NO. ER 8(2)

NOTE:
Where in the opinion of the Engineer the cut slopes will not stand at 1/4 : 1, he shall order the slopes flattened to 1 : 1.

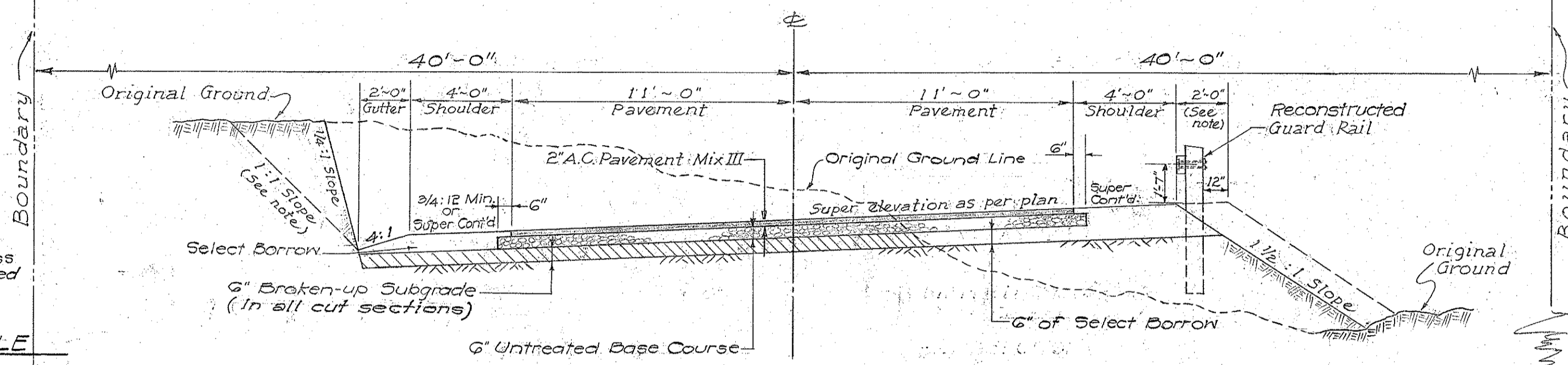

TYPICAL ROAD SECTION ON CURVE
Sta. 50+50 to Sta. 100+50
Scale: 1/4" = 1'-0"

NOTE: Add 2 feet extra width for guard rail support.

NOTE:
Fill slopes shall be flattened as per Fill Slope Table with excess material where ordered by the Engineer.

FILL SLOPE TABLE

0' - 4'	4:1 Slope
4' - 10'	3:1 to 2:1 Slope
10' - Over	1 1/2 : 1 Slope

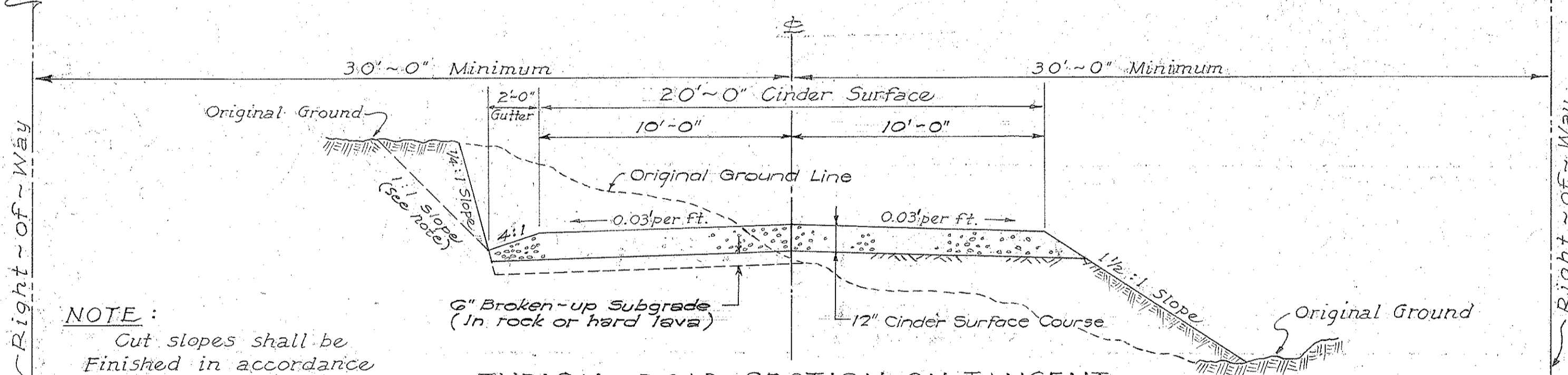

TYPICAL ROAD SECTION ON TANGENT
Sta. 100+50 to Sta. 188+50
Scale: 1/4" = 1'-0"

NOTE:
Cut slopes shall be finished in accordance with Class 'B' excavation.

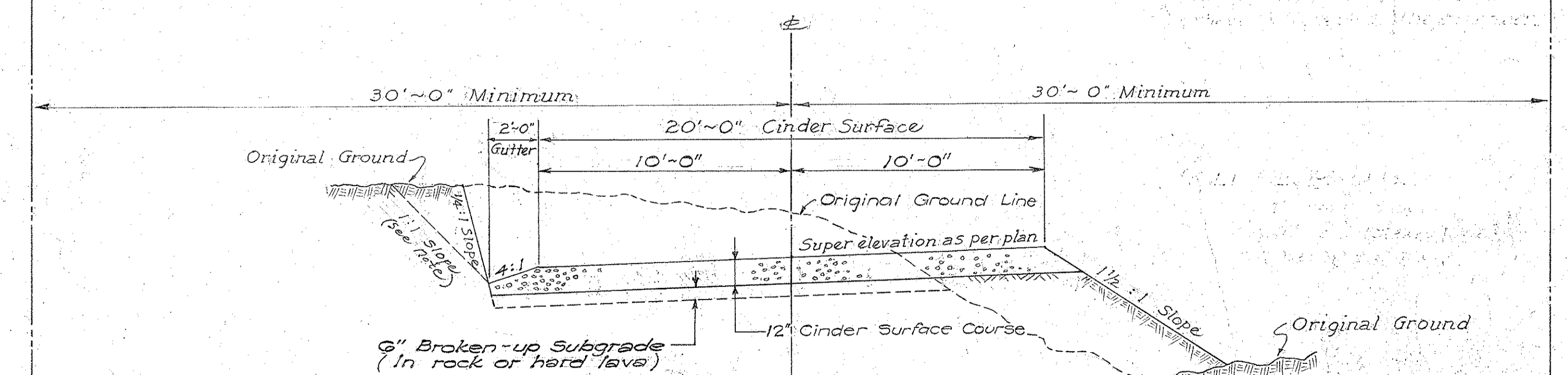

TYPICAL ROAD SECTION ON CURVE
Sta. 100+50 to Sta. 188+50
Scale: 1/4" = 1'-0"

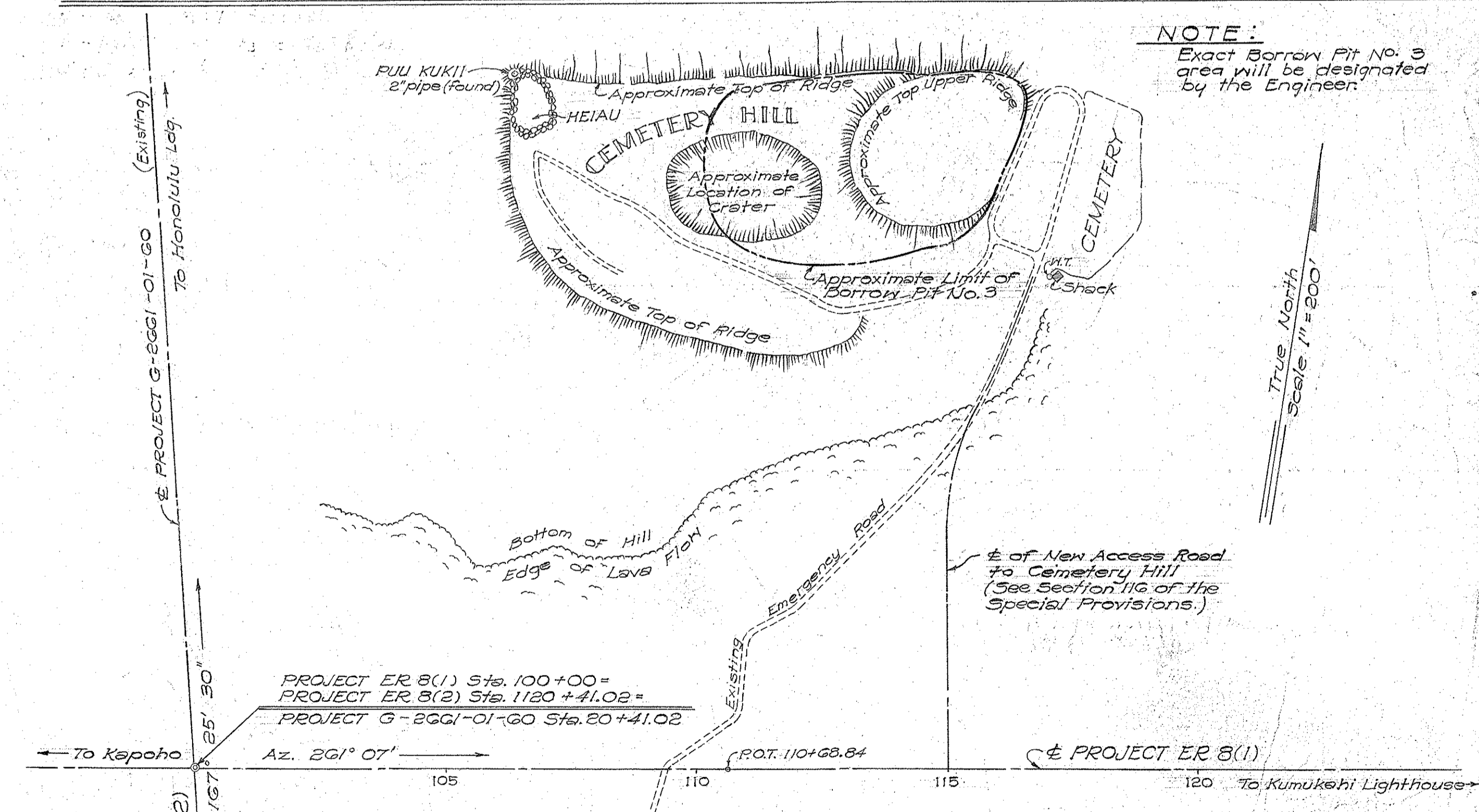

NOTE:
Exact Borrow Pit No. 3 area will be designated by the Engineer.

BORROW PIT SITE AT CEMETERY HILL (PUU KUKAE)
(BORROW PIT NO. 3)

DEPARTMENT OF TRANSPORTATION
DIVISION OF HIGHWAYS
STATE OF HAWAII

TYPICAL SECTIONS
KAPOHO - KUMUKAHI ROAD
PROJ. NO. ER 8(1)
KAPOHO - POHOIKI ROAD
PROJ. NO. ER 8(2)
PUNA, HAWAII

Scale: As Noted Date: Nov. 1960