

LANDSCAPE CONSTRUCTION PLAN
SCALE: 1/16"=1'-0"

GENERAL NOTES

1. INSPECT THE SITE AND VERIFY CONDITIONS PRIOR TO COMMENCING WITH THE WORK. SPECIAL ATTENTION SHALL BE PAID TO EXISTING IRRIGATION SYSTEMS AND UTILITIES. DISCREPANCIES SHALL BE BROUGHT TO THE ATTENTION OF THE ENGINEER. BY COMMENCING WITH THE WORK, THE CONTRACTOR ACCEPTS THE EXISTING CONDITIONS AND RESPONSIBILITY FOR MAINTAINING THOSE CONDITIONS.
2. THE EXISTENCE AND LOCATION OF EXISTING UTILITY SYSTEMS, PAVEMENT STRUCTURES AND APPURTENANCES NOTED ON THESE PLANS ARE FROM FIELD OBSERVATIONS AND THE LATEST AVAILABLE PLANS AND ARE NOT GUARANTEED AS TO THE EXISTENCE OF OBSTACLES OR UTILITIES WHICH MAY BE ENCOUNTERED. THE LOCATIONS SHOWN ARE APPROXIMATE ONLY. THE CONTRACTOR SHALL PERFORM AN INDEPENDENT CHECK OF ELEMENTS AND CONFLICTING STRUCTURES. DISCREPANCIES SHALL BE REPORTED TO THE ENGINEER. REASONABLE MODIFICATIONS TO ACCOMMODATE SITE CONDITIONS SHALL NOT CONSTITUTE A RIGHT TO ADDITIONAL FUNDS.
3. EXISTING PAVEMENTS, STRUCTURES AND UTILITIES ADJACENT TO CONSTRUCTION LIMITS UNDER THIS CONTRACT SHALL BE PROTECTED. AIRPORT OPERATIONS SHALL BE MAINTAINED. COORDINATE OPERATIONS WITH THE ARCHITECTURAL PHASING PLANS AND THE ENGINEER. ADJACENT PAVEMENTS, STRUCTURES AND UTILITIES DAMAGED BY WORK UNDER THIS CONTRACT SHALL BE REPAIRED AT CONTRACTOR'S EXPENSE TO THE SATISFACTION OF THE ENGINEER.
5. THE CONTRACTOR SHALL NOT ALTER FROM THE DRAWINGS AND SPECIFICATIONS. IN THE EVENT OF ERRORS OR DISCREPANCIES, THE CONTRACTOR SHALL IMMEDIATELY NOTIFY THE ENGINEER.
6. DAMAGE TO EXISTING PLANTING OUTSIDE THE PROJECT LIMITS RESULTING FROM DELAYS IN REPAIRING DAMAGED IRRIGATION SYSTEMS OR FROM WORK UNDER THIS CONTRACT SHALL BE REPLACED AND PAID FOR BY THE CONTRACTOR TO THE SATISFACTION OF THE ENGINEER.

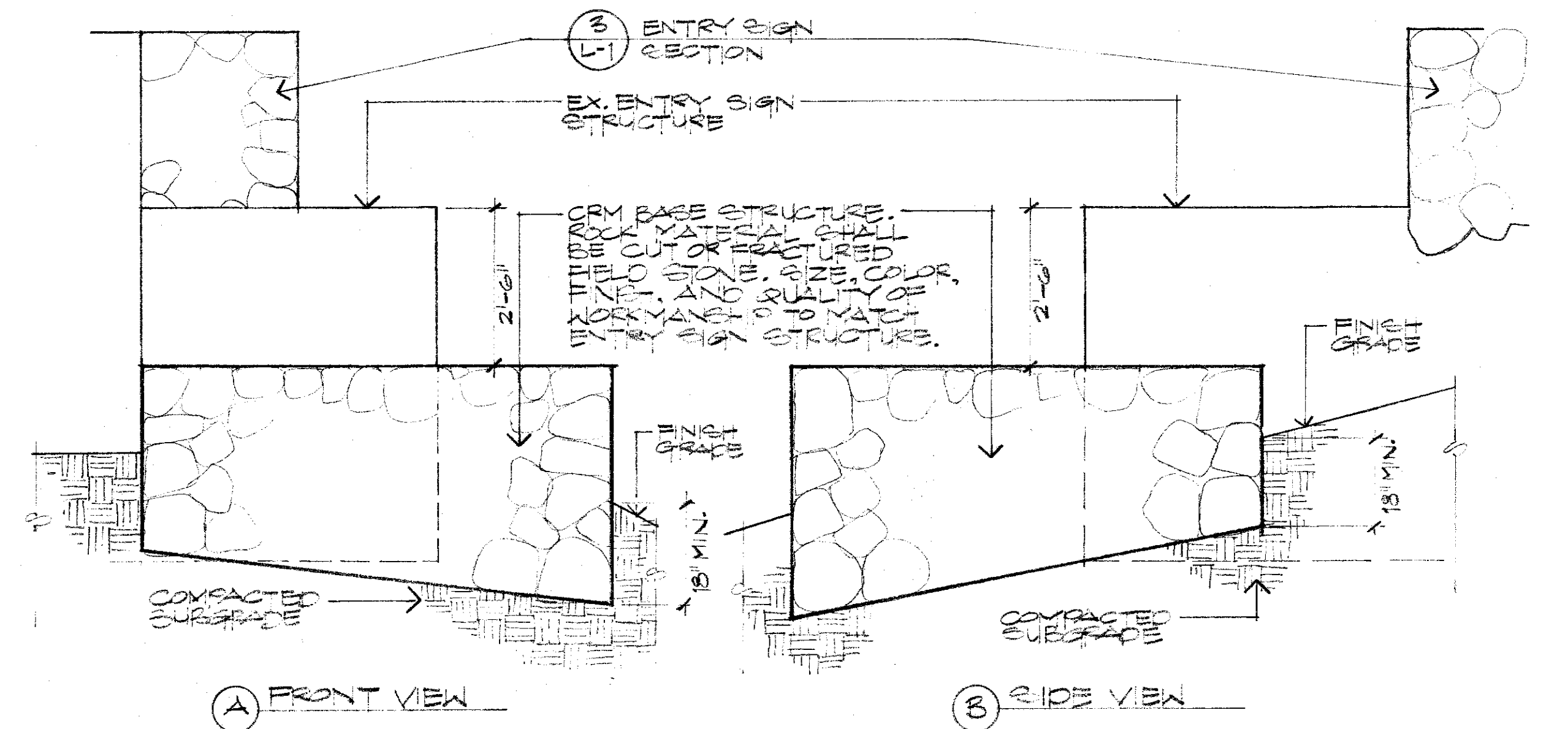
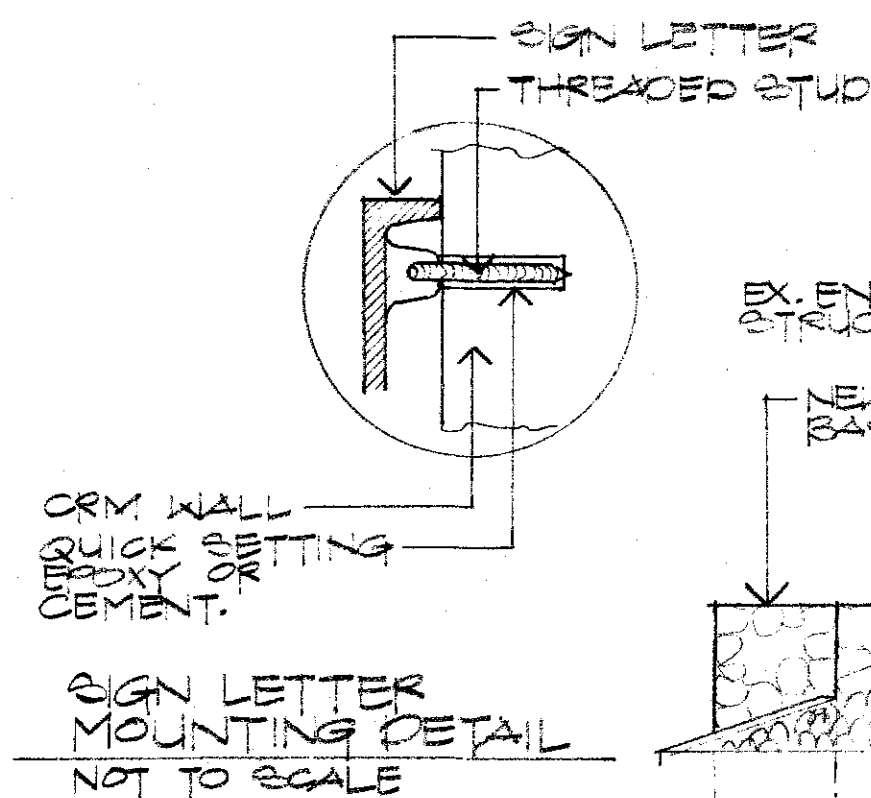

1 SIGN BASE SECTION
L-1 1/2"=1'-0"

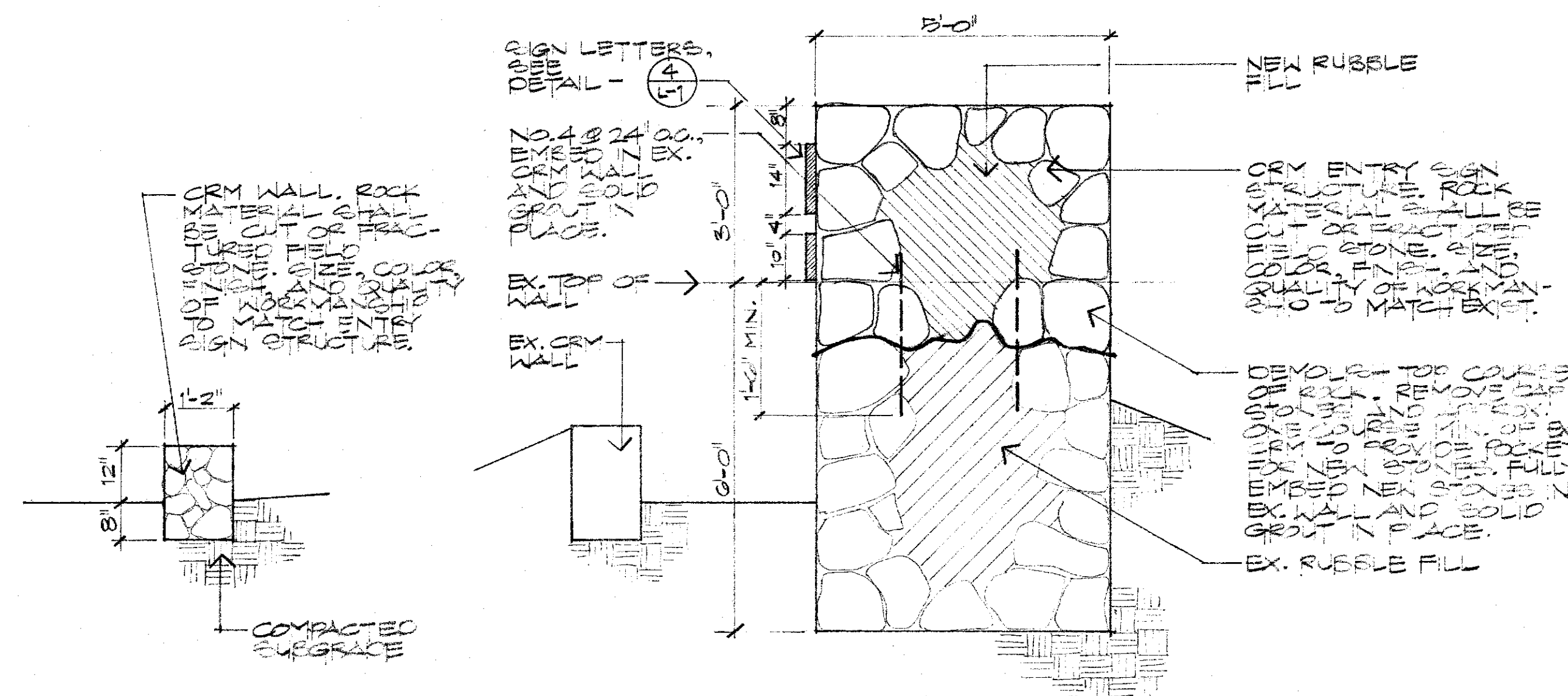

2 CRY WALL SECTION
L-1 1/2"=1'-0"

3 ENTRY SIGN SECTION
L-1 1/2"=1'-0"

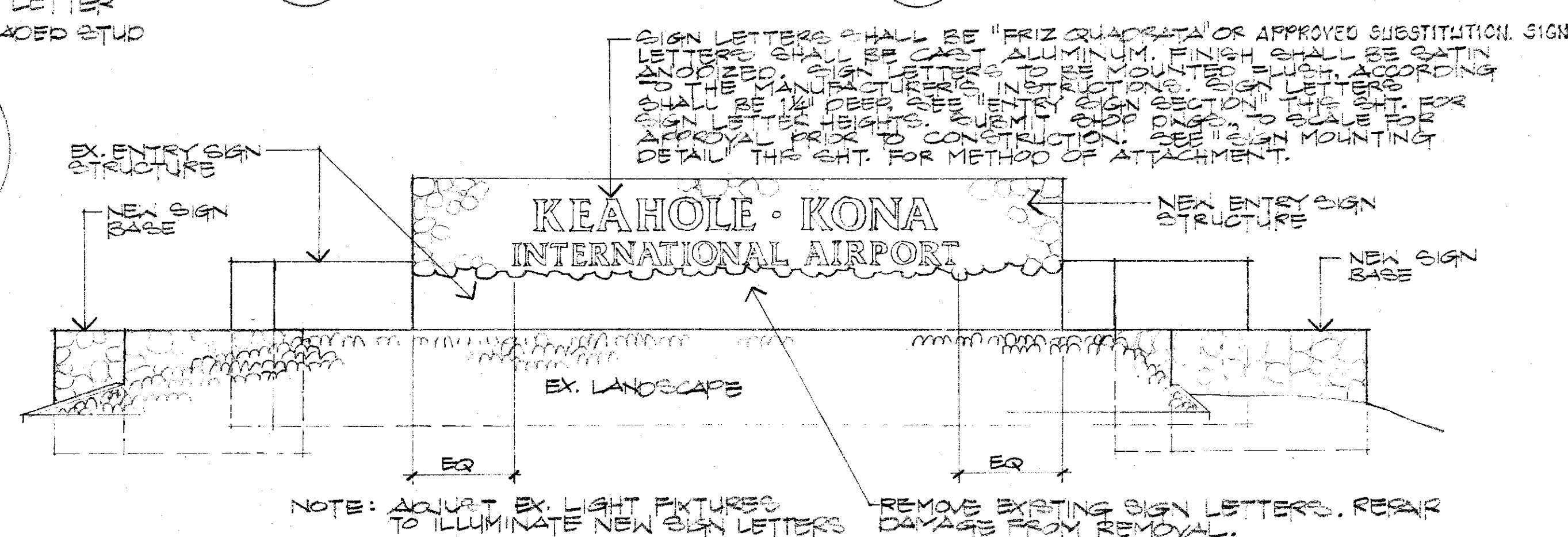

4 ENTRY SIGN ELEVATION
L-1 1/2"=1'-0"

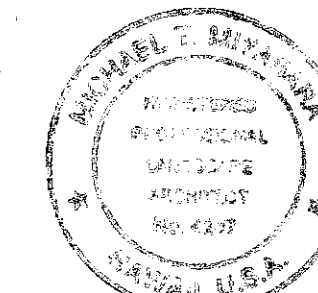

THIS WORK WAS PREPARED BY ME OR UNDER MY SUPERVISION

DSGN. DRWN. CHKD. APPD.

KEY PLAN / NOTES :

7/2/96 AS-BUILT

NO. DATE REVISION

PROJECT TITLE :

SIGN MODIFICATION AND GRADING
AIRPORT ACCESS ROAD
KEAHOLE-KONA INTERNATIONAL AIRPORT

PROJECT NO. :

PROJECT NO. AH 2044 - 16

SHEET TITLE :

LANDSCAPE CONSTRUCTION
PLAN AND DETAILS

DATE :

7/2/96

DWG. NO. :

L-1

SHEET OF

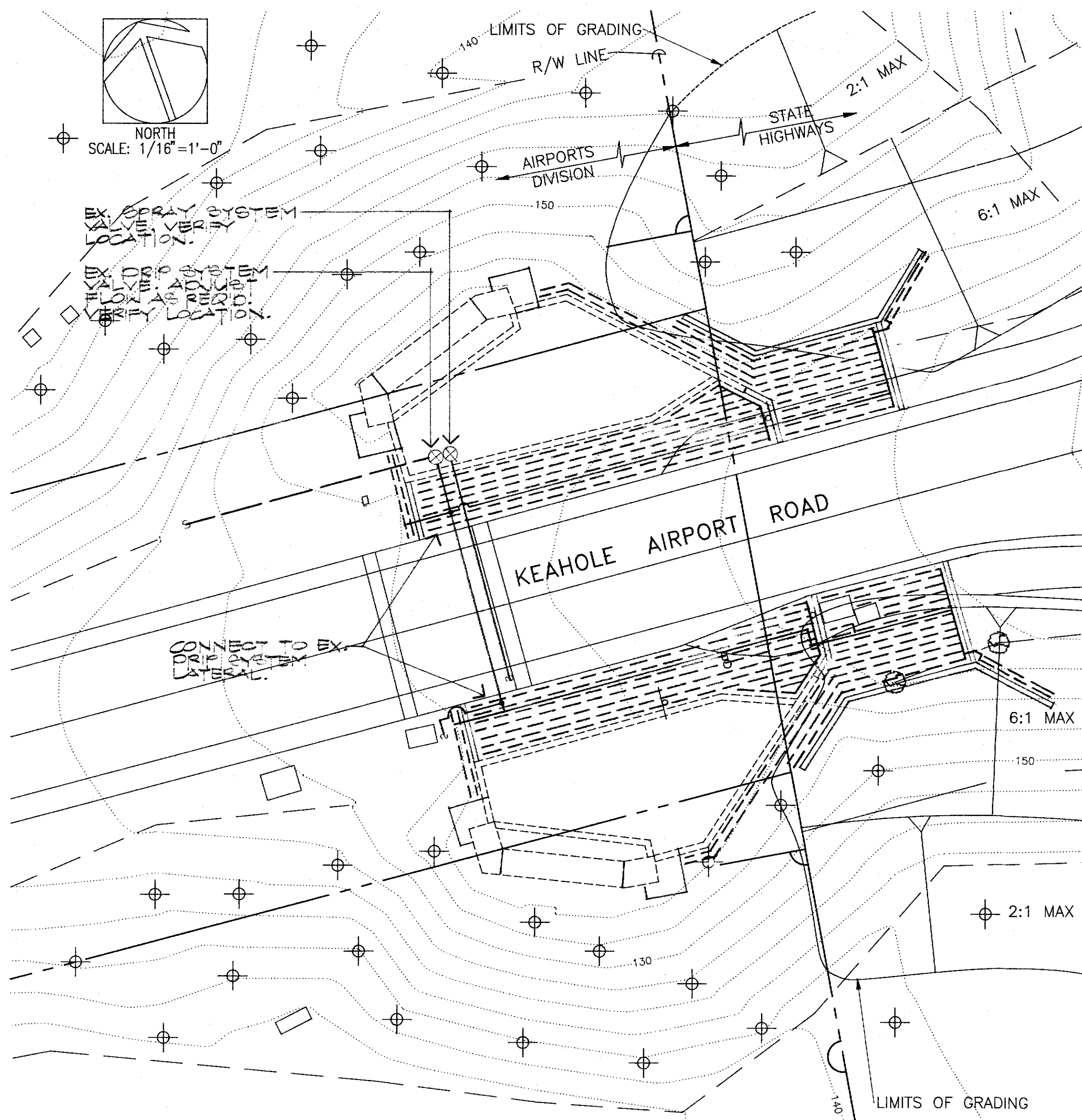

LANDSCAPE IRRIGATION PLAN
SCALE: 1/16"=1'-0"

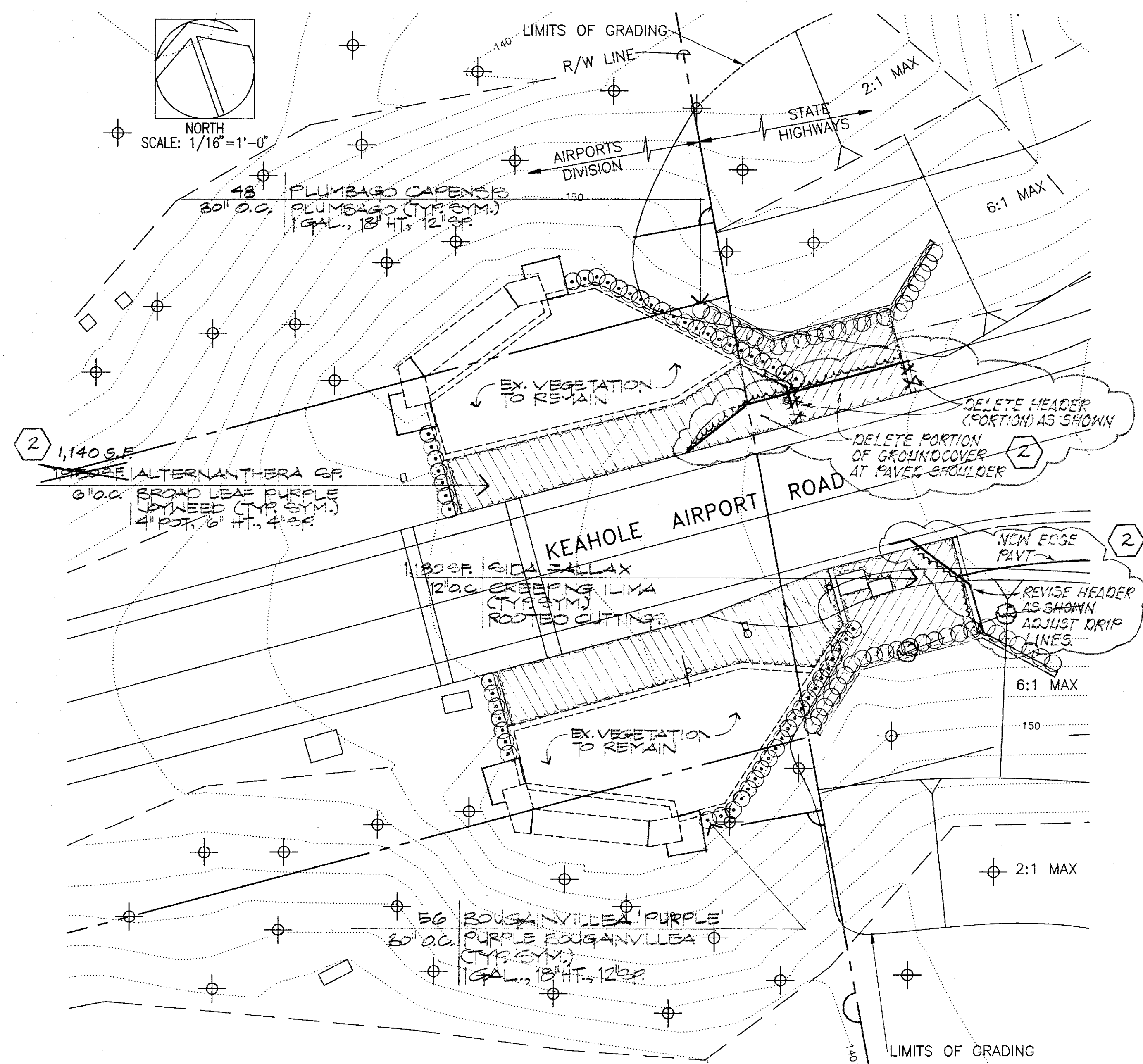

LANDSCAPE PLANTING PLAN
SCALE: 1/16"=1'-0"

IRRIGATION EQUIPMENT LIST AND LEGEND

THE USE OF MANUFACTURER, NAME, OR BRAND, ON THIS LIST IS TO ESTABLISH QUALITY AND PERFORMANCE. MATERIALS OF OTHER MANUFACTURER'S WHICH MEET THESE SPECIFICATIONS ARE ALLOWED AND SHALL BE SUBJECT TO APPROVAL PER THE TERMS OF THE SPECIFICATIONS.

| SYMBOL | DESCRIPTION | NOTES |
|--------|----------------------------------------------------------------------------------------------------------------------------------------------------------------------------------------------------------|----------------|
| --- | LATERAL (NON-PRESSURE LINE) | SIZES AS NOTED |
| ● | IRRIGATION HEADS | DISCHARGE RATE |
| --- | PRESSURE COMPENSATING DRIP LINE, 1/2" O.D., WITH OUTLETS AT 12" O.C. | 42 GPH/OUTLET |
| --- | DRIP LINE SHALL MAINTAIN A CONSTANT FLOW RATE OVER PRESSURE RANGES FROM 5-60 PSI. DRIP LINE WALL THICKNESS SHALL HAVE 0.03" MIN. THICKNESS. MANUFACTURING VARIATION SHALL NOT VARY BY MORE THAN 0.03 CV. | |

IRRIGATION NOTES

- IRRIGATION SYSTEMS ARE DIAGRAMMATIC AND SUBJECT TO MINOR ADJUSTMENTS DUE TO UNANTICIPATED FIELD CONDITIONS. IRRIGATION HEADS SHALL BE INSTALLED WHERE SHOWN, ADJUSTMENTS TO HEAD PLACEMENT MAY BE MADE IN THE FIELD ONLY TO AVOID OBSTACLES OR TO IMPROVE COVERAGE. HEADS SHALL NOT BE SPACED FURTHER THAN SHOWN ON THE DRAWINGS. VALVES SHALL BE INSTALLED IN THE VICINITY OF THE LOCATIONS SHOWN AND BE ACCESSIBLE FOR SERVICE AND USE. AVOID CONFLICTS WITH PLANTINGS, UTILITIES AND ARCHITECTURAL ELEMENTS.
- PRIOR TO EXCAVATION FOR IRRIGATION LINES, THE CONTRACTOR SHALL VERIFY IN THE FIELD THE EXACT LOCATION AND DEPTH OF THE LINES AND EXERCISE CAUTION WHEN EXCAVATING.
- EXISTING IRRIGATION SYSTEMS SHALL REMAIN IN OPERATION, UNLESS SPECIFIED ON THE PLANS TO BE REMOVED OR ABANDONED. SHOULD EXISTING SYSTEMS BE DAMAGED DUE TO WORK UNDER THIS CONTRACT, THE CONTRACTOR SHALL IMMEDIATELY MAKE NECESSARY REPAIRS OR SHALL PROVIDE FOR TEMPORARY IRRIGATION UNTIL REPAIRS CAN BE MADE. DAMAGE TO EXISTING SYSTEMS SHALL BE REPAIRED AND PAID FOR BY THE CONTRACTOR.
- WHERE NOTED, NEW IRRIGATION SYSTEMS SHALL BE CONNECTED TO EXISTING IRRIGATION SYSTEMS. COORDINATE DEMOLITION WORK TO AVOID REMOVAL OR DAMAGE TO SUCH SYSTEMS EXCEPT AS REQUIRED FOR NEW CONSTRUCTION.

PLANTING NOTES

- INSTALL TOPSOIL PER SPECIFICATIONS. THE CONTRACTOR SHALL BE RESPONSIBLE TO DETERMINE AND PROVIDE ADEQUATE QUANTITIES OF TOPSOIL REQUIRED TO INSTALL PLANTINGS COMPLETE AND IN PLACE. CAREFULLY COORDINATE TO INSURE PROPER PLACEMENT TO FINISH GRADES. IT SHALL BE THE RESPONSIBILITY OF THE CONTRACTOR TO MAINTAIN FINISH GRADES. PUDDLE AND SETTLE MIX.
- PLANT QUANTITIES ARE APPROXIMATE. THE CONTRACTOR SHALL VERIFY QUANTITIES AND PROVIDE THE QUANTITY OF PLANT MATERIALS REQUIRED TO FULFILL THE DESIGN INTENT OF THE PLANS AT THE SIZES AND SPACING NOTED.



THIS WORK WAS PREPARED BY
ME OR UNDER MY SUPERVISION

DSGN. DRWN. CHKD. APPD.

KEY PLAN / NOTES :

2 7/2/96 A5-BUILT

NO. DATE REVISION

PROJECT TITLE :

IGN MODIFICATION
AND GRADING
AIRPORT ACCESS ROAD
KEAHOLE-KONA INTERNATIONAL
AIRPORT.

PROJECT NO. :

PROJECT NO. AH 2044-16

SHEET TITLE :

LANDSCAPE IRRIGATION
AND PLANTING PLAN

DATE :

5/2/94

DWG. NO. :

L-2

SHEET OF