

FED. ROAD DIST. NO.	STATE	FED. AID PROJ. NO.	FISCAL YEAR	SHEET NO.	TOTAL SHEETS
HAWAII	HAW.	ER-15(19)	2009	45	59

TRUE NORTH
SCALE: 1 in. = 20 ft.

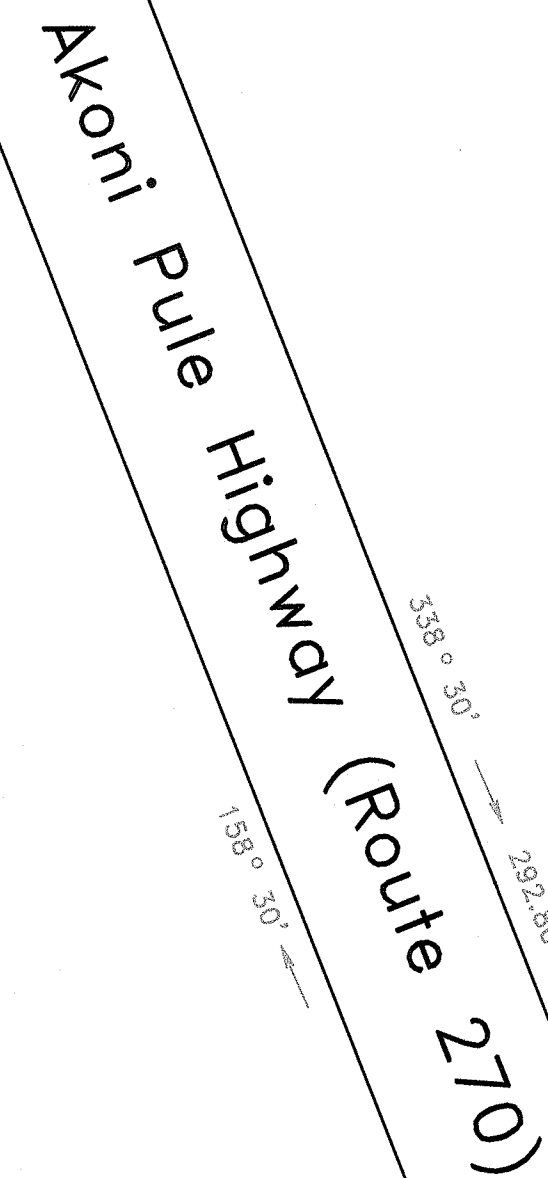

Lot 50-D
Ld. Ct. App. 1332
T.M.K.: 3rd Div. 5-2-01: 03

Sta. 265+90
End Project

Sta. 262+47
Begin Project

Spike (S)
lev. 486.7

Trv. "28"
1/2" Pip
Elev. 473

Lot 51-B
Ld. Ct. App. 1332
T.M.K.: 3rd Div. 5-2-05: 12

Possible Old Landslide

— Primary Area Of
Upper Rock Slope
Instability

— Construction Parcel A
(21,833 Sq. Ft.)

— Secondary Area Of Slope Stability

Remove and Reset

302 ° 05
20.18
R=17.00

Trv. "28-E"
R.R. Spike (Set)
Elev. 471.53

122° 05'
43.92
R=37.00

471.81
p. 1
T. 85 °

1.26

Sta. 262+47
Begin Project

20' 10' 0 20' 4

SCALE: 1" = 20'

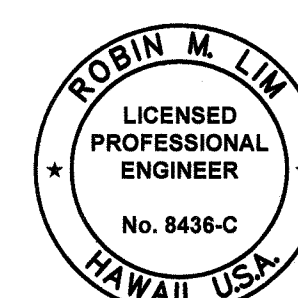

THIS WORK WAS PREPARED BY ME OR UNDER MY SUPERVISION AND CONSTRUCTION OF THIS PROJECT WILL BE UNDER MY OBSERVATION. "OBSERVATION OF CONSTRUCTION" IS DEFINED IN CHAPTER 16-115, HAWAII ADMINISTRATIVE RULES, ENTITLED "PROFESSIONAL ENGINEER, ARCHITECTS, SURVEYORS AND LANDSCAPE ARCHITECTS."

 4/30/10

SIGNATURE UC. EXPIRATION

STATE OF HAWAII
DEPARTMENT OF TRANSPORTATION
HIGHWAYS DIVISION

SITE PLAN - SITE 6

EMERGENCY EARTHQUAKE ROCKFALL REPAIRS

Various Locations on Hawaii, Unit 1

Federal Aid Project No. ER-15(19)

Scale: AS NOTED

Date: December 18, 2009

SHEET No. *G-6.1* OF 6 SHEETS

"AC-BUILT"

FED. ROAD DIST. NO.	STATE	FED. AID PROJ. NO.	FISCAL YEAR	SHEET NO.	TOTAL SHEETS
HAWAII	HAW.	ER-15(19)	2009	46	59

TRUE NORTH
SCALE: 1" = 40'

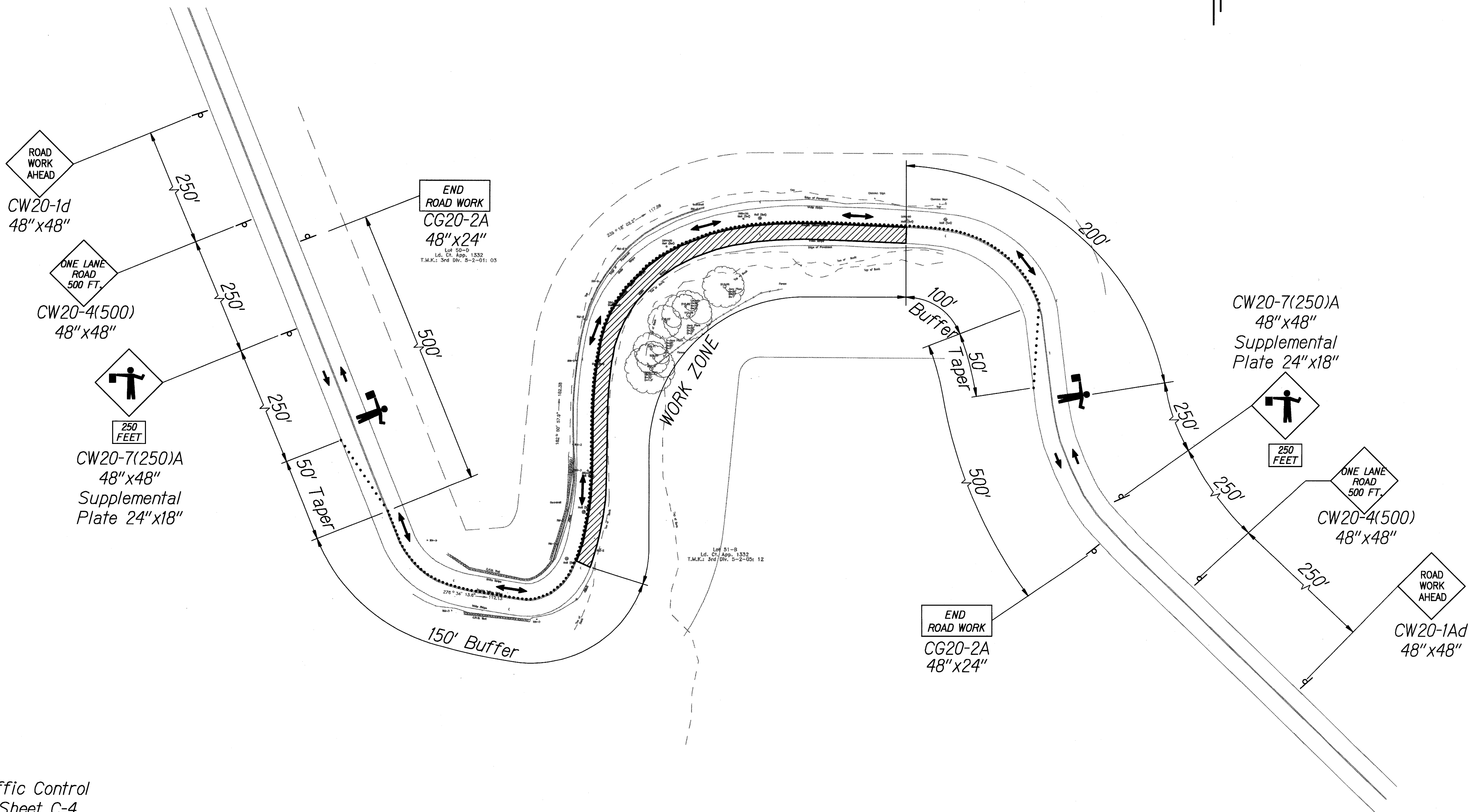

NOTE:
Refer To General Notes For Traffic Control
Plan Within State Right Of Way, Sheet C-4.

LEGEND:

- Work Area
- Temporary Traffic Control Sign W/ Stand
- Cone or Delineator
- Direction of Traffic
- Police Officer or Flagman

TRAFFIC CONTROL PLAN - SITE 6
Scale: 1"=20'

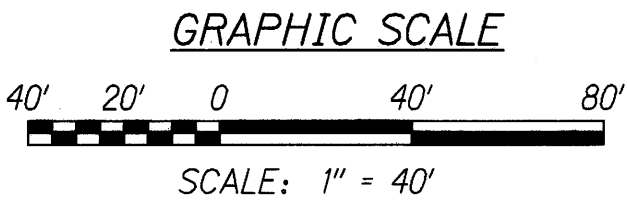

SCOTT A. KUNIOKA
LICENSED PROFESSIONAL ENGINEER
No. 7257-C
HAWAII, U.S.A.

LICENSE EXPIRATION DATE: 4/30/10
THIS WORK WAS PREPARED BY ME
OR UNDER MY SUPERVISION

SHIMABUKURO, ENDO & YOSHIZAKI, INC.
1126 12TH AVENUE
HONOLULU, HAWAII 96816

STATE OF HAWAII
DEPARTMENT OF TRANSPORTATION
HIGHWAYS DIVISION

TRAFFIC CONTROL PLAN - SITE 6

EMERGENCY EARTHQUAKE ROCKFALL REPAIRS
Various Locations on Hawai'i, Unit 1
Federal Aid Project No. ER-15(19)

Scale: 1" = 20' Date: December 18, 2009

SHEET No. C-61 OF 1 SHEETS

FED. ROAD DIST. NO.	STATE	FED. AID PROJ. NO.	FISCAL YEAR	SHEET NO.	TOTAL SHEETS
HAWAII	HAW.	ER-15(19)	2009	47	59

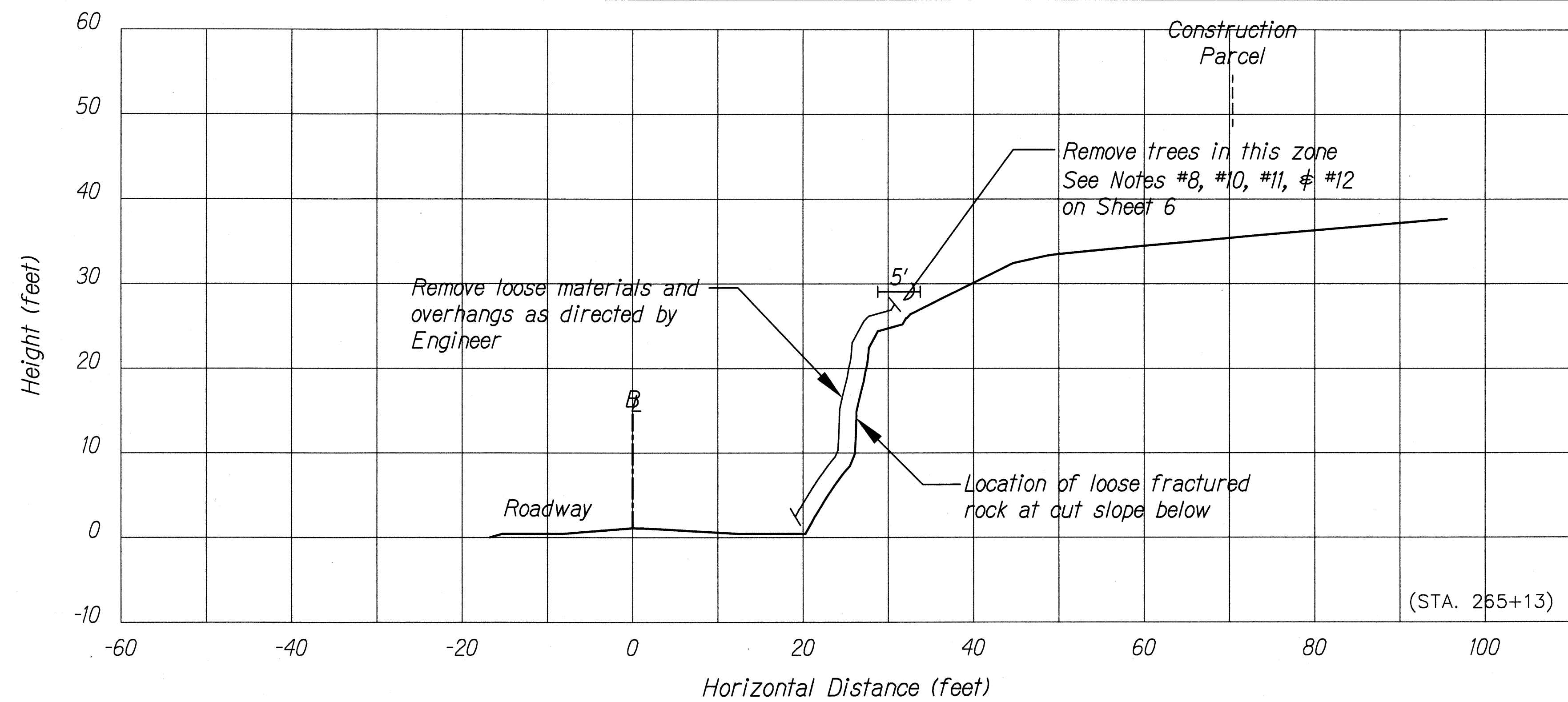

TYPICAL SECTION
Slope Scaling/Trimming
Sta. 263+90 Through Sta. 265+90

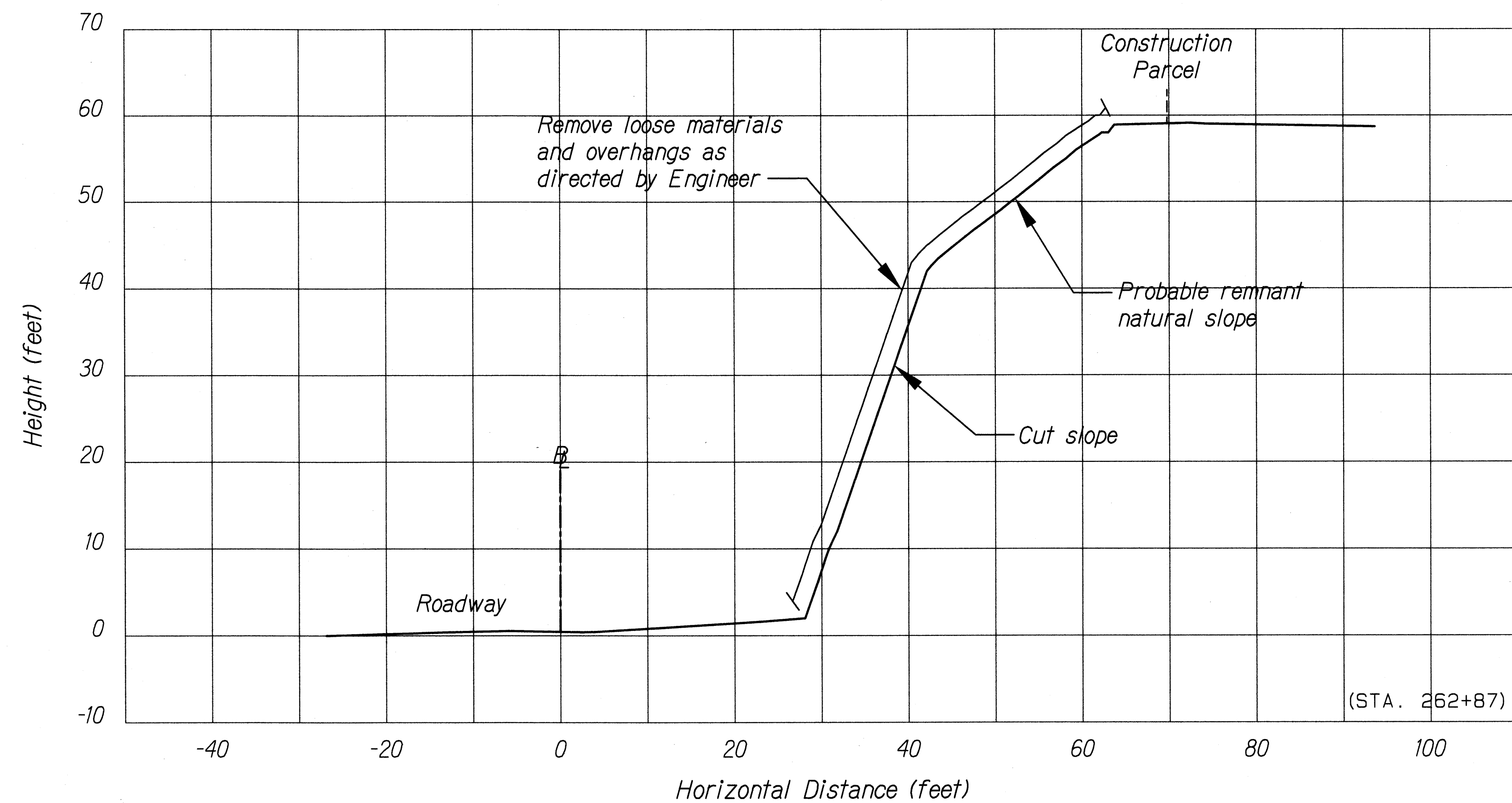

TYPICAL SECTION
Slope Scaling/Trimming
Sta. 262+52 Through Sta. 263+90

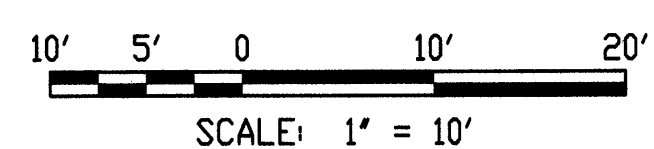

STATE OF HAWAII
DEPARTMENT OF TRANSPORTATION
HIGHWAYS DIVISION

TYPICAL SECTIONS - SITE 6

EMERGENCY EARTHQUAKE ROCKFALL REPAIRS
Various Locations on Hawaii, Unit 1
Federal Aid Project No. ER-15(19)

Scale: AS NOTED Date: December 18, 2009
SHEET No. G-6.2 OF 6 SHEETS

SURVEY PLOTTED BY	DATE
DRAWN BY	
DESIGNED BY	
QUANTITIES BY	
CHECKED BY	
ORIGINAL PLAN	
NOTE BOOK	
No.	

FED. ROAD DIST. NO.	STATE	FED. AID PROJ. NO.	FISCAL YEAR	SHEET NO.	TOTAL SHEETS
HAWAII	HAW.	ER-15(19)	2009	48	59

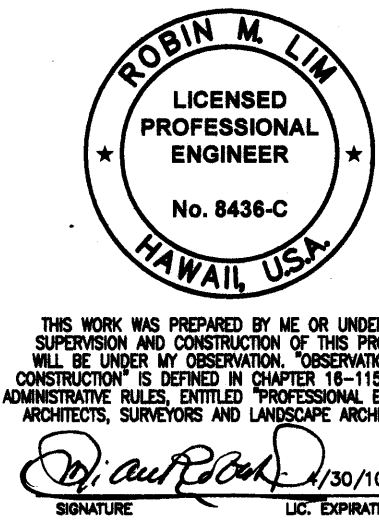
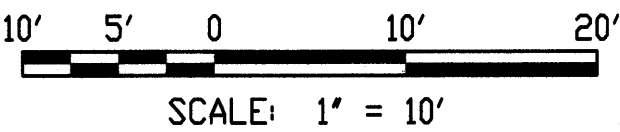
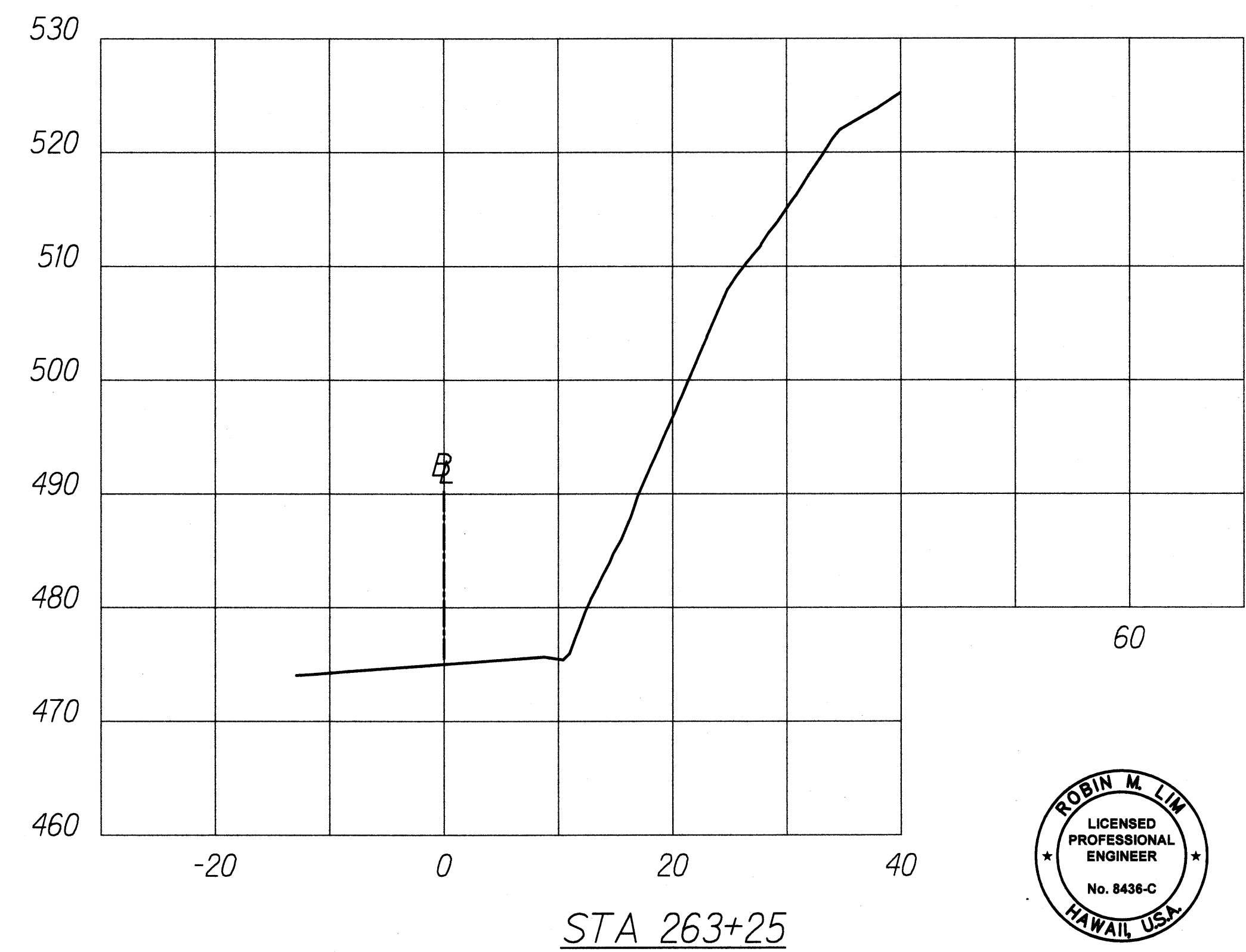
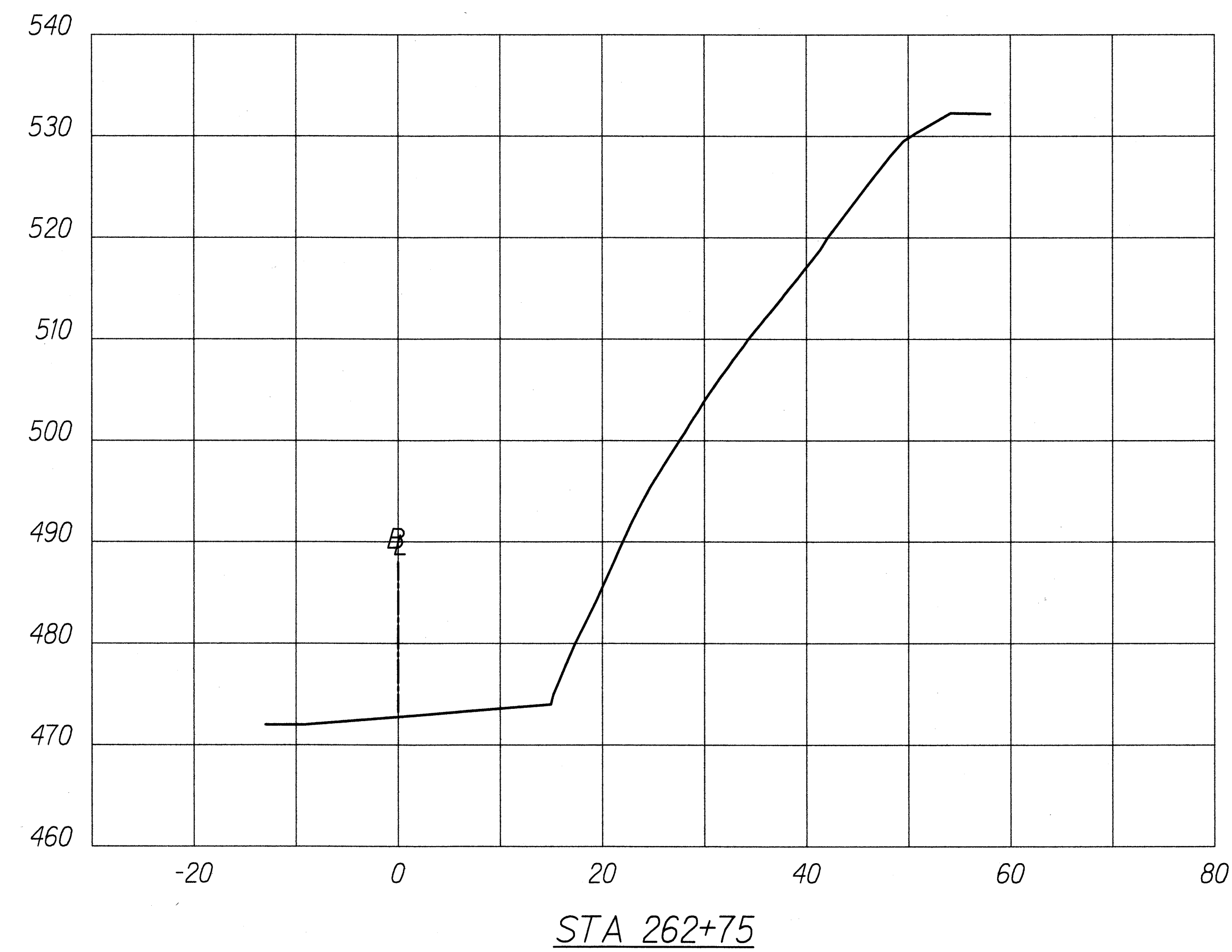
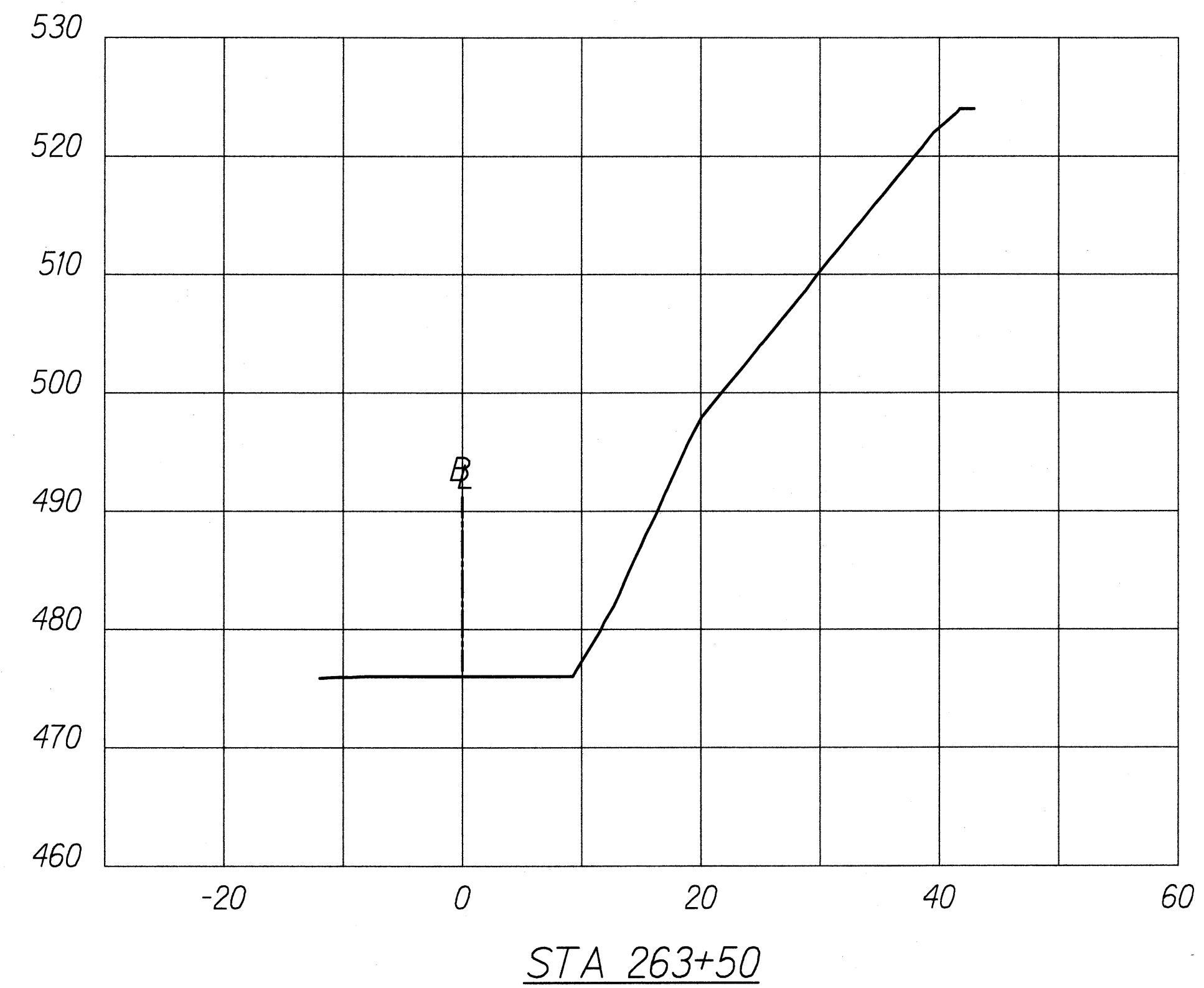
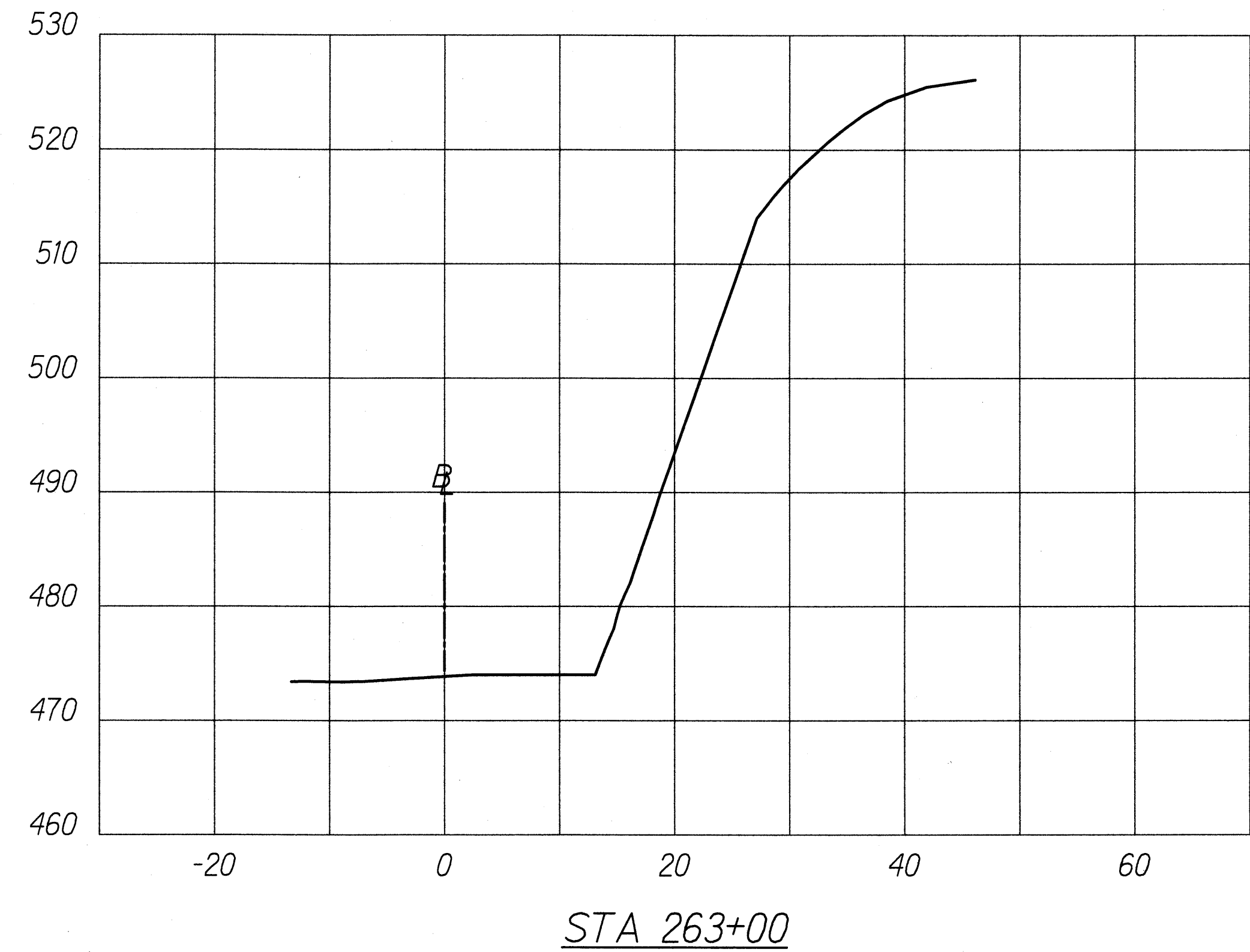

STATE OF HAWAII
DEPARTMENT OF TRANSPORTATION
HIGHWAYS DIVISION
CROSS SECTIONS
EMERGENCY EARTHQUAKE ROCKFALL REPAIRS
Various Locations on Hawaii, Unit 1
Federal Aid Project No. ER-15(19)
Scale: AS NOTED Date: December 18, 2009
SHEET No. G-6.3 OF 6 SHEETS

ORIGINAL PLAN	SURVEY PLOTTED BY	DATE
	DESIGNED BY	
NOTE BOOK	QUANTITIES BY	
No.	CHECKED BY	

FED. ROAD DIST. NO.	STATE	FED. AID PROJ. NO.	FISCAL YEAR	SHEET NO.	TOTAL SHEETS
HAWAII	HAW.	ER-15(19)	2009	49	59

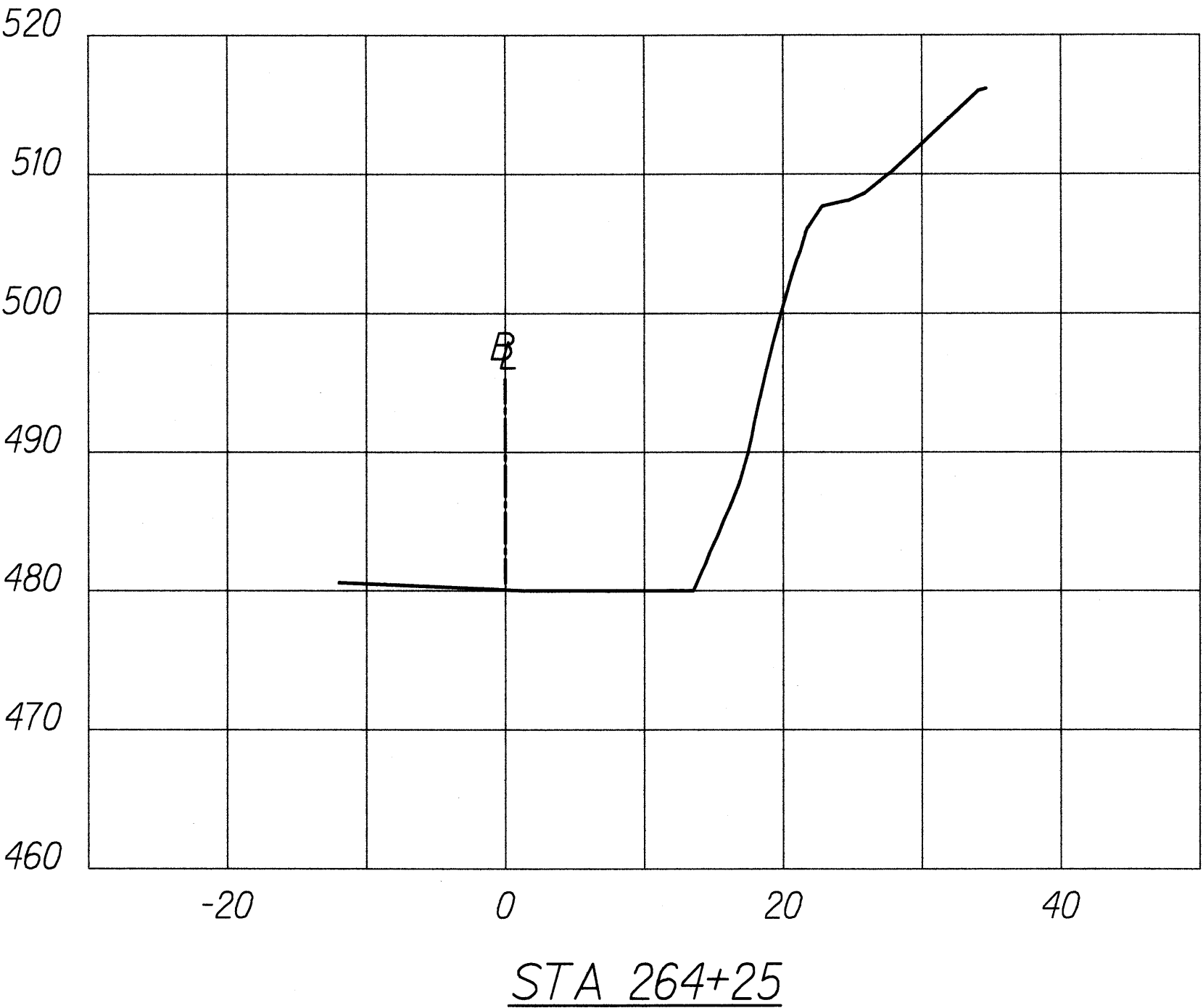
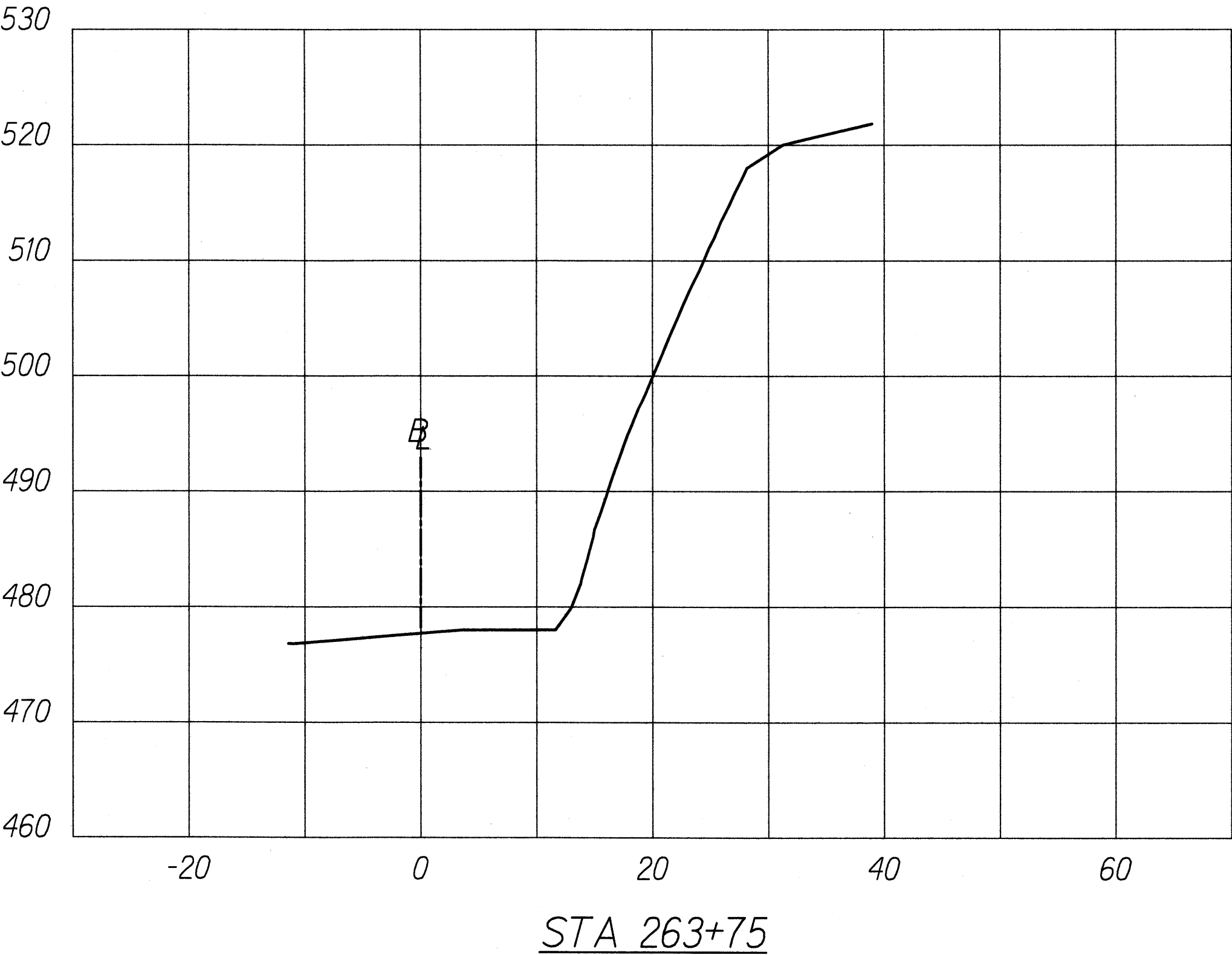
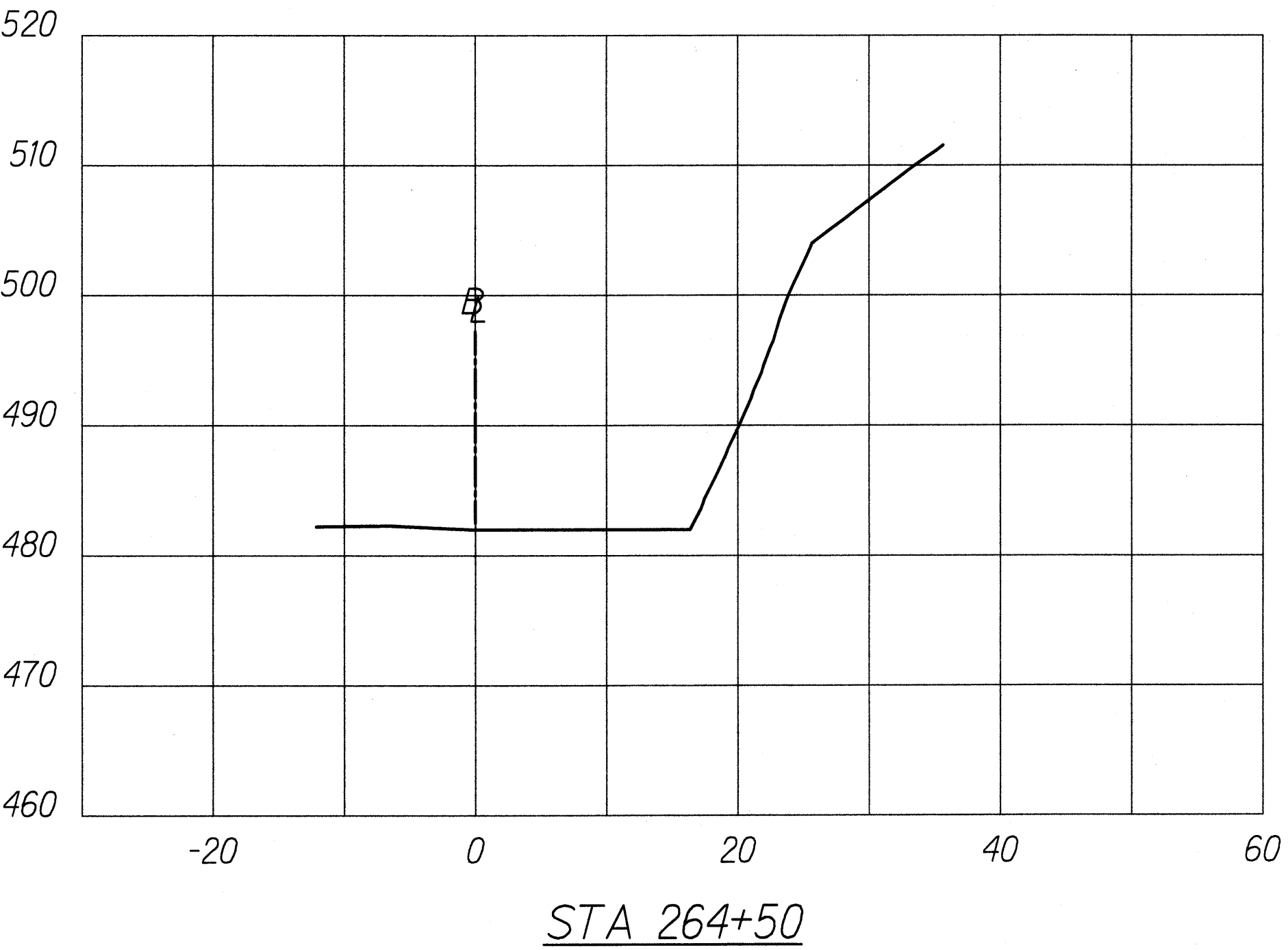
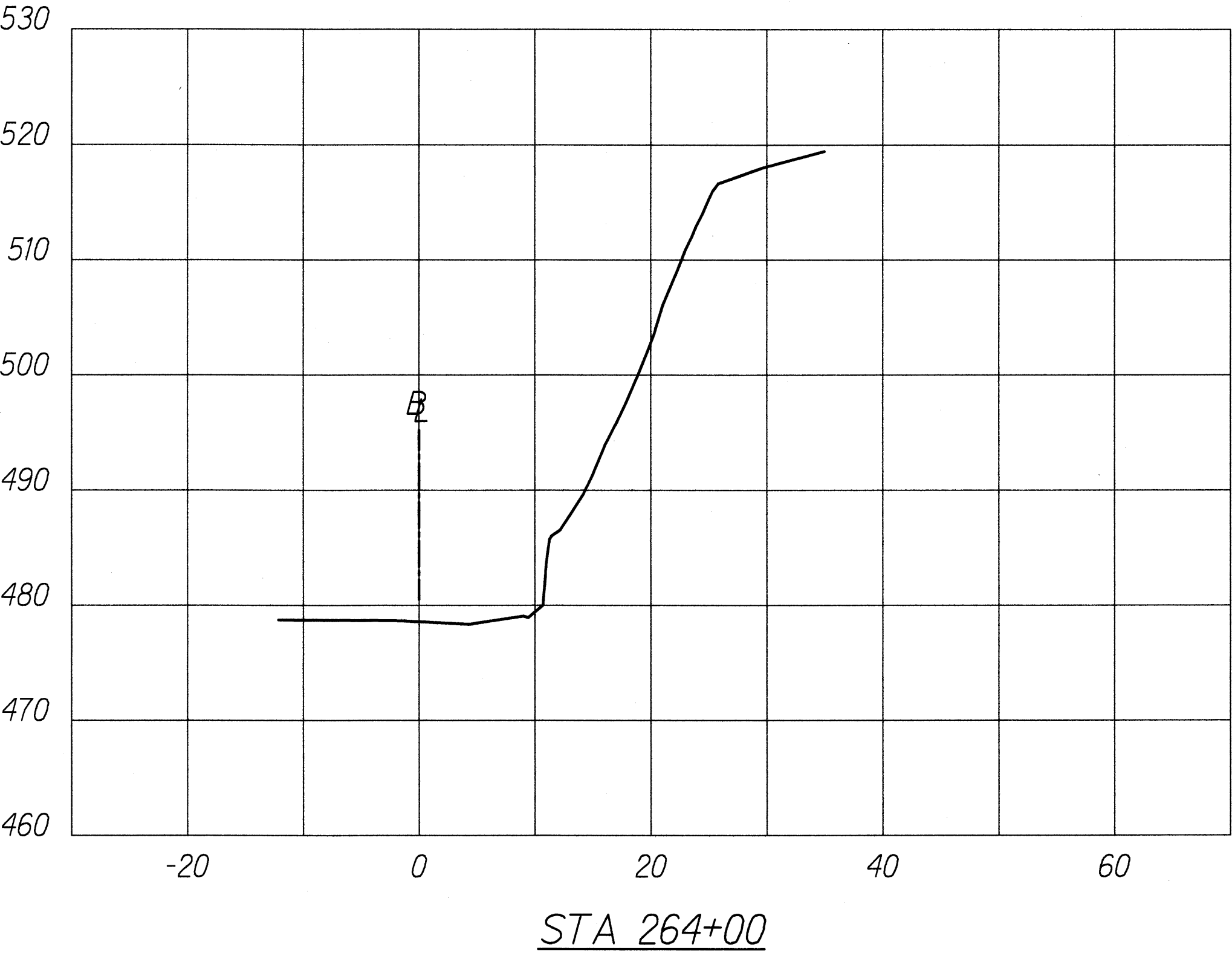

SURVEY PLOTTED BY	DATE
DESIGNED BY	
TRACED BY	
NOTE BOOK	
DESIGNED BY	
QUANTITIES BY	
CHECKED BY	
No.	

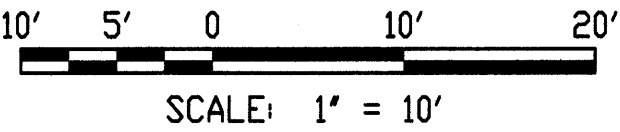

ROBIN M. LIM
 LICENSED
 PROFESSIONAL
 ENGINEER
 No. 8436-C
 HAWAII, USA

THIS WORK WAS PREPARED BY ME OR UNDER MY SUPERVISION AND CONSTRUCTION OF THIS PROJECT WILL BE UNDER MY OBSERVATION. OBSERVATION OF CONSTRUCTION IS DEFINED IN CHAPTER 16-115, HAWAII ADMINISTRATIVE RULES, ENTITLED "PROFESSIONAL ENGINEERS, ARCHITECTS, SURVEYORS AND LANDSCAPE ARCHITECTS."

SIGNATURE: *[Signature]* LIC. EXPIRATION: 4/30/10
 GEOLABS, INC.

STATE OF HAWAII
 DEPARTMENT OF TRANSPORTATION
 HIGHWAYS DIVISION
CROSS SECTIONS
 EMERGENCY EARTHQUAKE ROCKFALL REPAIRS
 Various Locations on Hawaii, Unit 1
 Federal Aid Project No. ER-15(19)
 Scale: AS NOTED Date: December 18, 2009
 SHEET No. G-6.4 OF 6 SHEETS

FED. ROAD DIST. NO.	STATE	FED. AID PROJ. NO.	FISCAL YEAR	SHEET NO.	TOTAL SHEETS
HAWAII	HAW.	ER-15(19)	2009	50	59

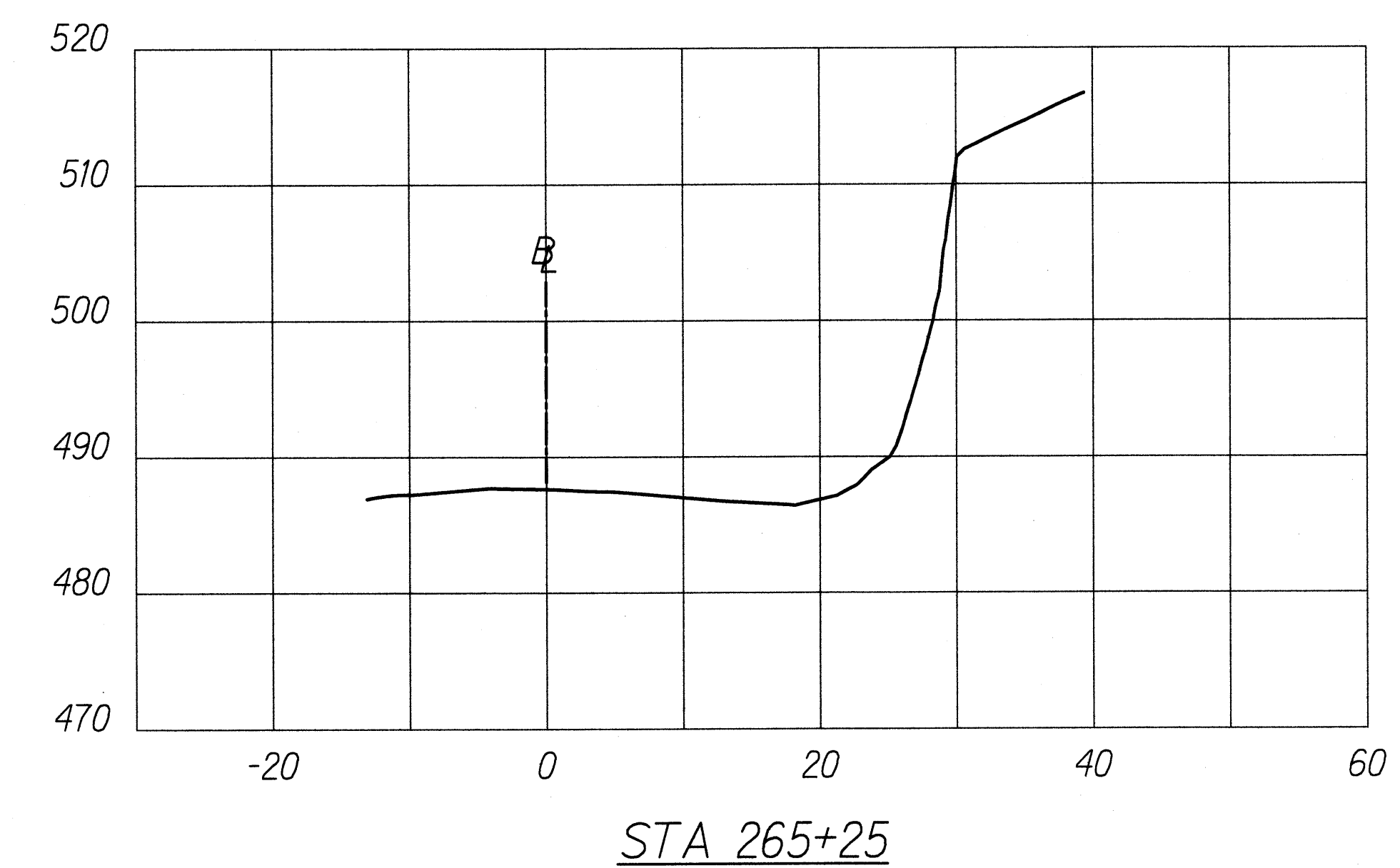
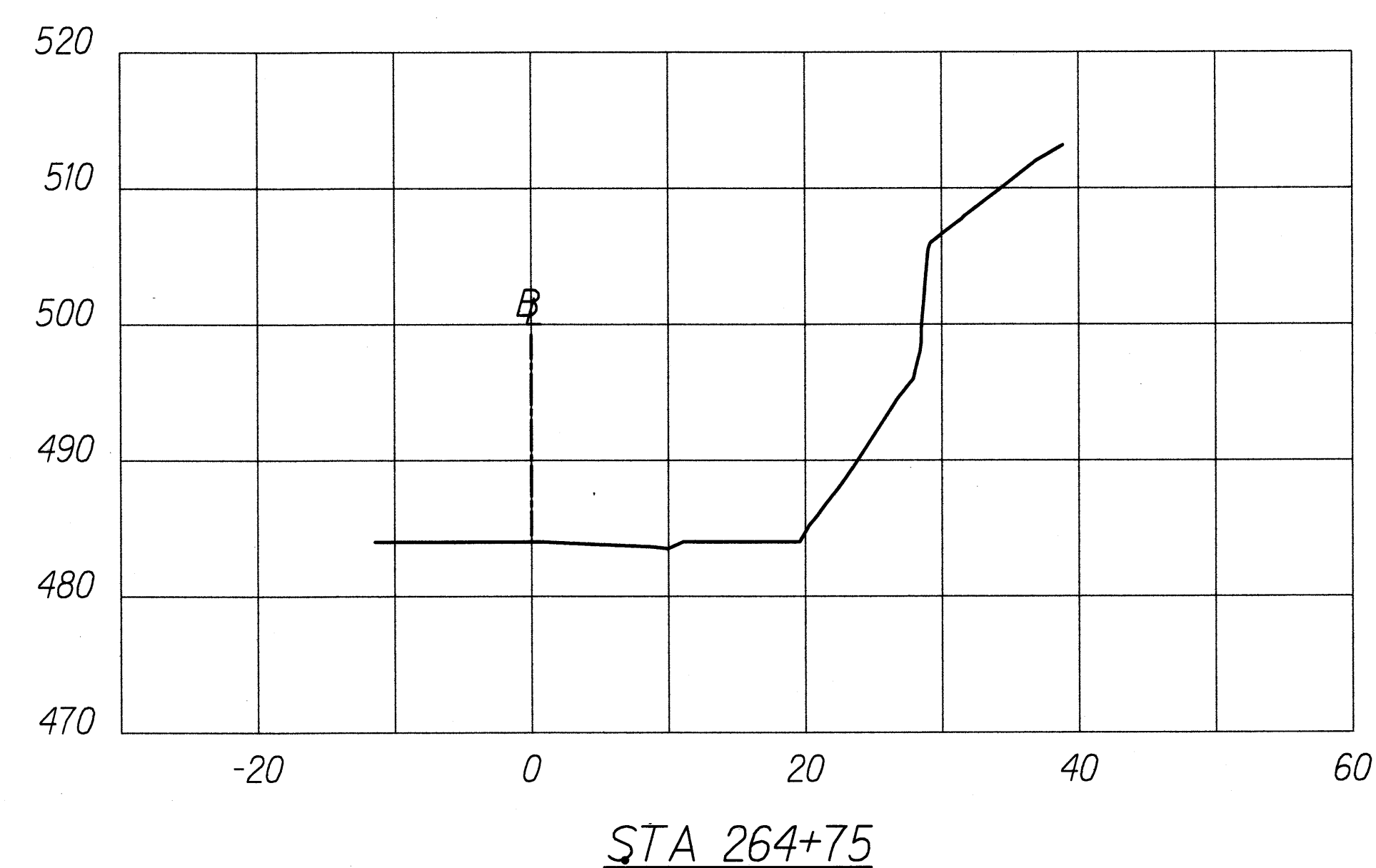
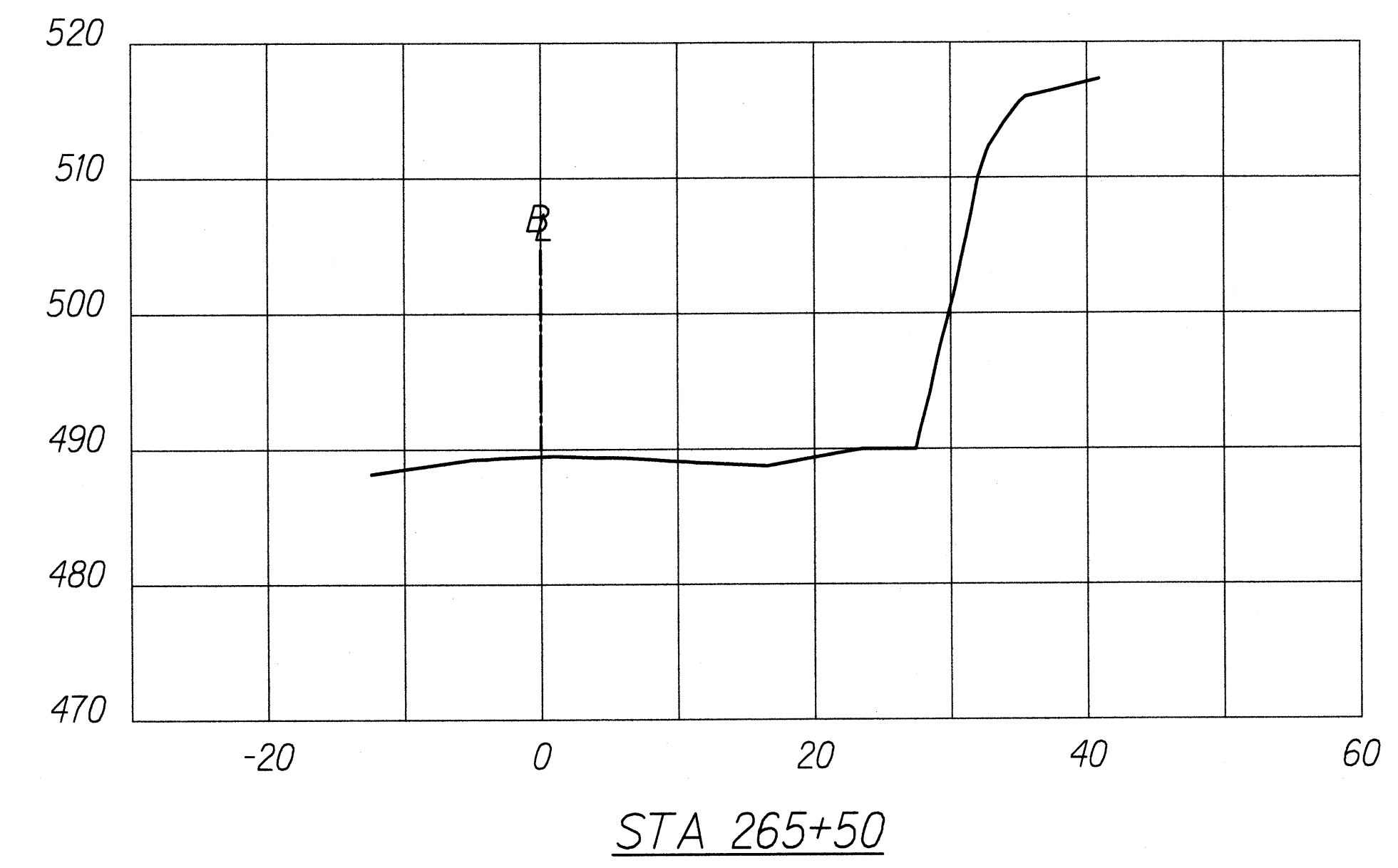
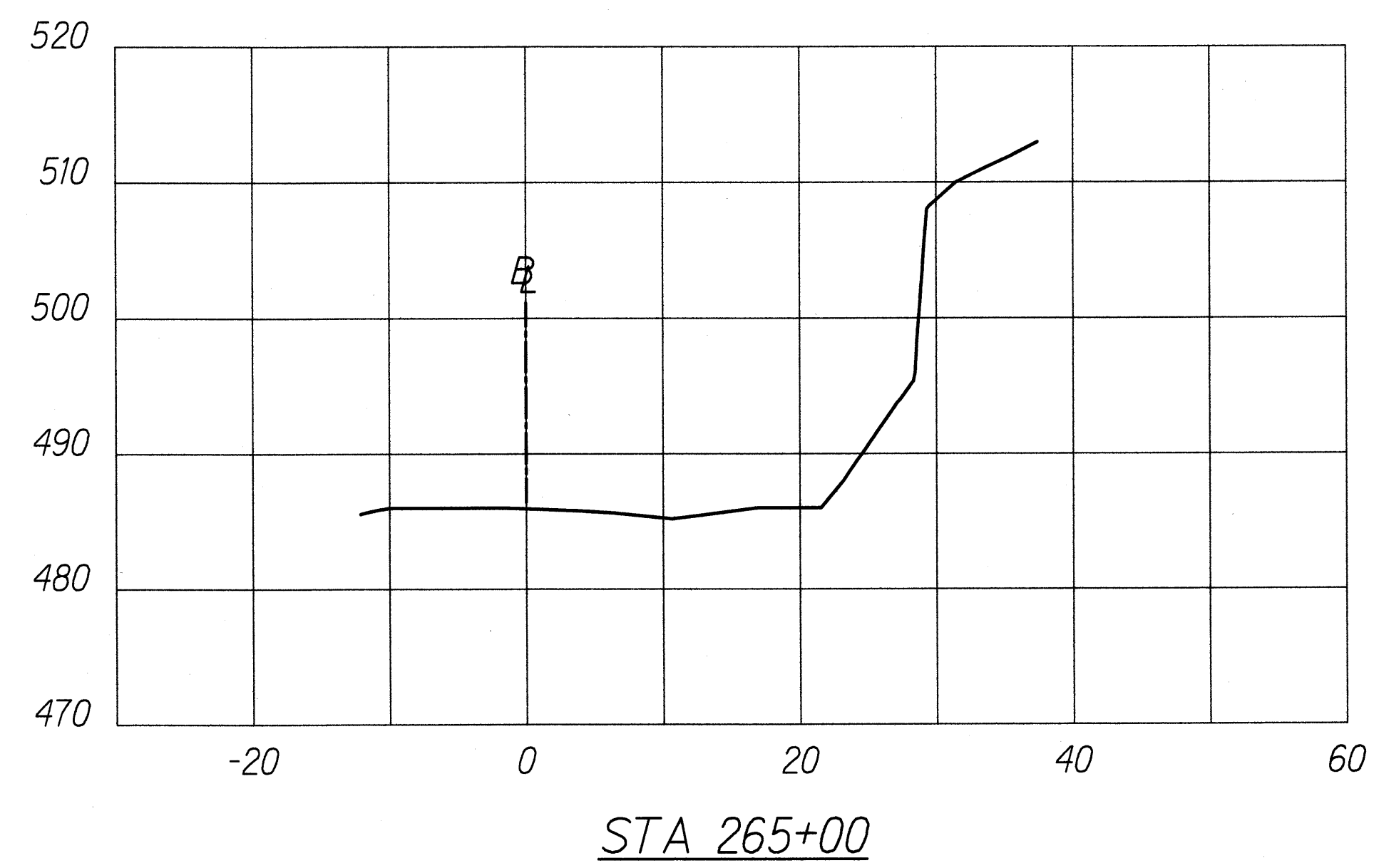

ORIGINAL PLAN	DATE
DESIGNED BY	DESIGNED BY
NOTED BY	NOTED BY
CHECKED BY	CHECKED BY
NO.	NO.

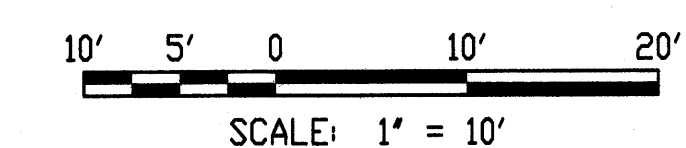

THIS WORK WAS PREPARED BY ME OR UNDER MY SUPERVISION AND CONSTRUCTION OF THIS PROJECT WILL BE UNDER MY OBSERVATION. OBSERVATION OF CONSTRUCTION IS DEFINED IN CHAPTER 15-115, HAWAII ADMINISTRATIVE RULES, ENTITLED "PROFESSIONAL ENGINEERS, ARCHITECTS, SURVEYORS AND LANDSCAPE ARCHITECTS."

SIGNATURE: *[Signature]* 4/30/10
 GEO LABS, INC. LIC. EXPIRATION

STATE OF HAWAII
 DEPARTMENT OF TRANSPORTATION
 HIGHWAYS DIVISION

CROSS SECTIONS

EMERGENCY EARTHQUAKE ROCKFALL REPAIRS

Various Locations on Hawaii, Unit 1

Federal Aid Project No. ER-15(19)

Scale: AS NOTED Date: December 18, 2009

SHEET No. G-6.5 OF 6 SHEETS

50

FED. ROAD DIST. NO.	STATE	FED. AID PROJ. NO.	FISCAL YEAR	SHEET NO.	TOTAL SHEETS
HAWAII	HAW.	ER-15(19)	2009	51	59

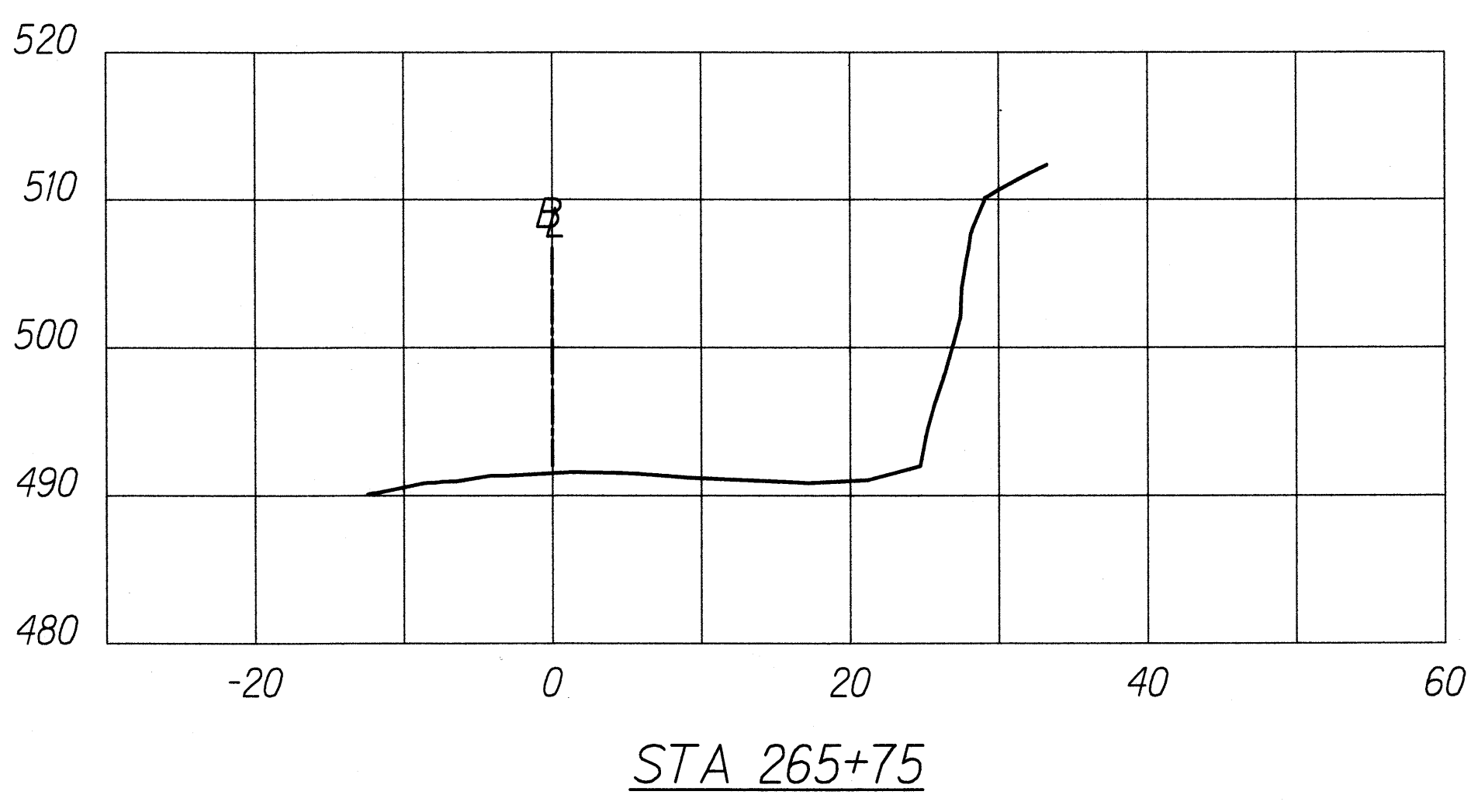
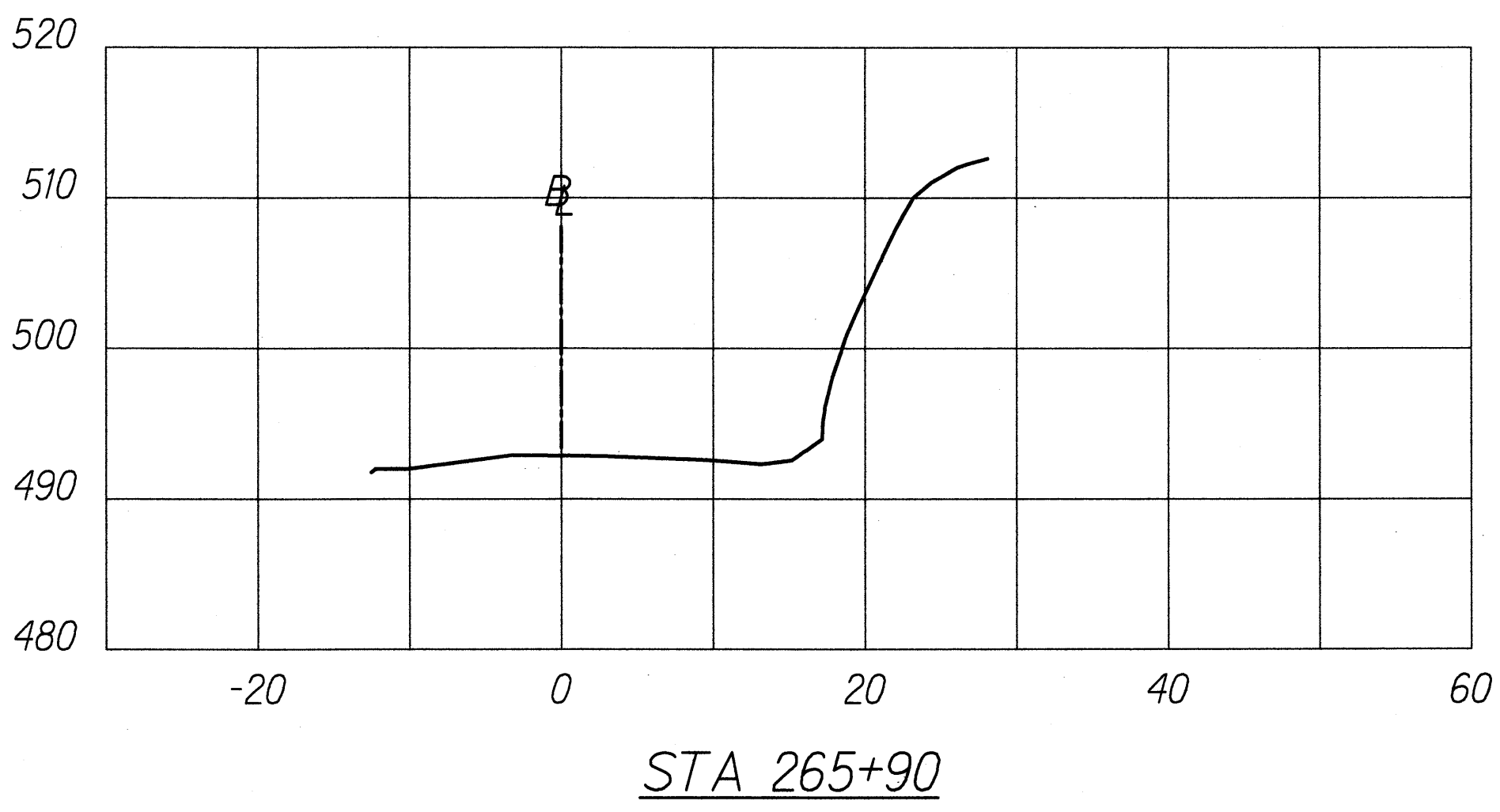

ORIGINAL PLAN	SURVEY PLOTTED BY	DATE
NOTE BOOK	DRAWN BY	
No.	DESIGNED BY	
	QUANTITIES BY	
	CHECKED BY	

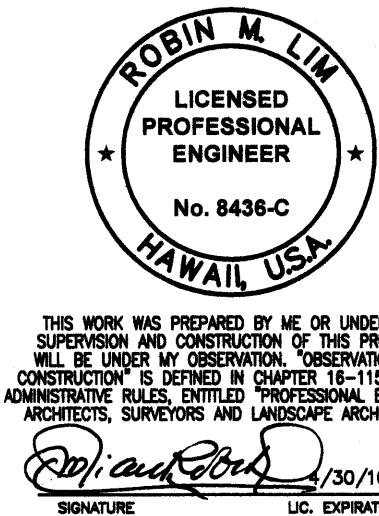
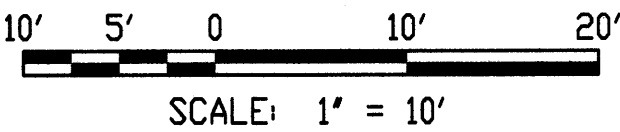

STATE OF HAWAII
DEPARTMENT OF TRANSPORTATION
HIGHWAYS DIVISION

CROSS SECTIONS

EMERGENCY EARTHQUAKE ROCKFALL REPAIRS
Various Locations on Hawaii, Unit 1
Federal Aid Project No. ER-15(19)
Scale: AS NOTED Date: December 18, 2009
SHEET No. G-6.6 OF 6 SHEETS