

FED. ROAD DIST. NO.	STATE	FED. AID PROJ. NO.	FISCAL YEAR	SHEET NO.	TOTAL SHEETS
HAWAII	HAW.	ER-15(19)	2009	20	59

TRUE NORTH
SCALE: 1 in. = 20 ft.

T.M.K.: 6-5-01: 33

NOTES:

- Survey conducted by Imata and Associates, Inc. dated December 2008.
- All property azimuths shown were adjusted to match construction plan azimuths.
- Baseline stations shown as "(field)" are nails staked by others and stations are painted on pavement. Construction plan stations were calculated for those nails found and noted as "(const. plan)".
- Elevations were assumed.
- Underground utilities shown are for information only. Contractor shall be responsible to verify prior to construction.
- Contractor shall sawcut existing A.C. pavement prior to removal.
- Contractor shall remove and relocate sign post anchors with sign relocations.

LEGEND:

- B-1
Approx. Boring Location
- AC Pavement and Base Removal (Exact Location and Limits To Be Determined By Engineer In Field)
- Temporary Silt Fence

Demolition And Erosion Control Plan - Site 1

Scale: 1" = 20'

GRAPHICAL SCALE:

20' 10' 0 20' 40'
SCALE: 1" = 20'

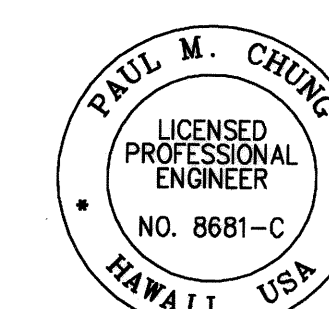

THIS WORK WAS PREPARED BY ME OR UNDER MY SUPERVISION

SIGNATURE

04/30/10
EXPIRATION DATE OF THE LICENSE

STATE OF HAWAII
DEPARTMENT OF TRANSPORTATION
HIGHWAYS DIVISION

DEMOLITION AND EROSION CONTROL PLAN - SITE 1

EMERGENCY EARTHQUAKE ROCKFALL REPAIRS
Various Locations on Hawaii, Unit 1
Federal Aid Project No. ER-15(19)

Scale: AS NOTED Date: Dec. 18, 2009

SHEET No. C-1/I OF 3 SHEETS

FED. ROAD DIST. NO.	STATE	FED. AID PROJ. NO.	FISCAL YEAR	SHEET NO.	TOTAL SHEETS
HAWAII	HAW.	ER-15(19)	2009	21R	59

TRUE NORTH
SCALE: 1 in. = 20 ft.

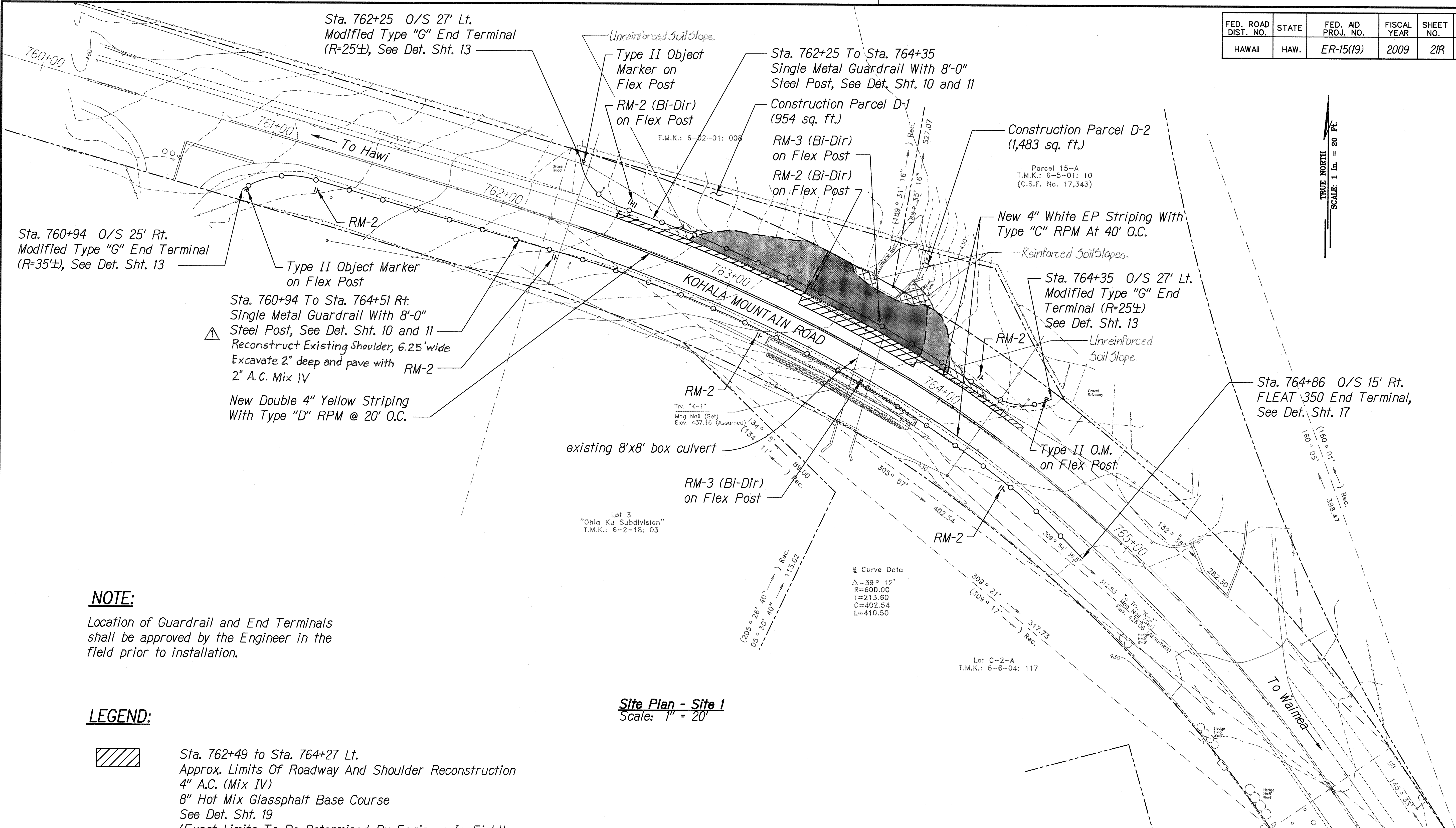

NOTE:
Location of Guardrail and End Terminals shall be approved by the Engineer in the field prior to installation.

- LEGEND:**
- Sta. 762+49 to Sta. 764+27 Lt.
Approx. Limits Of Roadway And Shoulder Reconstruction
4" A.C. (Mix IV)
8" Hot Mix Glassphalt Base Course
See Det. Sht. 19
(Exact Limits To Be Determined By Engineer In Field)
 - Approx. Limits Of Unreinforced Soil Slopes
See Det. Sht. 19
(Exact Limits To Be Determined By Engineer In Field)
 - Sta. 763+30 to Sta. 763+84 Lt.
Approx. Limits Of Reinforced Soil Slopes
See Det. Sht. 19
(Exact Limits To Be Determined By Engineer In Field)

Site Plan - Site 1
Scale: 1" = 20'

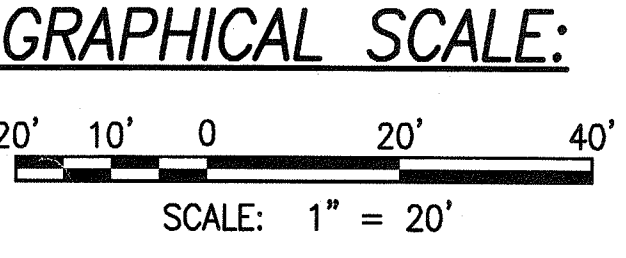

3/18/10	Added note to Sta. 760+94 to 764+51 per Addendum 4
DATE	REVISION

PAUL M. CHUNG
LICENSED PROFESSIONAL ENGINEER
NO. 8681-C
HAWAII, USA

THIS WORK WAS PREPARED BY ME OR UNDER MY SUPERVISION

SIGNATURE: EXPIRATION DATE OF THE LICENSE: 04/30/10

STATE OF HAWAII
DEPARTMENT OF TRANSPORTATION
HIGHWAYS DIVISION

SITE PLAN - SITE 1

EMERGENCY EARTHQUAKE ROCKFALL REPAIRS
Various Locations on Hawaii, Unit 1
Federal Aid Project No. ER-15(19)

Scale: AS NOTED Date: Dec. 18, 2009
SHEET No. C-1.2 OF 3 SHEETS

SURVEY PLOTTED BY	DATE
DRAWN BY	
DESIGNED BY	
CHECKED BY	
NO.	

W:\CIVIL 3D PROJECTS\2008_116_000 DOT EMERGENCY EQ REPAIRS\C-1.2 SITE PLAN - SITE 1.DWG 12/28/2009 11:08 AM ELUMBANG

"AS-BUILT"

FED. ROAD DIST. NO.	STATE	FED. AID PROJ. NO.	FISCAL YEAR	SHEET NO.	TOTAL SHEETS
HAWAII	HAW.	ER-15(19)	2009	22	59

NOTES:

- Contractor shall use same traffic control for work on the makai (south) lane by mirroring in the opposite direction.
- Contractor to provide access to existing driveways at all times.
- One lane closure traffic control plan shall be used for working hours only. Contractor shall provide a rideable surface and restore two lanes of traffic at the end of work day.
- Contractor shall coordinate with the State in the event that two (2) lanes of traffic cannot be met.
- Contractor to submit to Engineer for approval the detour Traffic Control Plans for non-working hours. Refer to Section 645 of the Special Provisions.

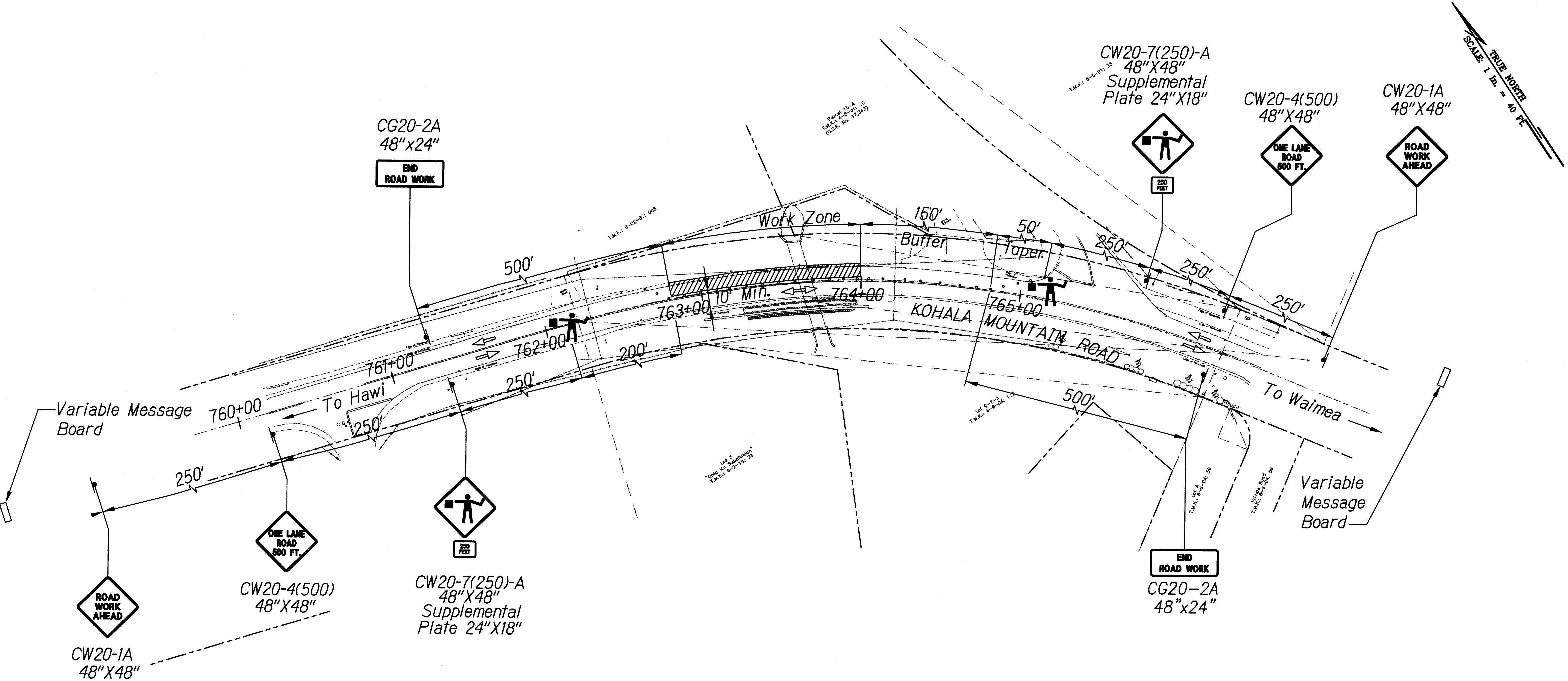

TRAFFIC CONTROL LEGEND:

- Variable Message Board
- Sign
- Direction Of Traffic
- Cone Or Delineator
- Work Area
- Police Officer or Flagman

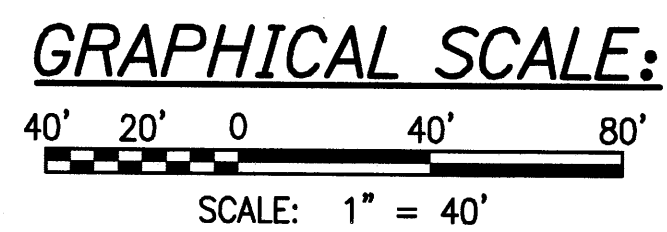

One Lane Closure - Site 1
Scale: 1" = 40'

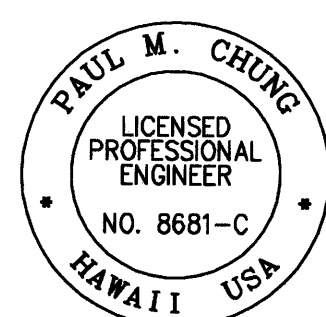

THIS WORK WAS PREPARED BY ME OR UNDER MY SUPERVISION

SIGNATURE: [Signature] EXPIRATION DATE OF THE LICENSE: 04/30/10

STATE OF HAWAII
DEPARTMENT OF TRANSPORTATION
HIGHWAYS DIVISION

TRAFFIC CONTROL PLAN - SITE 1

EMERGENCY EARTHQUAKE ROCKFALL REPAIRS

Various Locations on Hawaii, Unit 1
Federal Aid Project No. ER-15(19)

Scale: AS NOTED Date: Dec. 18, 2009

SHEET No. C-13 OF 3 SHEETS