

PER ROAD DIST NO.	STATE	PROJ. NO.	FISCAL YEAR	SHEET NO.	TOTAL SHEETS
HAWAII	HAW	N-11-01-64	1964	3	8

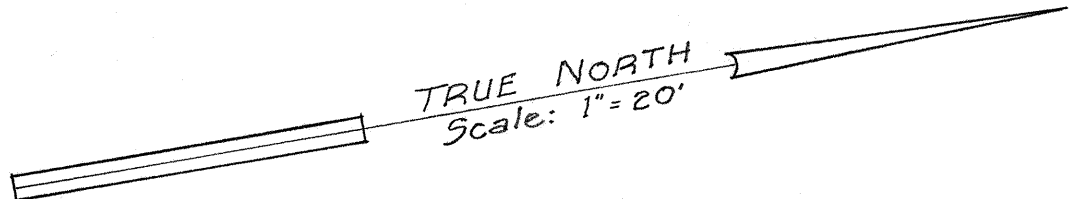

Sta. 5+50 to 7+00 Left
Construct smooth and easy riding connection to existing pavement.

Proposed Water Line to be done by others. (See Panaewa Residence Lots, Unit I Plan)

GENERAL NOTES:

Existing regulatory and warning signs to be relocated as directed by the Engineer.

Sta. 1348 + 63.67 RT.

Extend 32 lin. ft. of 36" Class IV Reinf. Circ. Conc. Pipe Culvert.
Construct 1 Conc. Headwall.
Est. Quantities:
Struct. Exc. = 27 c.y.
Class B-1 Conc. = 2.8 c.y.
Reinf. Steel = 60 lbs.

EDGE PAV'T. CURVE DATA

$\Delta = 98^{\circ}06'33"$
 $\Delta e = 49^{\circ}03'17"$
 $D = 47^{\circ}45'$
 $R = 120.00$
 $T = 138.31$
 $E = 63.11$
 $Lc = 205.48$

LEGEND

- 77.29 Denotes finish grade.
- Denotes opening on A.C. Traffic Roll Curb.

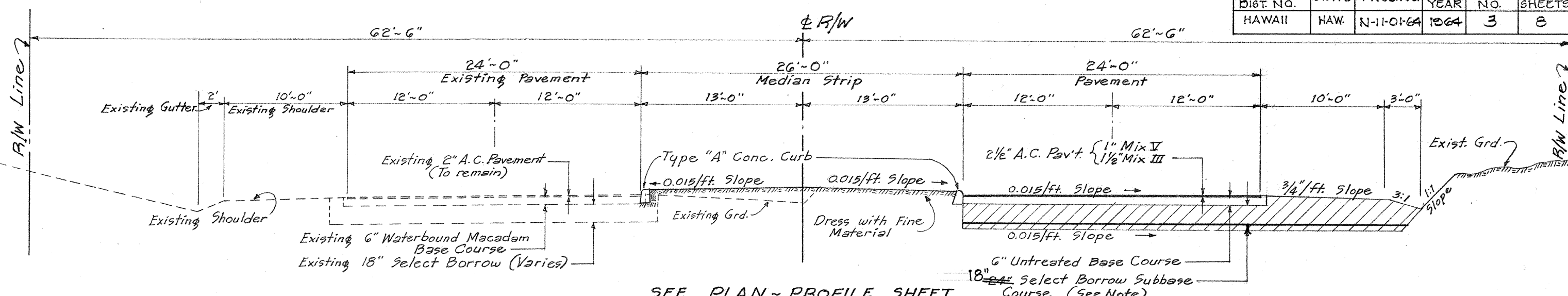

SEE PLAN - PROFILE SHEET SECTION "A-A"
Scale: 1/8" = 1'-0"

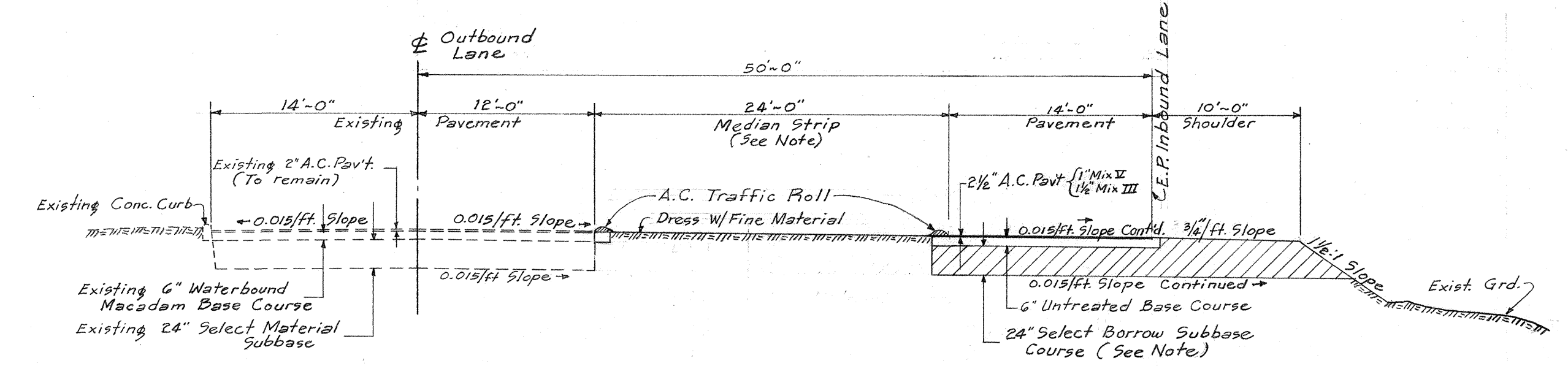

SECTION "B-B"
Scale: 1/8" = 1'-0"

NOTE:
1. Select Borrow Subbase Course shall be used where unsuitable material is encountered at subgrade or as directed by the Engineer.
2. Existing Pavement on Kanoelehua Median Strip shall remain.

Sta. 1351 + 88
Install 100 lin. ft. 24" Class IV Reinf. Circ. Conc. Pipe Culvert w/Conc. Collars.
1 - Type "D" Catch Basin 1 - Conc. Headwall
Est. Quantities:
Struct. Exc. = 76 c.y.
Class A-1 Conc. = 5 c.y.
Class B-1 Conc. = 1.4 c.y.
Reinf. Steel = 119 lbs.

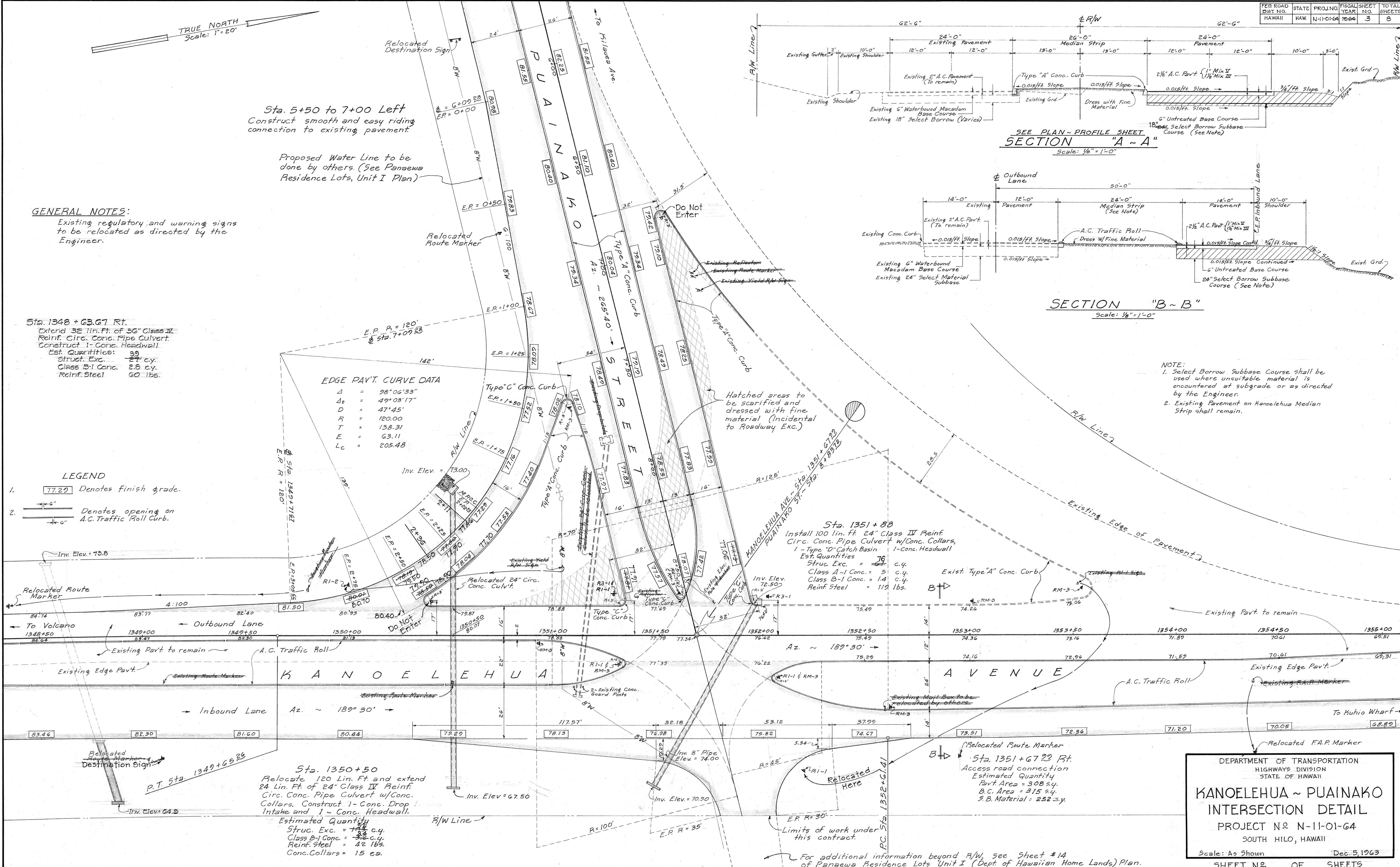

Sta. 1350 + 50
Relocate 120 Lin. Ft. and extend 24 Lin. Ft. of 24" Class IV Reinf. Circ. Conc. Pipe Culvert w/Conc. Collars. Construct 1 Conc. Drop Intake and 1 Conc. Headwall.
Estimated Quantities:
Struct. Exc. = 74 c.y.
Class B-1 Conc. = 3 c.y.
Reinf. Steel = 42 lbs.
Conc. Collars = 15 ea.

Sta. 1351 + 67.29 Rt.
Access road connection
Estimated Quantity
Pav't Area = 308 sq. y.
B.C. Area = 315 sq. y.
S.B. Material = 252 sq. y.

For additional information beyond R/W, see Sheet # 14 of Panaewa Residence Lots Unit I (Dept. of Hawaiian Home Lands) Plan.

DEPARTMENT OF TRANSPORTATION
HIGHWAYS DIVISION
STATE OF HAWAII

**KANOELEHUA ~ PUAINAKO
INTERSECTION DETAIL**

PROJECT NO. N-11-01-64
SOUTH HILO, HAWAII

Scale: As Shown Dec. 5, 1963

SHEET NO. 3 OF 8 SHEETS