

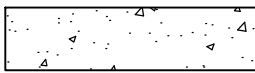

LEGEND:

-  NEW AC PAVEMENT
-  NEW PCC PAVEMENT
-  PCC JOINT TYPE

NOTE:

1. PRIOR TO DEMOLITION, CONTRACTOR SHALL SURVEY THE EXISTING PAVEMENT TO DETERMINE ELEVATION AND GRADE AND SUBMIT TO THE RPR. NEW PAVEMENT SHALL MATCH EXISTING ELEVATION AND GRADE AS APPROVED BY THE RPR.
2. SEE PAVING DETAILS SHEET FOR JOINT TYPE DETAILS.
3. AT CONNECTION TO EXISTING PCC, NEW DOWELS SHALL BE SPACED AT 18" OC AND LOCATED AT LEAST 6" AWAY FROM EXISTING DOWELS.

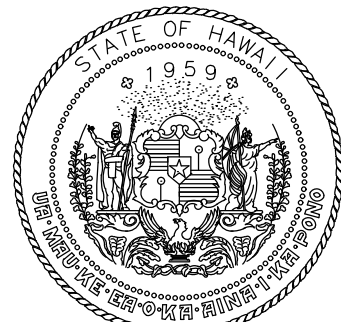

Airports Division  
DEPARTMENT OF TRANSPORTATION  
STATE OF HAWAII



I HEREBY CERTIFY THAT THIS WORK  
WAS PREPARED BY ME OR UNDER MY  
SUPERVISION

Signature:  4/30/24  
Expiration Date

DSGN.	DRWN.	CHKD.	APPD.
AC	AT	TR	SH

KEY PLAN / NOTES:



NO.	DATE	REVISIONS
-----	------	-----------

CONSTRUCTION  
DOCUMENTS  
SEPTEMBER 23, 2022  
DATE

PROJECT TITLE :

APRON IMPROVEMENTS

AT  
ELLISON ONIZUKA  
KONA INTERNATIONAL AIRPORT AT KEAHOLE  
KAILUA-KONA, HAWAII

PROJECT NO.:

AH2023-17

SHEET TITLE:

PAVING LAYOUT PLAN  
1

DATE :
09/23/2022
SHEET :
7 OF 12 SHEETS

DWG. NO.

C-103

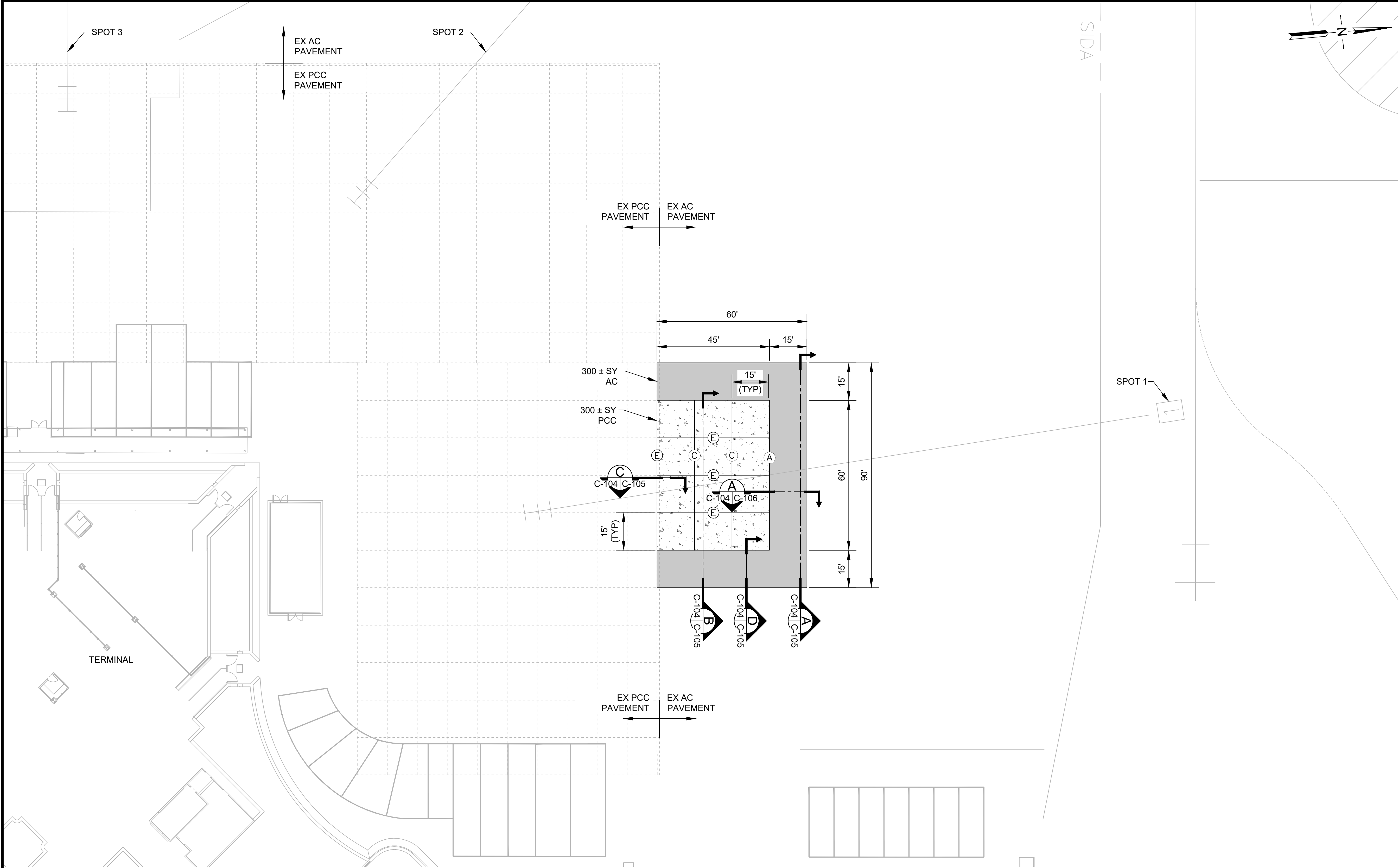

LEGEND:

- NEW AC PAVEMENT
- NEW PCC PAVEMENT
- PCC JOINT TYPE

NOTE:

1. PRIOR TO DEMOLITION, CONTRACTOR SHALL SURVEY THE EXISTING PAVEMENT TO DETERMINE ELEVATION AND GRADE AND SUBMIT TO THE RPR. NEW PAVEMENT SHALL MATCH EXISTING ELEVATION AND GRADE AS APPROVED BY THE RPR.
2. SEE PAVING DETAILS SHEET FOR JOINT TYPE DETAILS.
3. AT CONNECTION TO EXISTING PCC, NEW DOWELS SHALL BE SPACED AT 18" OC AND LOCATED AT LEAST 6" AWAY FROM EXISTING DOWELS.

20' 0 20' 40'  
SCALE: 1" = 20'-0"

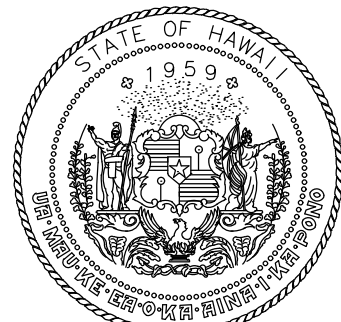

Airports Division  
DEPARTMENT OF TRANSPORTATION  
STATE OF HAWAII



I HEREBY CERTIFY THAT THIS WORK  
WAS PREPARED BY ME OR UNDER MY  
SUPERVISION

Signature: [Signature] 4/30/24  
Expiration Date

DSGN.	DRWN.	CHKD.	APPD.
AC	AT	TR	SH

KEY PLAN / NOTES:



NO.	DATE	REVISIONS
-----	------	-----------

CONSTRUCTION  
DOCUMENTS

SEPTEMBER 23, 2022  
DATE

PROJECT TITLE :

APRON IMPROVEMENTS

AT  
ELLISON ONIZUKA  
KONA INTERNATIONAL AIRPORT AT KEAHOLE  
KAILUA-KONA, HAWAII

PROJECT NO.:

AH2023-17

SHEET TITLE:

PAVING LAYOUT PLAN  
2

DATE :

09/23/2022

SHEET :

8 OF 12 SHEETS

DWG. NO.

C-104