

FED. ROAD DIST. NO.	STATE	PROJ. NO.	FISCAL YEAR	SHEET NO.	TOTAL SHEETS
HAWAII	HAW.	HWY-H-05-96M	1997	2	4

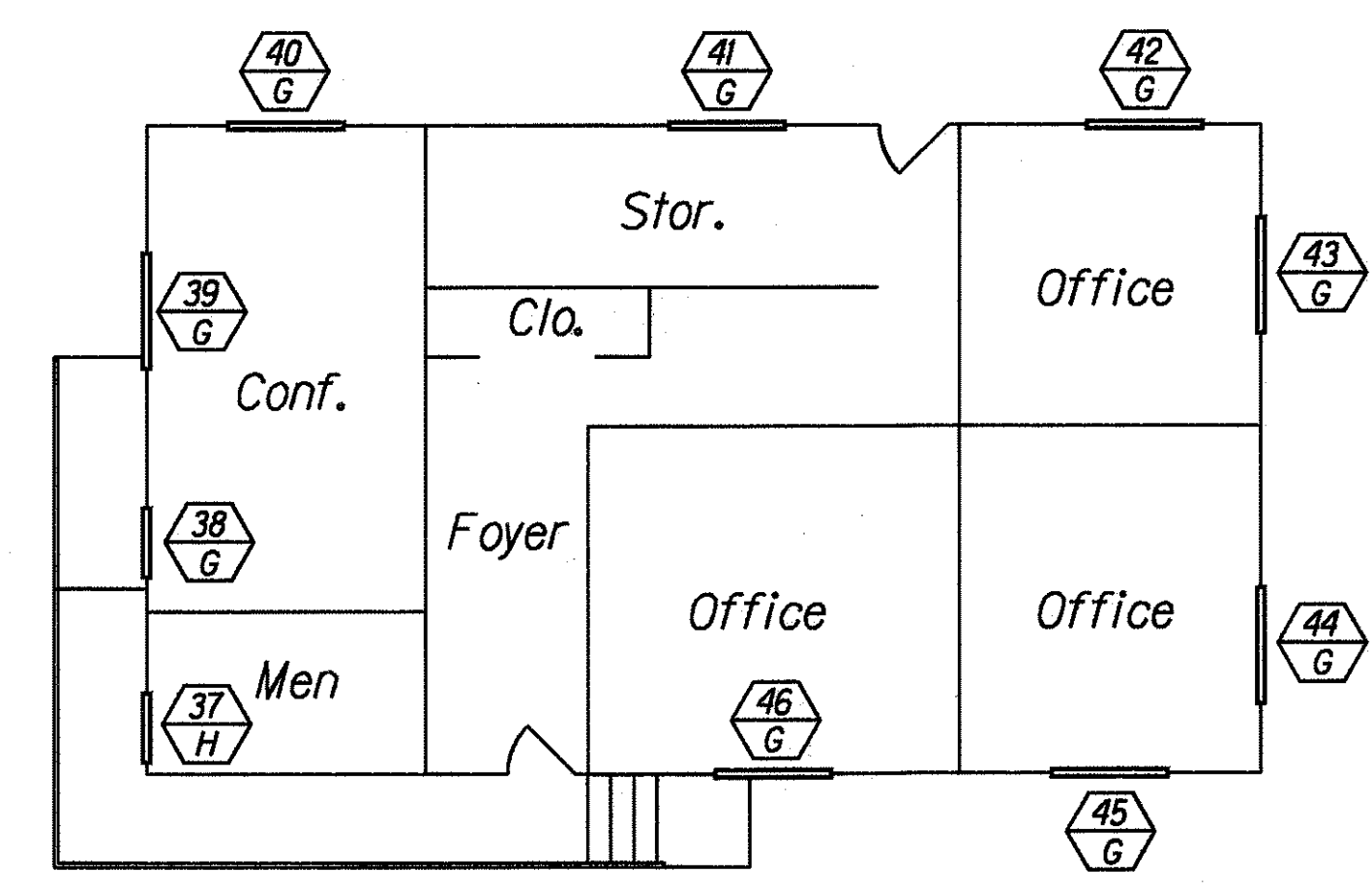
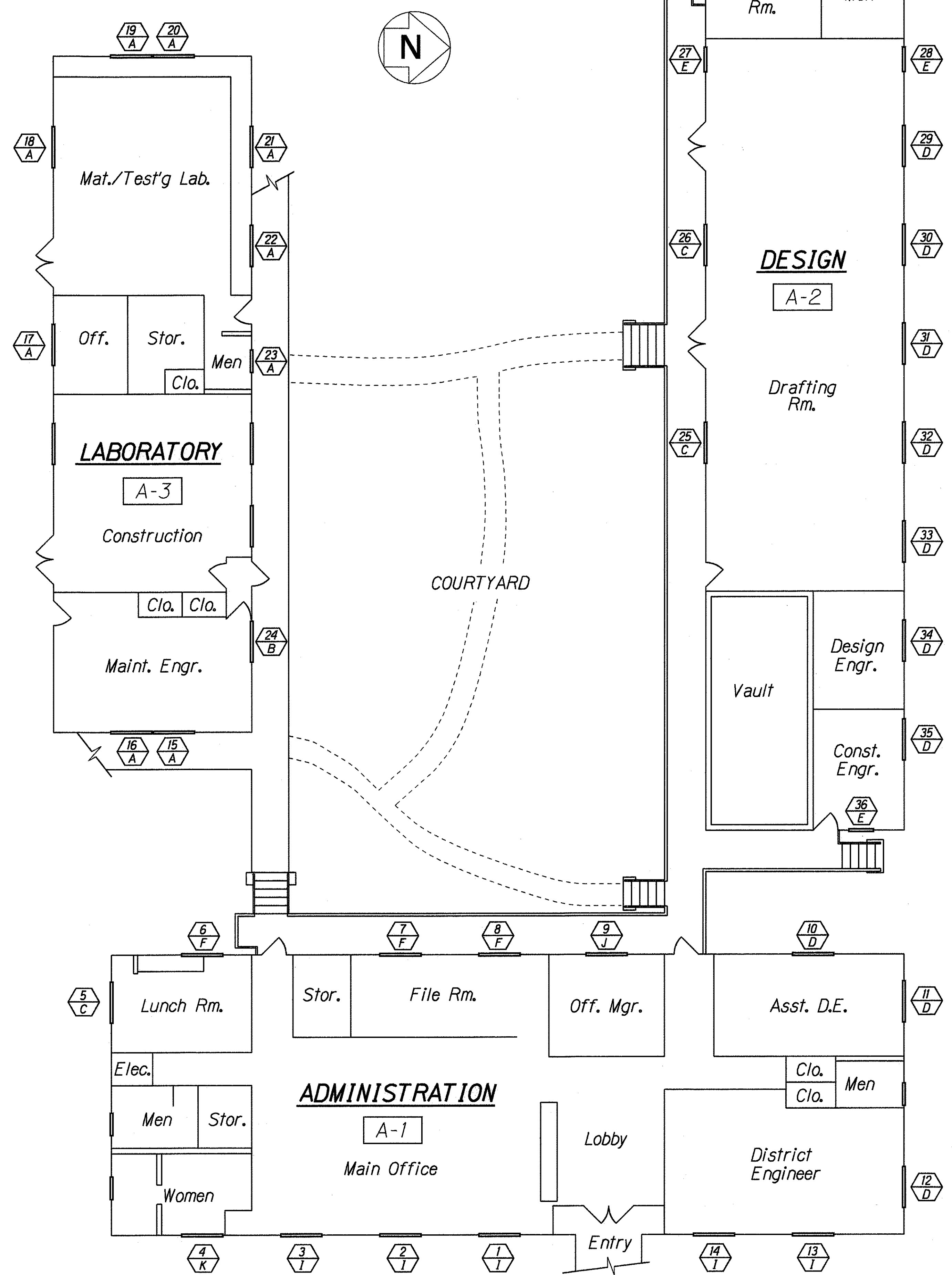

FLOOR PLAN BLDG. "D"
 Scale: 1/8" = 1'-0"

GENERAL NOTES

1. This project consists of furnishing and delivering windows with hardware for the State Highways, Hawaii District Office, Hilo Baseyard administrative and maintenance buildings.
2. The Contractor shall be responsible for properly sizing each window identified for replacement.

LEGEND

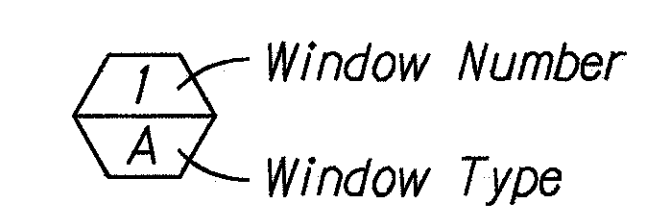

FLOOR PLAN BLDG'S. A-1, A-2, & A-3
 Scale: 1/8" = 1'-0"

ORIGINAL PLAN	SURVEY PLOTTED BY	DATE
NOTE BOOK	DRAWN BY	
3/10/96	CHECKED BY	
No. 101		

STATE OF HAWAII
DEPARTMENT OF TRANSPORTATION
HIGHWAYS DIVISION

FLOOR PLANS
HILO BASEYARD RENOVATIONS
PROJECT NO. HWY-H-05-96M
Scale: As Shown Date: March, 1996

SHEET No. 1 OF 1 SHEETS